



Western Michigan University
ScholarWorks at WMU

Legacy Scout Tickets from Pure Oil Company

8-20-2021

**MGRRE_PureOilScoutTickets_Wing, R E &
Mary_1_21113099650000**

MGRRE

Western Michigan University

Follow this and additional works at: <https://scholarworks.wmich.edu/pure>



Part of the Geology Commons

WMU ScholarWorks Citation

MGRRE, "MGRRE_PureOilScoutTickets_Wing, R E & Mary_1_21113099650000" (2021). *Legacy Scout Tickets from Pure Oil Company*. 5926.

<https://scholarworks.wmich.edu/pure/5926>

This Document is brought to you for free and open access via ScholarWorks at WMU. It has been accepted for inclusion in Legacy Scout Tickets from Pure Oil Company by an authorized administrator of ScholarWorks at WMU. See the National Digital Catalogue - Science Base Catalogue for more collections submitted by MGRRE.



MGRRE_PureOilScoutTickets_Wing, R E & Mary_1_21113099650000

API 21113099650000

Permit Number 9965

Lease Name Wing, R E & Mary

Well Number 1

County Missaukee

Township 22N

Range 06W

Section 26

2021 DEQ or Pure co_name Lease Management, Incorporated

Pure Number 119

Latitude 44.26493

Longitude -85.00095

THE PURE OIL COMPANY
LOCATION REPORT

Date February 3, 1943 A.F.E. No. _____
 Division Michigan Producing District _____ Lease R. E. and Mary Wing
 Acres _____ Lease No. _____ Elevation _____ Well No. 1 (Serial No. 119)
 Quadrangle C S 1/2 SW SE Sec. 26 Twp. 22 N Rge. 6 W Twp. Aetna
 Survey _____ County Missaukee State Michigan
 Operator Gordon Oil Co et al Map Aetna Twp. Missaukee Co.
Gordon Oil Company, et al Aetna Township, Missaukee County

| Feet from North Line of Lease | | | |
|---------------------------------|------------|-----|--------------------|
| <u>660</u> | <u>660</u> | " " | East " " " |
| <u>330</u> | <u>330</u> | " " | South " " " |
| <u>660</u> | <u>660</u> | " " | West " " " |
| Feet from North Line of Section | | | |
| | | " " | East " " " |
| <u>330</u> | <u>330</u> | " " | South " <u>1/4</u> |
| <u>660</u> | <u>660</u> | " " | West " " " |

LEGEND

- Location
- ☉ Gas Well
- Oil Well
- ☼ Gas-Distillate Well
- ∅ or ○ Dry Hole
- Dry Showing Oil
- ☉ Dry Showing Gas
- ⊖ Abandoned Location
- ☼ or ☼ Abandoned Gas Well
- or ● Abandoned Oil Well
- or ○ Input Well

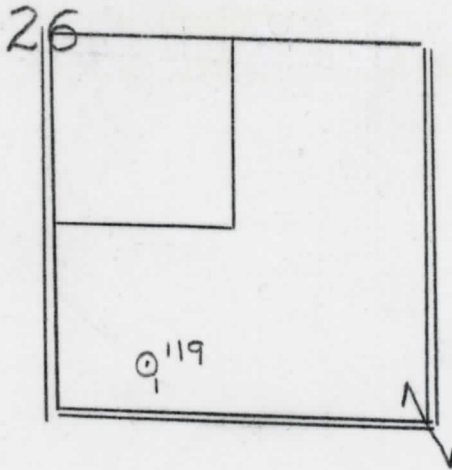

Scale _____

Remarks: _____

Submitted by _____ Civil Engineer
 Approved by _____ Division Manager
 Approved by _____ Vice-President-General Manager

Date

March 17, 1943

LOCATION BELOW

V.E.E. NO.

THE STATE OF MICHIGAN

COMPLETION RECORD OF WELLS DRILLED BY OTHER OPERATORS

Michigan Producing Division

TCD

Date March 17, 1943 No. 119
 State Mich. County Missaukee Dist. Aetna Sec. 26 Twp. 22 N Rge. 6 W
 (Serial No.)
 Well No. 1 (County No.) 119 Farm R. E. Wing Acres _____
 Operator Gordon Oil Company, et al Information secured from Scouting Department By _____
 Date well started 2-1-43 Date well completed 3-11-43 Elevation 1181.7

PRODUCTION RECORD

1st 24 hours natural 508 Barrels
 2nd 24 hours natural _____
 Date of shot _____ No. of quarts _____ From _____ to _____ From _____ to _____
 Date of acid _____ No. of gallons _____
 shot
 1st 24 hours after acid _____
 shot
 2nd 24 hours after acid _____

FORMATION AND CASING RECORD

| Formation | Top | Bottom | Top Pay | Bottom Pay | Remarks | Casing | |
|---------------|------|--------|---------|------------|---------|---------|--------|
| | | | | | | Size | Set at |
| Stray | 1253 | Log | | | | 10" | 641 |
| Marshall | 1398 | 1525 | | | | 5-3/16" | 3811 |
| Traverse Lime | 3148 | Log | | | | | |
| Dundee | 3816 | S.L.M. | 3816 | 3823 | | | |
| Total Depth | | 3824 | | | | | |
| | | | | | | | |
| | | | | | | | |
| | | | | | | | |
| | | | | | | | |
| | | | | | | | |
| | | | | | | | |
| | | | | | | | |
| | | | | | | | |

Remarks _____

Signed D. C. Shackelford