



Western Michigan University
ScholarWorks at WMU

Legacy Scout Tickets from Pure Oil Company

8-20-2021

**MGRRE_PureOilScoutTickets_Westveer, John
F_1_21113100360000**

MGRRE
Western Michigan University

Follow this and additional works at: <https://scholarworks.wmich.edu/pure>



Part of the Geology Commons

WMU ScholarWorks Citation

MGRRE, "MGRRE_PureOilScoutTickets_Westveer, John F_1_21113100360000" (2021). *Legacy Scout Tickets from Pure Oil Company*. 5929.
<https://scholarworks.wmich.edu/pure/5929>

This Document is brought to you for free and open access via ScholarWorks at WMU. It has been accepted for inclusion in Legacy Scout Tickets from Pure Oil Company by an authorized administrator of ScholarWorks at WMU. See the National Digital Catalogue - Science Base Catalogue for more collections submitted by MGRRE.



MGRRE_PureOilScoutTickets_Westveer, John F_1_21113100360000

API 21113100360000

Permit Number 10036

Lease Name Westveer, John F

Well Number 1

County Missaukee

Township 22N

Range 06W

Section 26

2021 DEQ or Pure co_name Lease Management, Incorporated

Pure Number 124

Latitude 44.26855

Longitude -85.00098

THE PURE OIL COMPANY
LOCATION REPORT

Date March 31, 1943 A.F.E. No. _____
 Division Mich. Producing District _____ Lease John F. Westveer
John F. Westveer
 Acres _____ Lease No. _____ Elevation _____ Well No. 1 (Serial No. 124)
 Quadrangle C S 1/2 NW SE Sec. 26 Twp. 22 N Rge. 6 W ~~22 N~~ ~~6 W~~ Aetna
C S 1/2 NW SE Sec. 26 Twp. 22 N Rge. 6 W Twp. Aetna
 Survey _____ County Missaukee State Michigan
 Operator Gordon Oil Co. Map Aetna Twp. - Missaukee Co.
Gordon Oil Company Aetna Township, Missaukee County

		Feet from North Line of Lease
		" " East " " "
<u>330</u>	<u>330</u>	" " South " " "
<u>660</u>	<u>660</u>	" " West " " "
<u>990</u>	<u>990</u>	Feet from North Line of Section
		" " East " " "
		" " South " " "
<u>660</u>	<u>660</u>	" " West " " "

mu

- LEGEND
- Location
 - ☉ Gas Well
 - Oil Well
 - ☼ Gas - Distillate Well
 - or ○ Dry Hole
 - or ● Dry Showing Oil
 - ☉ Dry Showing Gas
 - Abandoned Location
 - ☼ or ☼ Abandoned Gas Well
 - or ● Abandoned Oil Well
 - or ○ Input Well

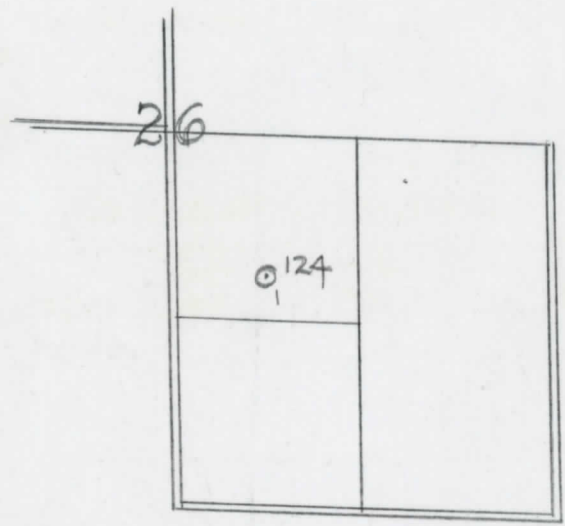

Remarks: _____

Scale _____

Submitted by RN Civil Engineer Approved by _____ Division Manager
 Approved by _____ Vice-President - General Manager

COMPLETION RECORD OF WELLS DRILLED BY OTHER OPERATORS

Michigan Producing Division

TED

Date May 5, 1943 No. 124
 State Mich. County Missaukee ~~St. Clair~~ Twp. Aetna Sec. 26 Twp. 22 N Rge. 6 W
 Well No. 1 (Serial No.) 124 Farm John F. Westveer Acres _____
 Operator Gordon Oil Company Information secured ~~from~~ Scouting Department By _____
 Date well started 3-31-43 Date well completed 4-21-43 Elevation 1180.0

PRODUCTION RECORD

21
 1st ~~24~~ hours natural 305 Barrels
 2nd 24 hours natural _____
 Date of shot _____ No. of quarts _____ From _____ to _____ From _____ to _____
 Date of acid 4-27-43 No. of gallons 500
21
 1st ~~24~~ hours after acid 734 Barrels
 shot
 2nd 24 hours after acid _____

FORMATION AND CASING RECORD

Formation	Top	Bottom	Top Pay	Bottom Pay	Remarks	Casing	
						Size	Set at
Brown Dolomite	1083	Schlum.				10"	670
Stray	1244	"				5-3/16"	3823
Marshall	1321						
Antrim	2870						
Traverse Lime	3150	Schlum.					
Dundee	3823	S.L.M.	3823	3826			
			3826	3830			
Total Depth		3830					

Remarks 3027' CTM equals 3035' SLM; 3804' DSM equals 3810' SLM.

Signed D. C. Shackelford