



Western Michigan University  
ScholarWorks at WMU

---

Legacy Scout Tickets from Pure Oil Company

---

8-20-2021

## MGRRE\_PureOilScoutTickets\_State of Michigan Aetna\_A-1\_21113101430000

MGRRE

*Western Michigan University*

Follow this and additional works at: <https://scholarworks.wmich.edu/pure>



Part of the Geology Commons

---

### WMU ScholarWorks Citation

MGRRE, "MGRRE\_PureOilScoutTickets\_State of Michigan Aetna\_A-1\_21113101430000" (2021). *Legacy Scout Tickets from Pure Oil Company*. 5939.  
<https://scholarworks.wmich.edu/pure/5939>

This Document is brought to you for free and open access via ScholarWorks at WMU. It has been accepted for inclusion in Legacy Scout Tickets from Pure Oil Company by an authorized administrator of ScholarWorks at WMU. See the National Digital Catalogue - Science Base Catalogue for more collections submitted by MGRRE.



---

**MGRRE\_PureOilScoutTickets\_State of Michigan Aetna\_A-1\_21113101430000**

API 21113101430000

Permit Number 10143

Lease Name State of Michigan Aetna

Well Number A-1

County Missaukee

Township 22N

Range 06W

Section 26

2021 DEQ or Pure co\_name Freeman Oil Company

Pure Number 134

Latitude 44.27577

Longitude -85.00608

# THE PURE OIL COMPANY LOCATION REPORT

Date June 9, 1943 A.F.E. No. \_\_\_\_\_  
 Division Mich. Producing District \_\_\_\_\_ Lease State-Aetna  
 Acres \_\_\_\_\_ Lease No. \_\_\_\_\_ Elevation \_\_\_\_\_ Well No. A-1 (Serial No. 134)  
 Quadrangle C 5 1/2 NE - NW Sec. 26 Twp. 22 N Rge. 6 W Twp. Aetna  
 Survey \_\_\_\_\_ County Missaukee State Michigan  
 Operator Freeman Oil Co Map Aetna Twp. Missaukee Co  
Freeman Oil Company

Feet from North Line of Lease  
660 660 " " East " " "  
330 330 " " South " " "  
 " " West " " "  
 Feet from North Line of Section  
990 990 " " East " " "  
660 660 " " South " " "  
 " " West " " "

*200*

- LEGEND**
- Location
  - ☀ Gas Well
  - Oil Well
  - ☀ Gas - Distillate Well
  - or ○ Dry Hole
  - Dry Showing Oil
  - ☀ Dry Showing Gas
  - ⊗ Abandoned Location
  - ☀ or ☀ Abandoned Gas Well
  - or ● Abandoned Oil Well
  - or ○ Input Well

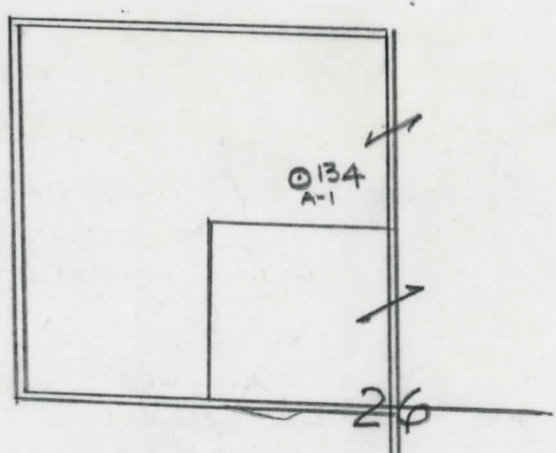

Remarks: \_\_\_\_\_  
 \_\_\_\_\_  
 \_\_\_\_\_

Scale \_\_\_\_\_

Submitted by RN Civil Engineer Approved by \_\_\_\_\_ Division Manager  
 Approved by \_\_\_\_\_ Vice-President - General Manager

COMPLETION RECORD OF WELLS DRILLED BY OTHER OPERATORS

Michigan Producing Division

134

Date August 25, 1943 No. 134  
 State Mich. County Missaukee Dist. Aetna Sec. 26 Twp. 22 N Rge. 6 W  
 Well No. 1 (Serial No.) 134 Farm State-Aetna Acres  
 Operator Freeman Oil Company Information secured from Scouting Department  
 Date well started 6-19-43 Date well completed 8-23-43 Elevation 1196.7

PRODUCTION RECORD

1st 24 hours natural Dry Hole  
 2nd 24 hours natural  
 Date of shot No. of quarts From to From to  
 Date of acid No. of gallons shot  
 1st 24 hours after acid shot  
 2nd 24 hours after acid shot

FORMATION AND CASING RECORD

Formation	Top	Bottom	Top Pay	Bottom Pay	Remarks	Casing	
						Size	Set at
Brown Dolomite	1090					10"	601
Mich. Stray	1252 ?				H.F.W. 1280.	8-1/4"	958
Marshall	1402					6-5/8"	1557
Red Rock	1414	1546				5-3/16"	3858
Antrim	2438						
Traverse Lime	3186				Odor oil 3194.		
Dundee	3872				H.F.S.W. 3877-3879.		
Total Depth		3879					

Remarks 3050' CTM equals 3065' SOM; 3856' CTM equals 3858' SLM.

Signed D. C. Shackelford