



Western Michigan University
ScholarWorks at WMU

Legacy Scout Tickets from Pure Oil Company

8-20-2021

MGRRE_PureOilScoutTickets_Ann Arbor Schools_S-22_21113102650000

MGRRE

Western Michigan University

Follow this and additional works at: <https://scholarworks.wmich.edu/pure>



Part of the Geology Commons

WMU ScholarWorks Citation

MGRRE, "MGRRE_PureOilScoutTickets_Ann Arbor Schools_S-22_21113102650000" (2021). *Legacy Scout Tickets from Pure Oil Company*. 5944.

<https://scholarworks.wmich.edu/pure/5944>

This Document is brought to you for free and open access via ScholarWorks at WMU. It has been accepted for inclusion in Legacy Scout Tickets from Pure Oil Company by an authorized administrator of ScholarWorks at WMU. See the National Digital Catalogue - Science Base Catalogue for more collections submitted by MGRRE.



MGRRE_PureOilScoutTickets_Ann Arbor Schools_S-22_21113102650000

API 21113102650000

Permit Number 10265

Lease Name Ann Arbor Schools

Well Number S-22

County Missaukee

Township 21N

Range 06W

Section 36

2021 DEQ or Pure co_name Taggart Brothers Gas Company

Pure Number 139

Latitude 44.16621

Longitude -84.97731

THE PURE OIL COMPANY LOCATION REPORT

Date August 4, 1943 A.F.E. No. _____
 Division Michigan Producing District _____ Lease Ann Arbor Schools
 Acres _____ Lease No. _____ Elevation _____ Well No. S-22 (Serial No. 139)
 Quadrangle C SE Sec. 36 Twp. 21 N Rge. 6 W Clam Union
 Survey _____ County Missaukee State Michigan
 Operator Taggart Brothers Company Map Clam Union Twp - Missaukee Co

Operator Taggart Brothers Company
1320 1320 Feet from North Line of Lease
1320 1320 " " East " " "
 " " South " " "
 " " West " " "
 Feet from North Line of Section
1320 1320 " " East " " "
1320 1320 " " South 1/4 " "
 " " West " " "

LEGEND

- ☀ Gas Well
- Oil Well
- ☀ or ☀ Gas - Distillate Well
- or ○ Dry Hole
- or ● Dry Showing Oil
- Location
- ☀ Dry Showing Gas
- ⊗ Abandoned Location
- ☀ or ☀ Abandoned Gas Well
- or ● Abandoned Oil Well
- or ○ Input Well

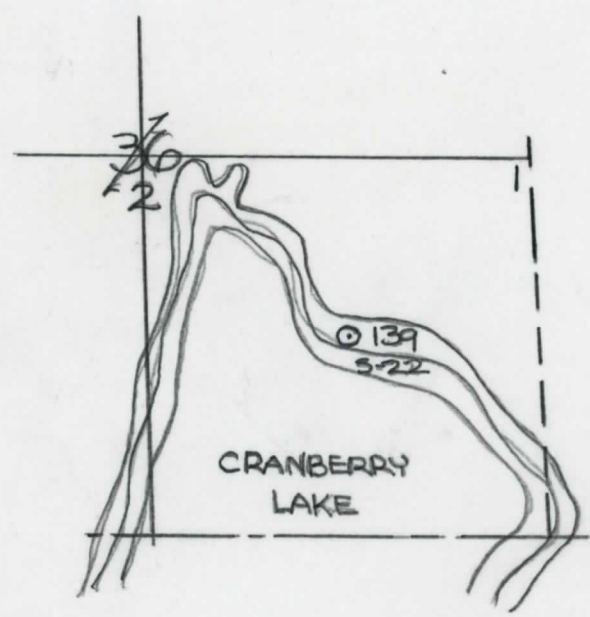

Scale _____

Remarks: _____

Submitted by RN Civil Engineer Approved by _____ Division Manager
 Approved by _____ Vice-President - General Manager

