



Western Michigan University
ScholarWorks at WMU

Legacy Scout Tickets from Pure Oil Company

8-20-2021

MGRRE_PureOilScoutTickets_Dekraker, William and Anna_1_21113105950000

MGRRE

Western Michigan University

Follow this and additional works at: <https://scholarworks.wmich.edu/pure>



Part of the Geology Commons

WMU ScholarWorks Citation

MGRRE, "MGRRE_PureOilScoutTickets_Dekraker, William and Anna_1_21113105950000" (2021). *Legacy Scout Tickets from Pure Oil Company*. 5949.

<https://scholarworks.wmich.edu/pure/5949>

This Document is brought to you for free and open access via ScholarWorks at WMU. It has been accepted for inclusion in Legacy Scout Tickets from Pure Oil Company by an authorized administrator of ScholarWorks at WMU. See the National Digital Catalogue - Science Base Catalogue for more collections submitted by MGRRE.



MGRRE_PureOilScoutTickets_Dekraker, William and Anna_1_21113105950000

API 21113105950000

Permit Number 10595

Lease Name Dekraker, William and Anna

Well Number 1

County Missaukee

Township 21N

Range 06W

Section 34

2021 DEQ or Pure co_name Gordon Oil and Rowmor Corporation

Pure Number 144

Latitude 44.16489

Longitude -85.03107

THE PURE OIL COMPANY

LOCATION REPORT

Date January 19, 1944

A.F.E. No. _____

Division Mich. Producing District _____

Lease William & Anna DeKraker Wm. and Anna DeKraker

Acres _____ Lease No. _____ Elevation _____ Well No. 1 (Serial No. 144)

Quadrangle Approx. C W 1/2 SW SW Sec. 34 Twp. 21 N Rge. 6 W Twp. Clam Union

Survey _____ County Missaukee State Michigan

Operator Gordon Oil Co & Rowmar Corp Map Clam Union Township, Missaukee County

_____	_____	Feet from North Line of Lease
_____	_____	" " East " " "
<u>535</u>	<u>535</u>	" " South " " "
<u>330</u>	<u>330</u>	" " West " " "
_____	_____	Feet from North Line of Section
_____	_____	" " East " " "
<u>535</u>	<u>535</u>	" " South " <u>1/4</u> "
<u>330</u>	<u>330</u>	" " West " " "

LEGEND

- Location
- ☀ Gas Well
- Oil Well
- ☀ Gas - Distillate Well
- ∅ or ○ Dry Hole
- Dry Showing Oil
- ☀ Dry Showing Gas
- ⊖ Abandoned Location
- ☀ or ☀ Abandoned Gas Well
- or ● Abandoned Oil Well
- or ○ Input Well

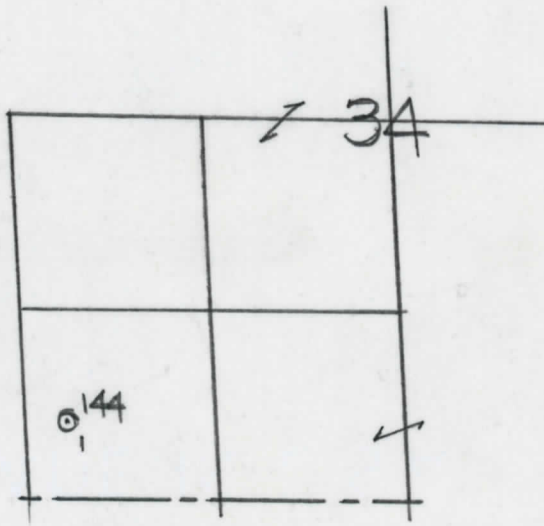

Remarks: _____ Scale _____

Submitted by RN Civil Engineer Approved by _____ Division Manager

Approved by _____ Vice-President - General Manager

Michigan Producing Division

Date April 5, 1944 No. 144
 State Mich. County Missaukee Dist. _____
 Twp. Clam Union Sec. 34 Twp. 21 N Rge. 6 W
 Well No. 1 (Serial No.) _____ Farm Wm. & Anna DeKraker Acres _____
 Operator Gordon Oil Co. & Rowmer Corp. Information secured From Scouting Department
 Date well started 1-24-44 Date well completed 3-29-44 Elevation 1103.4

PRODUCTION BOARD

1st 24 hours natural Dry Hole
 2nd 24 hours natural _____
 Date of shot _____ No. of quarts _____ From _____ to _____ From _____ to _____
 Date of acid _____ No. of gallons _____
 1st 24 hours after acid shot _____
 2nd 24 hours after acid shot _____

FORMATION AND CASING RECORD

Formation	Top	Bottom	Top Pay	Bottom Pay	Remarks	Casing	
						Size	Set at
Brown Dolomite	1183	SLM.				10"	170
Mich. Stray	1327					6-5/8"	1657
Red Rock	?	1540				5-3/16"	3820
Antrim	2465						
Traverse Lime	3158	CTM.			See remarks below.		
Dundee Dol.	3843				Salt water (700 ft.) 3849-3857; 2600 ft. from 3857-3863.		
Total Depth		3863					

Remarks 1000 ft. salt water per hr. from 3197-3202 - small show oil 3177 - cored from 1335-1350 rec. 14 ft.
1200' equals 1196' SLM.

Signed D. C. Shackelford

*124-972
Big Basin*