



Legacy Scout Tickets from Pure Oil Company

8-20-2021

MGRRE_PureOilScoutTickets_Fahrney, Wm H Est_5_21113109750000

MGRRE

Western Michigan University

Follow this and additional works at: <https://scholarworks.wmich.edu/pure>



Part of the Geology Commons

WMU ScholarWorks Citation

MGRRE, "MGRRE_PureOilScoutTickets_Fahrney, Wm H Est_5_21113109750000" (2021). *Legacy Scout Tickets from Pure Oil Company*. 5964.

<https://scholarworks.wmich.edu/pure/5964>

This Document is brought to you for free and open access via ScholarWorks at WMU. It has been accepted for inclusion in Legacy Scout Tickets from Pure Oil Company by an authorized administrator of ScholarWorks at WMU. See the National Digital Catalogue - Science Base Catalogue for more collections submitted by MGRRE.



MGRRE_PureOilScoutTickets_Fahrney, Wm H Est_5_21113109750000

API 21113109750000

Permit Number 10975

Lease Name Fahrney, Wm H Est

Well Number 5

County Missaukee

Township 24N

Range 05W

Section 1

2021 DEQ or Pure co_name Merit Energy Company

Pure Number 162

Latitude 44.4956819

Longitude -84.8593751

THE PURE OIL COMPANY
LOCATION REPORT

Date August 16, 1944

A.F.E. No. Wm. H. Fahrney Est
Wm. H. Fahrney Estate

Division Mich. Producing District _____ Lease _____

Acres _____ Lease No. _____ Elevation _____ Well No. 5 (Serial No. 162)

Quadrangle C S₂ SW SE Sec. 1 Twp. 24 N Rge. 5 W Twp. Norwich

Survey _____ County Missaukee State Michigan

Operator Sun Oil Co Map Norwich Twp. Missaukee Co
Sun Oil Company Norwich Township, Missaukee County

| | | |
|-------------|-------------|---------------------------------|
| | | Feet from North Line of Lease |
| <u>1980</u> | <u>1980</u> | " " East " " " |
| <u>2970</u> | <u>2970</u> | " " South " " " |
| | | " " West " " " |
| | | Feet from North Line of Section |
| <u>330</u> | <u>330</u> | " " East " " " |
| <u>660</u> | <u>660</u> | " " South " " <u>1/4</u> |
| | | " " West " " " |

LEGEND

- Gas Well
- Oil Well
- Gas - Distillate Well
- Dry Hole
- Dry Showing Oil
- Dry Showing Gas
- Abandoned Location
- or Abandoned Gas Well
- or Abandoned Oil Well
- or Input Well

Handwritten notes:
44
lp 8-12-44
13" 39

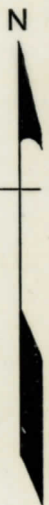
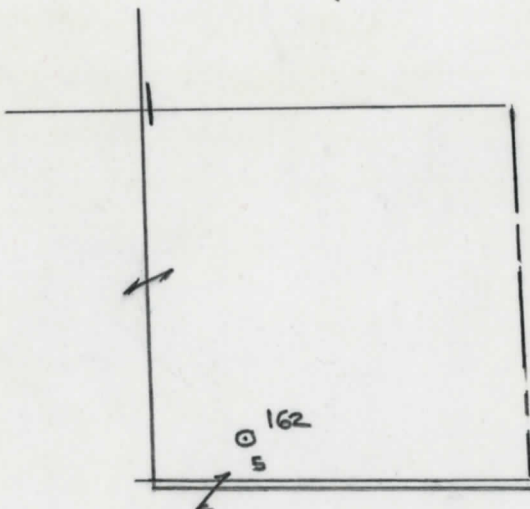

Scale _____

Remarks: _____

Submitted by RN Civil Engineer Approved by _____ Division Manager

Approved by _____ Vice-President - General Manager

Division Michigan Producing
 Date November 15, 1944

LOCATION BELOW
 THE PURE OIL COMPANY

W.E.E. NO. 1711 H
10-11-44 EST

COMPLETION RECORD OF WELLS DRILLED BY OTHER OPERATORS

Michigan Producing Division

Date November 15, 1944 No. 162
 State Mich. County Missaukee Twp. Norwich Sec. 1 Twp. 24 N Rge. 5 W
 Well No. 5 (Serial No.) 162 Farm Wm. H. Fahrney Est. Acres
 Operator Sun Oil Company Information secured from Scouting Department
 Date well started 8-12-44 Date well completed 10-31-44 Elevation 1235.8

PRODUCTION BOARD

1st 24 hours natural None
 2nd 24 hours natural
 Date of shot No. of quarts From To From to
 Date of acid 11-11-44 No. of gallons 4000
 1st 24 hours after acid 150 Barrels (Flowed)
 shot
 2nd 24 hours after acid

FORMATION AND CASING RECORD

| Formation | Top | Bottom | Top Pay | Bottom Pay | Remarks | Casing | |
|---------------|------|--------|--------------|--------------|----------------------|---------|--------|
| | | | | | | Size | Set at |
| Marshall | 627 | (+609) | | | H.F.S.W. 634. (+602) | 13-3/8" | 39 |
| Traverse Lime | 2421 | SIM. | (-1185) | | | 5-3/16" | 4357 |
| Dundee | 3113 | " | (-1877) | | | | |
| Cored: | 4427 | 4445 | | | | | |
| | 4462 | 4480 | | | | | |
| | 4480 | 4498 | | | | | |
| | 4498 | 4516 | | | | | |
| Total Depth | | 4516 | 4503 (-3280) | 4504 (-3267) | | | |

Remarks 2429' equals 2417' SIM; 4518' equals 4518' SIM.

Signed D. C. Shackelford