



Western Michigan University
ScholarWorks at WMU

Legacy Scout Tickets from Pure Oil Company

8-20-2021

MGRRE_PureOilScoutTickets_Hamming, H_126_21113111360000

MGRRE

Western Michigan University

Follow this and additional works at: <https://scholarworks.wmich.edu/pure>



Part of the Geology Commons

WMU ScholarWorks Citation

MGRRE, "MGRRE_PureOilScoutTickets_Hamming, H_126_21113111360000" (2021). *Legacy Scout Tickets from Pure Oil Company*. 5967.

<https://scholarworks.wmich.edu/pure/5967>

This Document is brought to you for free and open access via ScholarWorks at WMU. It has been accepted for inclusion in Legacy Scout Tickets from Pure Oil Company by an authorized administrator of ScholarWorks at WMU. See the National Digital Catalogue - Science Base Catalogue for more collections submitted by MGRRE.



MGRRE_PureOilScoutTickets_Hamming, H_126_21113111360000

API 21113111360000

Permit Number 11136

Lease Name Hamming, H

Well Number 126

County Missaukee

Township 21N

Range 07W

Section 18

2021 DEQ or Pure co_name Taggart Brothers Gas Company

Pure Number 166

Latitude 44.21183

Longitude -85.19927

THE PURE OIL COMPANY

LOCATION REPORT

Date October 18, 1944

A.F.E. No. _____

Division Michigan Producing District _____

Lease H. Hamming
H. Hamming

Acres _____ Lease No. _____ Elevation _____ Well No. 126 (Serial No. 166)

Quadrangle CSE C SE Sec. 18 Twp. 21 N Rge. 7 W 7 W Dist. Riverside Twp. Riverside

Survey _____ County Missaukee State Michigan

Operator Taggart Bros Co Taggart Bros. Co. Map Riverside twp - Missaukee Co
Riverside Township, Missaukee County

1320 1320 Feet from North Line of Lease

1320 1320 " " East " " "

" " South " " "

" " West " " "

Feet from North Line of Section

1320 1320 " " East " " "

1320 1320 " " South " " "

" " West " " "

LEGEND

- Gas Well
- Oil Well
- Gas - Distillate Well
- Dry Hole
- Dry Showing Oil
- Location
- Dry Showing Gas
- Abandoned Location
- Abandoned Gas Well
- Abandoned Oil Well
- Input Well

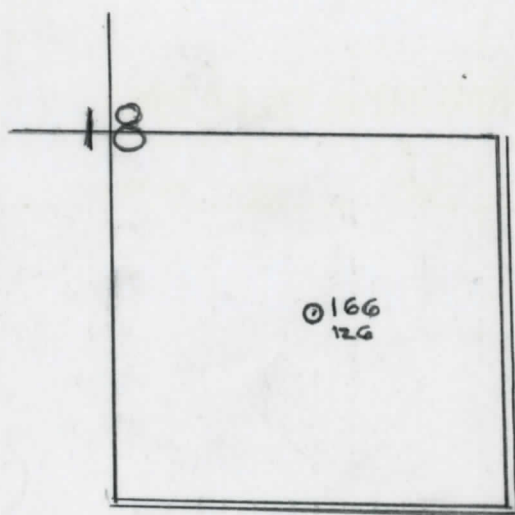

Remarks: _____ Scale _____

Submitted by RN _____ Civil Engineer Approved by _____ Division Manager

Approved by _____ Vice-President - General Manager

Michigan Producing Division

Date October 25, 1944 No. 166
 State Mich. County Missaukee ~~Dist.~~ Twp. Riverside Sec. 18 Twp. 21 N Rge. 7 W
 Well No. 126 (County No.) 166 Farm H. Hamming Acres _____
 Operator Taggart Bros. Co. Information secured ~~from~~ By Scouting Department
 Date well started 10-15-44 Date well completed 10-21-44 Elevation 1246.9

PRODUCTION BOARD

1st 24 hours natural Dry Hole
 2nd 24 hours natural _____
 Date of shot _____ No. of quarts _____ From _____ to _____ From _____ to _____
 Date of acid _____ No. of gallons _____
 1st 24 hours after acid shot _____
 2nd 24 hours after acid shot _____

FORMATION AND CASING RECORD

Formation	Top	Bottom	Top Pay	Bottom Pay	Remarks	Casing	
						Size	Set at
<u>Brown Dolomite</u>	<u>1330'</u>	<u>(-83)</u>				<u>8-5/8"</u>	<u>244'</u>
<u>Mich. Stray</u>	<u>1460'</u>	<u>(-213)</u>			<u>Show of gas 1460' (-213)</u> <u>Salt water 1475' (-228)</u>	<u>5-3/16"</u>	<u>1455'</u>
<u>Total Depth</u>		<u>1477'</u>	<u>(-230)</u>				

Remarks _____

Signed Dean C. Shackelford