



Western Michigan University  
ScholarWorks at WMU

---

Legacy Scout Tickets from Pure Oil Company

---

8-20-2021

## MGRRE\_PureOilScoutTickets\_Boersma & Talbot et al\_RM-127\_21113111490000

MGRRE

*Western Michigan University*

Follow this and additional works at: <https://scholarworks.wmich.edu/pure>



Part of the Geology Commons

---

### WMU ScholarWorks Citation

MGRRE, "MGRRE\_PureOilScoutTickets\_Boersma & Talbot et al\_RM-127\_21113111490000" (2021).

*Legacy Scout Tickets from Pure Oil Company*. 5968.

<https://scholarworks.wmich.edu/pure/5968>

This Document is brought to you for free and open access via ScholarWorks at WMU. It has been accepted for inclusion in Legacy Scout Tickets from Pure Oil Company by an authorized administrator of ScholarWorks at WMU. See the National Digital Catalogue - Science Base Catalogue for more collections submitted by MGRRE.



---

**MGRRE\_PureOilScoutTickets\_Boersma & Talbot et al\_RM-127\_21113111490000**

API 21113111490000

Permit Number 11149

Lease Name Boersma & Talbot et al

Well Number RM-127

County Missaukee

Township 21N

Range 07W

Section 17

2021 DEQ or Pure co\_name Taggart Brothers Gas Company

Pure Number 167

Latitude 44.21181

Longitude -85.18921

THE PURE OIL COMPANY

LOCATION REPORT

Date October 25, 1944

A.F.E. No. \_\_\_\_\_

Division Michigan Producing District \_\_\_\_\_

Lease Boersma-Talbot et al RM  
Boersma-Talbot et al RM

Acres \_\_\_\_\_ Lease No. \_\_\_\_\_ Elevation \_\_\_\_\_ Well No. 127 (Serial No. 167)

Quadrangle C SW Sec. 17 Twp. 21 N Rge. 7 W ~~EDC~~ Riverside ~~Dist.~~ Riverside

Survey \_\_\_\_\_ County Missaukee State Michigan

Operator Taggart Bros Co Map Riverside Twp - Missaukee Co  
Taggart Bros. Co. Riverside Township, Missaukee County

		Feet from North Line of Lease			
<u>1320</u>	<u>1320</u>	"	"	East	" " "
<u>1320</u>	<u>1320</u>	"	"	South	" " "
		"	"	West	" " "
		Feet from North Line of Section			
<u>1320</u>	<u>1320</u>	"	"	East	" " "
<u>1320</u>	<u>1320</u>	"	"	South	" " "
		"	"	West	" " "

LEGEND

- Location
- ☀ Gas Well
- Oil Well
- ☀ Gas - Distillate Well
- ⊘ or ○ Dry Hole
- Dry Showing Oil
- ☀ Dry Showing Gas
- ⊘ Abandoned Location
- ☀ or ☀ Abandoned Gas Well
- or ● Abandoned Oil Well
- or ○ Input Well

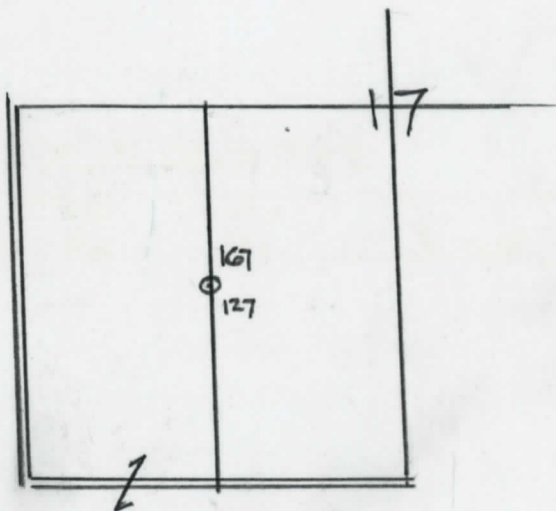

Scale \_\_\_\_\_

Remarks: \_\_\_\_\_  
\_\_\_\_\_  
\_\_\_\_\_

Submitted by RN Civil Engineer Approved by \_\_\_\_\_ Division Manager

Approved by \_\_\_\_\_ Vice-President - General Manager

Michigan Producing Division

Date October 25, 1944 No. 167
State Mich. County Missaukee Dist. Riverside Twp. Riverside Sec. 17 Twp. 21 N Rge. 7 W
Well No. 127 (Serial No.) 167 Farm Boersma-Talbot, et al Acres
Operator Taggart Bros. Co. Information secured from Scouting Department
Date well started 10-19-44 Date well completed 10-23-44 Elevation 1048.0

PRODUCTION BOARD

1st 24 hours natural Dry Hole
2nd 24 hours natural
Date of shot No. of quarts From to From to
Date of acid No. of gallons
1st 24 hours after acid shot
2nd 24 hours after acid shot

FORMATION AND CASING RECORD

Table with 7 columns: Formation, Top, Bottom, Top Pay, Bottom Pay, Remarks, Casing (Size, Set at). Rows include Brown Dolomite (1332' top, 84' bottom, 8-5/8" casing) and Total Depth (1450' bottom, 202' top, 5-3/16" casing).

Remarks

Signed Dean C. Shackelford