



---

Legacy Scout Tickets from Pure Oil Company

---

8-20-2021

## MGRRE\_PureOilScoutTickets\_Fahrney, Wm H Estate\_7\_21113112760000

MGRRE

*Western Michigan University*

Follow this and additional works at: <https://scholarworks.wmich.edu/pure>



Part of the Geology Commons

---

### WMU ScholarWorks Citation

MGRRE, "MGRRE\_PureOilScoutTickets\_Fahrney, Wm H Estate\_7\_21113112760000" (2021). *Legacy Scout Tickets from Pure Oil Company*. 5973.

<https://scholarworks.wmich.edu/pure/5973>

This Document is brought to you for free and open access via ScholarWorks at WMU. It has been accepted for inclusion in Legacy Scout Tickets from Pure Oil Company by an authorized administrator of ScholarWorks at WMU. See the National Digital Catalogue - Science Base Catalogue for more collections submitted by MGRRE.



---

**MGRRE\_PureOilScoutTickets\_Fahrney, Wm H Estate\_7\_21113112760000**

API 21113112760000

Permit Number 11276

Lease Name Fahrney, Wm H Estate

Well Number 7

County Missaukee

Township 24N

Range 05W

Section 1

2021 DEQ or Pure co\_name Merit Energy Company

Pure Number 172

Latitude 44.4992723

Longitude -84.8640676

# THE PURE OIL COMPANY LOCATION REPORT

Date December 13, 1944

A.F.E. No. \_\_\_\_\_

Division Mich. Producing District \_\_\_\_\_

Lease Wm. H. Fahrney Est.  
Wm. H. Fahrney Est.

Acres \_\_\_\_\_ Lease No. \_\_\_\_\_ Elevation \_\_\_\_\_ Well No. 7 (Serial No. 172)

Quadrangle C S $\frac{1}{2}$  - NE SW Sec. 1 Twp. 24 N Rge. 5 W ~~Dist.~~ Norwich  
C S $\frac{1}{2}$  NE SW 24 N 5 W Norwich

Survey \_\_\_\_\_ County Missaukee State Michigan

Operator Sun Oil Co Sun Oil Company Map Norwich Twp - Missaukee Co  
Sun Oil Company Norwich Township, Missaukee County

Feet from North Line of Lease

1650	1650	"	"	East	"	"	"
1980	1980	"	"	South	"	"	"
990	990	"	"	West	"	"	"
660	660	"	"	East	"	"	"
		"	"	South	"	"	"
		"	"	West	"	"	"

Feet from North Line of Section 1/4

### LEGEND

- Location
- ☀ Gas Well
- Oil Well
- ☀ Gas - Distillate Well
- ∅ or ○ Dry Hole
- Dry Showing Oil
- ☀ Dry Showing Gas
- ⊖ Abandoned Location
- ☀ or ☀ Abandoned Gas Well
- or ● Abandoned Oil Well
- or ○ Input Well

*Low*

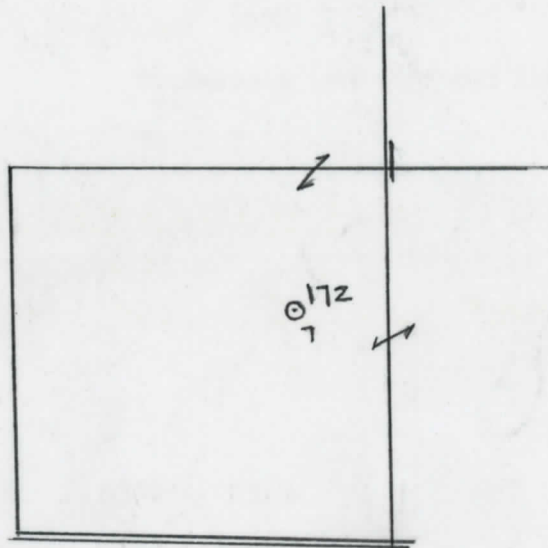

Remarks: \_\_\_\_\_ Scale \_\_\_\_\_

Submitted by RN \_\_\_\_\_ Approved by \_\_\_\_\_  
Civil Engineer \_\_\_\_\_ Division Manager \_\_\_\_\_

Approved by \_\_\_\_\_  
Vice-President - General Manager \_\_\_\_\_

The Pure Oil Company  
COMPLETION RECORD OF WELLS DRILLED BY OTHER OPERATORS

Michigan Producing Division

Date **March 15, 1945** No. **172**  
State **Mich.** County **Missaukee** ~~XXXX~~ Twp. **Norwich** Sec. **1** Twp. **24 N** Rge. **5 W**  
(Serial No.)  
Well No. **7** (~~XXXXXX~~) **172** Farm **Wm. H. Fahrney Est.** Acres  
Operator **Sun Oil Company** Information secured ~~XXXX~~ By **Scouting Department**  
Date well started **1-2-45** Date well completed **2-3-45** Elevation **1251.2**

PRODUCTION BOARD

1st 24 hours natural **22 Barrels (Swabbed)**  
2nd 24 hours natural  
Date of shot No. of quarts From to From to  
Date of acid **2-27-45** No. of gallons **4000**  
~~7~~ ~~XXXX~~ **56 Barrels (Swabbed and flowed.)**  
1st ~~24~~ **8** hours after acid ~~XXXX~~  
2nd ~~24~~ hours after acid **70** " " " "

FORMATION AND CASING RECORD

Formation	Top	Bottom	Top Pay	Bottom Pay	Remarks	Casing	
						Size	Set at
Marshall	655	(-596)				13-3/8"	52
Traverse Lime	2436	SLM.	(-1185)			8-5/8"	847
Dundee	3129	"	(-1878)			5-3/16"	4362
Detroit River	?		4350	4352	(-3099)		
			4373	4376	(-3122)		
			4388	4394	(-3137)		
			4524	4526	(-3273)		
Total Depth		4531	(-3280)				

Remarks **626' eq. 624' SLM; 2356' eq. 2356' SLM; 3054' eq. 3047' SLM; 4531' eq. 4532' SLM.**

Signed **D. C. Shackelford**