



Western Michigan University
ScholarWorks at WMU

Legacy Scout Tickets from Pure Oil Company

8-20-2021

**MGRRE_PureOilScoutTickets_Horner, Frank S
Tr_21_21113113290000**

MGRRE
Western Michigan University

Follow this and additional works at: <https://scholarworks.wmich.edu/pure>



Part of the Geology Commons

WMU ScholarWorks Citation

MGRRE, "MGRRE_PureOilScoutTickets_Horner, Frank S Tr_21_21113113290000" (2021). *Legacy Scout Tickets from Pure Oil Company*. 5976.
<https://scholarworks.wmich.edu/pure/5976>

This Document is brought to you for free and open access via ScholarWorks at WMU. It has been accepted for inclusion in Legacy Scout Tickets from Pure Oil Company by an authorized administrator of ScholarWorks at WMU. See the National Digital Catalogue - Science Base Catalogue for more collections submitted by MGRRE.



MGRRE_PureOilScoutTickets_Horner, Frank S Tr_21_21113113290000

API 21113113290000

Permit Number 11329

Lease Name Horner, Frank S Tr

Well Number 21

County Missaukee

Township 24N

Range 05W

Section 2

2021 DEQ or Pure co_name Merit Energy Company

Pure Number 175

Latitude 44.4956955

Longitude -84.8746009

THE PURE OIL COMPANY

LOCATION REPORT

Date January 17, 1945

A.F.E. No. _____

Division Mich. Producing District _____

Lease Frank S. Horner, Tr
Frank S. Horner, Tr.

Acres _____ Lease No. 2 Elevation 24N 5W Well No. 21 (Serial No. 175)

Quadrangle C S 1/2 SE SE Sec. 2 Twp. 24 N Rge. 5 W Twp. Norwich

Survey _____ County Missaukee State Michigan

Operator Sun Oil Co Map Norwich Twp - Missaukee Co

<u>2310</u>	<u>2310</u>	Feet from North Line of Lease
<u>660</u>	<u>660</u>	" " East " " "
		" " South " " "
		" " West " " "
<u>660</u>	<u>660</u>	Feet from North Line of Section
<u>330</u>	<u>330</u>	" " East <u>1/4</u> "
		" " South " " "
		" " West " " "

LEGEND

- Location
- ☀ Gas Well
- Oil Well
- ☀ Gas - Distillate Well
- ⊘ or ○ Dry Hole
- Dry Showing Oil
- ☀ Dry Showing Gas
- ⊘ Abandoned Location
- ☀ or ☀ Abandoned Gas Well
- or ● Abandoned Oil Well
- or ○ Input Well

Yoo

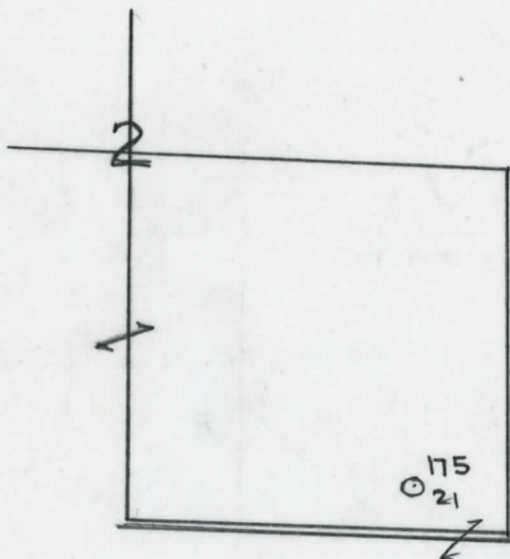

N

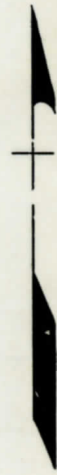

Scale _____

Remarks: _____

Submitted by RN _____ Approved by _____

Civil Engineer _____ Division Manager _____

Approved by _____

Vice-President - General Manager _____

COMPLETION RECORD OF WELLS DRILLED BY OTHER OPERATORS

Michigan Producing Division

Date March 28, 1945 No. 175
 State Mich. County Missaukee Twp. Norwich Sec. 2 Twp. 24 N Rge. 5 W
 Well No. 21 Farm Frank S. Horner, Tr. Acres
 Operator Sun Oil Company Information secured Scouting Department
 Date well started 1-30-45 Date well completed 3-1-45 Elevation 1356.2

PRODUCTION BOARD

1st 24 hours natural No report.
 2nd 24 hours natural
 Date of shot No. of quarts From To From to
 Date of acid 3-15-45 No. of gallons 6000
 1st 24 hours after acid 125 Barrels (Flowed)
 2nd 24 hours after acid

FORMATION AND CASING RECORD

Formation	Top	Bottom	Top Pay	Bottom Pay	Remarks	Casing	
						Size	Set at
Marshall	771	6585				13-3/8"	51
Traverse Line	2536	SLM.	61182			8-1/4"	906
Dundee	3225	" 61869	4471	4474	(-3115)	5-3/16"	4468
			4491	4497	(-3135)		
			4623	4627	(-3267)		
Total Depth		4632	(-3276)				

Remarks 2473' eq. 2494' SLM; 3132' eq. 3134' SLM; 4634' eq. 4634' SLM.

Signed D. C. Shackelford