



Legacy Scout Tickets from Pure Oil Company

8-20-2021

MGRRE_PureOilScoutTickets_Horner, Frank S Tr_25_21113113530000

MGRRE

Western Michigan University

Follow this and additional works at: <https://scholarworks.wmich.edu/pure>



Part of the Geology Commons

WMU ScholarWorks Citation

MGRRE, "MGRRE_PureOilScoutTickets_Horner, Frank S Tr_25_21113113530000" (2021). *Legacy Scout Tickets from Pure Oil Company*. 5978.

<https://scholarworks.wmich.edu/pure/5978>

This Document is brought to you for free and open access via ScholarWorks at WMU. It has been accepted for inclusion in Legacy Scout Tickets from Pure Oil Company by an authorized administrator of ScholarWorks at WMU. See the National Digital Catalogue - Science Base Catalogue for more collections submitted by MGRRE.



MGRRE_PureOilScoutTickets_Horner, Frank S Tr_25_21113113530000

API 21113113530000

Permit Number 11353

Lease Name Horner, Frank S Tr

Well Number 25

County Missaukee

Township 24N

Range 05W

Section 15

2021 DEQ or Pure co_name Merit Energy Company

Pure Number 177

Latitude 44.4665384

Longitude -84.9122709

THE PURE OIL COMPANY LOCATION REPORT

Date February 14, 1945 A.F.E. No. _____

Division Mich. Producing District _____ Lease Frank S. Horner Tr.
Frank S. Horner, Tr.

Acres _____ Lease No. _____ Elevation _____ Well No. 25 (Serial No. 177)

Quadrangle C S₂ SW SW Sec. 15 Twp. 24 N Rge. 5 W Twp. Norwich
Norwich

Survey _____ County Missaukee State Michigan

Operator Sun Oil Co Map Norwich Twp - Missaukee Co
Sun Oil Company Norwich Township, Missaukee County

2310 2310 Feet from North Line of Lease

3300 3300 " " East " " "

" " South " " "

" " West " " "

Feet from North Line of Section

" " East " " "

330 330 " " South " " 1/4

660 660 " " West " " "

LEGEND

○ Location

☀ Gas Well

● Oil Well

☀ Gas - Distillate Well

∅ or ○ Dry Hole

● Dry Showing Oil

☀ Dry Showing Gas

⊗ Abandoned Location

☀ or ☀ Abandoned Gas Well

● or ● Abandoned Oil Well

● or ○ Input Well

low

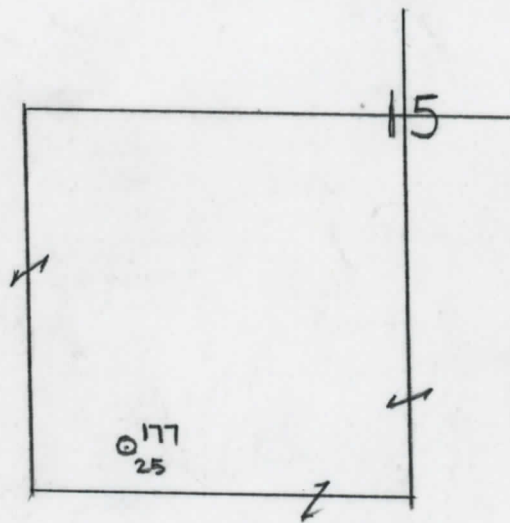

Remarks: _____ Scale _____

Submitted by RN Civil Engineer Approved by _____ Division Manager

Approved by _____ Vice-President - General Manager

Michigan Producing Division

Date September 6, 1945 No. 177
 State Michigan Co. Missaukee District Norwich Twp. Norwich Sec. 15 Twp. 24 N Rge. 5 W
 Well No. 25 Serial No. 177 Farm F. S. Horner, Tr. Acres _____
 Operator Sun Oil Company
 Date started 4-12-45 Date completed 7-16-45 Elevation 1172.1

PRODUCTION RECORD

1st 24 hours natural None reported.
 Date of shot 5-23-45; 7-19-45; No. of quarts _____ From 500 - Dundee - 3069-3100. To _____ From _____ to _____
 Date of acid 7-22-45 No. of gallons 4000 - Detroit River
 1st 24 hours after acid 75 barrels - flowed.
 Completed as: Oil Well Gas Well _____ Dry Hole _____

FORMATION AND CASING RECORD

Formation	Top	Bottom	Top Pay	Bottom Pay	Remarks	Casing	
						Size	Set at
Mich. Stray	521	4651				13-3/8"	55
Marshall	626	4516				8-5/8"	818
Traverse Lime	2385	4213			See remarks below.	6-5/8"	3124
Dundee	3074	4192	4345	4357	43173	5-3/16"	4313
			4425	4428	43253		
			4435	4441	43263		
Total Depth		4452	43280				
Cored:	3065	3102	Bleeding pin points oil 3079-3083.				4907
D.S.T.	3082	3102	Open 1 hr.-rec. 40 ft. oil and gas cut mud.				

Remarks D.S.T. 2376-2411 open one hour-recovered 540 ft. gas cut mud and salt water.
Perforated casing with 94 holes 3069-3100 and treated with acid - no results.
3067' equals 3067' SIM; 4060' equals 4073' SIM.

Signed D. C. Shackelford