



Legacy Scout Tickets from Pure Oil Company

8-20-2021

MGRRE_PureOilScoutTickets_Horner, Frank S Tr_20_21113114380000

MGRRE

Western Michigan University

Follow this and additional works at: <https://scholarworks.wmich.edu/pure>



Part of the Geology Commons

WMU ScholarWorks Citation

MGRRE, "MGRRE_PureOilScoutTickets_Horner, Frank S Tr_20_21113114380000" (2021). *Legacy Scout Tickets from Pure Oil Company*. 5980.

<https://scholarworks.wmich.edu/pure/5980>

This Document is brought to you for free and open access via ScholarWorks at WMU. It has been accepted for inclusion in Legacy Scout Tickets from Pure Oil Company by an authorized administrator of ScholarWorks at WMU. See the National Digital Catalogue - Science Base Catalogue for more collections submitted by MGRRE.



MGRRE_PureOilScoutTickets_Horner, Frank S Tr_20_21113114380000

API 21113114380000

Permit Number 11438

Lease Name Horner, Frank S Tr

Well Number 20

County Missaukee

Township 24N

Range 05W

Section 14

2021 DEQ or Pure co_name Merit Energy Company

Pure Number 179

Latitude 44.4775783

Longitude -84.8756079

THE PURE OIL COMPANY LOCATION REPORT

Date March 28, 1945

A.F.E. No. _____

Division Mich. Producing District _____

Lease Frank S. Horner, Tr.
Frank S. Horner, Tr.

Acres _____ Lease No. _____ Elevation _____ Well No. 20 (Serial No. 179)

Quadrangle CS 1/2 - NE - NE Sec. 14 Twp. 24 N Rge. 5 W Dist. Norwich
Norwich

Survey _____ County Missaukee State Michigan

Operator Sun Oil Co. Map Norwich
Sun Oil Company Norwich Township, Missaukee County

<u>8910</u>	<u>8910</u>	Feet from North Line of Lease
_____	_____	" " East " " "
_____	_____	" " South " " "
<u>4620</u>	<u>4620</u>	" " West " " "
<u>990</u>	<u>990</u>	Feet from North Line of Section
<u>660</u>	<u>660</u>	" " East " " "
_____	_____	" " South " " "
_____	_____	" " West " " "

LEGEND

- Location
- ☀ Gas Well
- Oil Well
- ☀ Gas - Distillate Well
- ⊘ or ○ Dry Hole
- or ○ Dry Showing Oil
- ☀ Dry Showing Gas
- ⊘ Abandoned Location
- ☀ or ☀ Abandoned Gas Well
- or ● Abandoned Oil Well
- or ○ Input Well

Low

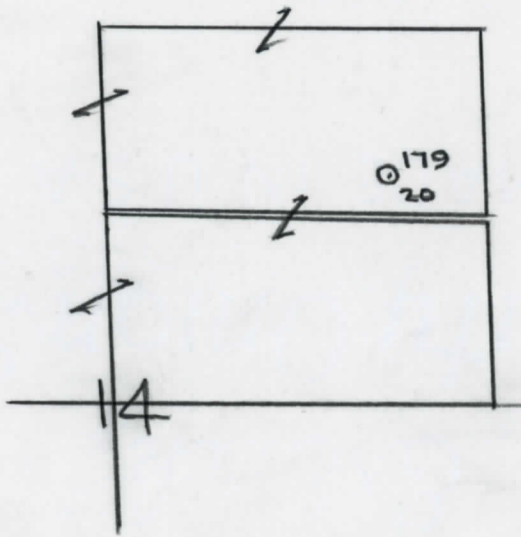

Scale _____

Remarks: _____

Submitted by RW _____ Approved by _____
Civil Engineer Division Manager

Approved by _____
Vice-President - General Manager

THE PURE OIL COMPANY

The Pure Oil Company
COMPLETION RECORD OF WELLS DRILLED BY OTHER OPERATORS

*Parted
off*

Michigan Producing Division

Date August 8, 1945 No. 179
 State Mich. Co. Missaukee Twp. Norwich Sec. 14 Twp. 24 N Rge 5 W
 Well No. 20 Serial No. 179 Farm F. S. Horner, Tr. Acres _____
 Operator Sun Oil Company
 Date started 4-28-45 Date completed 6-9-45 Elevation 1203.9

PRODUCTION RECORD

1st 24 hours natural None
 Date of shot 6-14-45 No. of quarts _____ From _____ To _____ From _____ to _____
 Date of acid 6-20-45 No. of gallons 2000 3000 - recovered hole full salt water.
8-2-45 No. of gallons 2000
 1st 24 hours after acid 65 Barrels (Flowed)
 Completed as: Oil Well _____ Gas Well _____ Dry Hole _____

FORMATION AND CASING RECORD

Formation	Top	Bottom	Top Pay	Bottom Pay	Remarks	Casing	
						Size	Set at
Marshall	631	(4593)				8-5/8"	801
Traverse Lime	2388	SLM.	(1184)			6-5/8"	3248
Dundee	3083	(1879)	4330	4333	(-3126) See remarks below.	5-3/16"	4321
			4348	4354	(-3144)		
			4460	4463	(-3256)		
Total Depth		4475	(-3271)				

Remarks Cored: 3069-3087 rec. 18 ft.; 3087 to 3105 rec. 16'9"; 3105 to 3114 rec. 7'6";
D.S.T. 3089 to 3114 - open 1 hr. - recovered 60 ft. gas cut mud and small show oil.
2405' eq. 2405' SLM; 3031' eq. 3041' SLM.

Signed D. C. Shackelford