



Western Michigan University  
ScholarWorks at WMU

---

Legacy Scout Tickets from Pure Oil Company

---

8-20-2021

**MGRRE\_PureOilScoutTickets\_State Forest\_1\_21113116750000**

MGRRE

*Western Michigan University*

Follow this and additional works at: <https://scholarworks.wmich.edu/pure>



Part of the Geology Commons

---

#### **WMU ScholarWorks Citation**

MGRRE, "MGRRE\_PureOilScoutTickets\_State Forest\_1\_21113116750000" (2021). *Legacy Scout Tickets from Pure Oil Company*. 5989.

<https://scholarworks.wmich.edu/pure/5989>

This Document is brought to you for free and open access via ScholarWorks at WMU. It has been accepted for inclusion in Legacy Scout Tickets from Pure Oil Company by an authorized administrator of ScholarWorks at WMU. See the National Digital Catalogue - Science Base Catalogue for more collections submitted by MGRRE.



---

**MGRRE\_PureOilScoutTickets\_State Forest\_1\_21113116750000**

API 21113116750000

Permit Number 11675

Lease Name State Forest

Well Number 1

County Missaukee

Township 23N

Range 07W

Section 19

2021 DEQ or Pure co\_name Reese, L. R.

Pure Number 188

Latitude 44.38101

Longitude -85.20648

# THE PURE OIL COMPANY

## LOCATION REPORT

Date July 18, 1945

A.F.E. No. \_\_\_\_\_

Division Mich. Producing District \_\_\_\_\_

Lease State - Forest  
State-Forest

Acres \_\_\_\_\_ Lease No. \_\_\_\_\_ Elevation \_\_\_\_\_ Well No. 1 (Serial No. 188)

Quadrangle NW NW NE Sec. 19 Twp. 23 N Rge. 7 W Twp. Forest

Survey \_\_\_\_\_ County Missaukee State Michigan

Operator L. R. Reese Map Forest Twp., Missaukee Co.  
Forest Township, Missaukee County

<u>330</u>	<u>330</u>	Feet from North Line of Lease
_____	_____	" " East " " "
_____	_____	" " South " " "
<u>330</u>	<u>330</u>	" " West " <u>1/4</u> "
<u>330</u>	<u>330</u>	Feet from North Line of Section
_____	_____	" " East " " "
_____	_____	" " South " " "
<u>330</u>	<u>330</u>	" " West " " "

### LEGEND

- Location
- ☀ Gas Well
- Oil Well
- ☀ Gas - Distillate Well
- ∅ or ○ Dry Hole
- Dry Showing Oil
- ☀ Dry Showing Gas
- ⊗ Abandoned Location
- ☀ or ☀ Abandoned Gas Well
- or ● Abandoned Oil Well
- or ○ Input Well

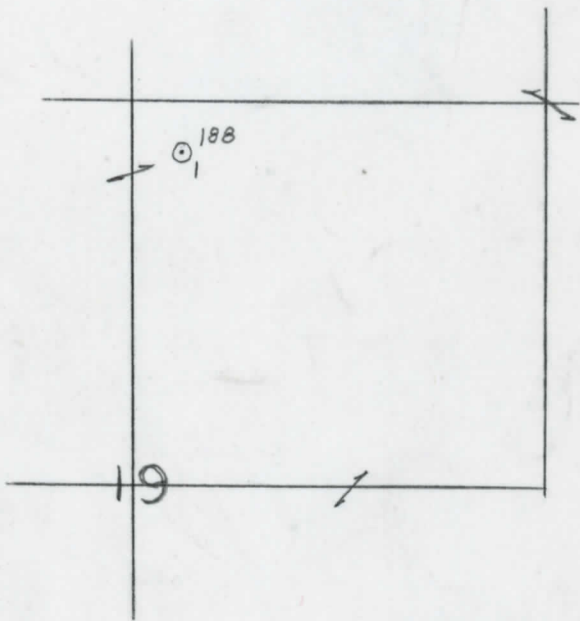

Remarks: \_\_\_\_\_

Scale \_\_\_\_\_

Submitted by \_\_\_\_\_  
Civil Engineer

Approved by \_\_\_\_\_  
Division Manager

Approved by \_\_\_\_\_  
Vice-President - General Manager



COMPLETION RECORD OF WELLS DRILLED BY OTHER OPERATORS

Michigan Producing Division W

Date September 12, 1945 No. 188  
 State Michigan Co. Missaukee Dist. Forest Sec. 19 Twp. 23 N Rge. 7 W  
 Well No. 1 Serial No. 188 Farm State-Forest Acres \_\_\_\_\_  
 Operator L. R. Reese  
 Date started 7-10-45 Date completed 9-9-45 Elevation 1203.1

PRODUCTION RECORD

1st 24 hours natural  
 Date of shot \_\_\_\_\_ No. of quarts \_\_\_\_\_ From \_\_\_\_\_ To \_\_\_\_\_ From \_\_\_\_\_ to \_\_\_\_\_  
 Date of acid \_\_\_\_\_ No. of gallons \_\_\_\_\_ shot \_\_\_\_\_  
 1st 24 hours after acid \_\_\_\_\_  
 Completed as: Oil Well \_\_\_\_\_ Gas Well \_\_\_\_\_ Dry Hole X

FORMATION AND CASING RECORD

Formation	Top	Bottom	Top Pay	Bottom Pay	Remarks	Casing	
						Size	Set at
Brown Dolomite	945	Schl.	(4258)			9-5/8"	630
Mich. Stray	1093	"	(4110)			6-5/8"	1413
Marshall	1184 (4119)	1344	Schl.			5-3/16"	3681
Coldw. Red Rock	2150	2154	(-947)				
Sunbury	2154	(-951)					
Antrim	2615	2977	SLM.	(-1472)			
Traverse Lime	3016	SLM.	(-1813)		Small show gas and 2500 ft. S.W. 3018-3023. (-1815)		
Dundee	3680 S	SLM.	(-2477)		3000 ft. S.W. in 5 days 3682-3686; (-2479) Inc. salt water 3814-3819. (-2611)		
Total Depth		3833	(-2630)				

Remarks 2017' equals 2015' SLM; 3019' equals 3023' SLM; 3046' equals 3046' SLM; 3682' equals 3682' SLM.

Signed D. C. Shackelford