



Legacy Scout Tickets from Pure Oil Company

---

8-20-2021

**MGRRE\_PureOilScoutTickets\_Horner, Frank S,  
Tr\_27\_21113118100000**

MGRRE  
*Western Michigan University*

Follow this and additional works at: <https://scholarworks.wmich.edu/pure>



Part of the Geology Commons

---

#### **WMU ScholarWorks Citation**

MGRRE, "MGRRE\_PureOilScoutTickets\_Horner, Frank S, Tr\_27\_21113118100000" (2021). *Legacy Scout Tickets from Pure Oil Company*. 5992.  
<https://scholarworks.wmich.edu/pure/5992>

This Document is brought to you for free and open access via ScholarWorks at WMU. It has been accepted for inclusion in Legacy Scout Tickets from Pure Oil Company by an authorized administrator of ScholarWorks at WMU. See the National Digital Catalogue - Science Base Catalogue for more collections submitted by MGRRE.



---

**MGRRE\_PureOilScoutTickets\_Horner, Frank S, Tr\_27\_21113118100000**

API 21113118100000

Permit Number 11810

Lease Name Horner, Frank S, Tr

Well Number 27

County Missaukee

Township 24N

Range 05W

Section 13

2021 DEQ or Pure co\_name Merit Energy Company

Pure Number 191

Latitude 44.4775395

Longitude -84.8704131

**THE PURE OIL COMPANY**  
**LOCATION REPORT**

Date September 12, 1945 A.F.E. No. FRANK S. HOENER, TR  
 Division Mich. Producing District \_\_\_\_\_ Lease Frank S. Horner, Tr.  
 Acres \_\_\_\_\_ Lease No. \_\_\_\_\_ Elevation \_\_\_\_\_ Well No. 27 (Serial No. 191)  
 Quadrangle S<sup>1</sup>/<sub>2</sub> NW NW Sec. 13 Twp. 24 N Rge. 5 W Twp. NORWICH  
 Survey \_\_\_\_\_ County MISSAUKEE State Michigan  
 Operator SUN OIL CO. Map Norwich Township, Missaukee County  
Sun Oil Company

<u>6270</u>	<u>6270</u>	Feet from North Line of Lease
_____	_____	" " East " " "
_____	_____	" " South " " "
<u>5940</u>	<u>5940</u>	" " West " " "
<u>990</u>	<u>990</u>	Feet from North Line of Section
_____	_____	" " East " " "
_____	_____	" " South " " "
<u>660</u>	<u>660</u>	" " West " " "

**LEGEND**

- Location
- ☀ Gas Well
- Oil Well
- ☀ Gas - Distillate Well
- ∅ or ○ Dry Hole
- Dry Showing Oil
- ☀ Dry Showing Gas
- ⊗ Abandoned Location
- ☀ or ☀ Abandoned Gas Well
- or ● Abandoned Oil Well
- or ○ Input Well

*Low*

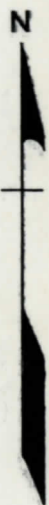
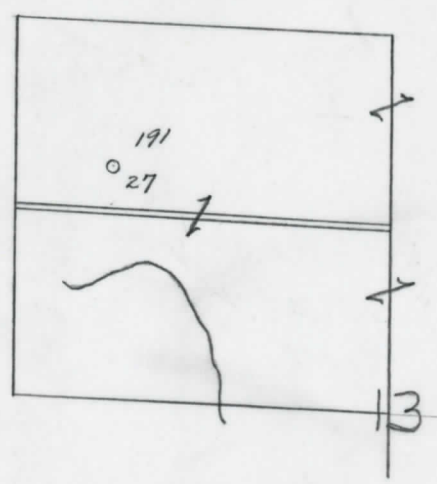

Remarks: \_\_\_\_\_ Scale \_\_\_\_\_

Submitted by \_\_\_\_\_ Civil Engineer Approved by \_\_\_\_\_ Division Manager  
 Approved by \_\_\_\_\_ Vice-President - General Manager

THE LOKE OIL COMPANY  
 COMPLETION RECORD OF WELLS DRILLED BY OTHER OPERATORS

Michigan Producing Division

Date December 12, 1945 No. 191  
 State Michigan Co. Missaukee District Norwich Sec. 13 Twp. 24 N Rge. 5 W  
 Well No. 27 Serial No. 191 Farm F. S. Horner, Tr. Acres \_\_\_\_\_  
 Operator Sun Oil Company  
 Date started 10-3-45 Date completed 12-1-45 Elevation 1224.5

PRODUCTION RECORD

1st 24 hours natural Small show oil.  
 Date of shot \_\_\_\_\_ No. of quarts \_\_\_\_\_ From \_\_\_\_\_ To \_\_\_\_\_ From \_\_\_\_\_ to \_\_\_\_\_  
 Date of acid 12-4-45 No. of gallons 5000  
 1st 24 hours after acid Flowed 75 Barrels.  
 Completed as: Oil Well  Gas Well \_\_\_\_\_ Dry Hole \_\_\_\_\_

FORMATION AND CASING RECORD

Formation	Top	Bottom	Top Pay	Bottom Pay	Remarks	Casing	
						Size	Set at
Mich. Stray	513	S.L.M.	(+712)			8-5/8"	809
Marshall	646	(+579)				5-3/16"	4357
Traverse Line	2407	(-1182)					
Dundee	3093	(-1868)					
Detroit River	3405	(-2180)					
Det. River Salt	3450	4186	(-2225)	4363-66	(-3138)		
				4375-85.	(-3150)		
Total Depth		4515	(-3290)				

Remarks 584' DSM equals 558' SLM.

Signed D. C. Shackelford