



Western Michigan University  
ScholarWorks at WMU

---

Legacy Scout Tickets from Pure Oil Company

---

8-20-2021

**MGRRE\_PureOilScoutTickets\_Horner, F S\_30\_21113120810000**

MGRRE

*Western Michigan University*

Follow this and additional works at: <https://scholarworks.wmich.edu/pure>



Part of the Geology Commons

---

#### **WMU ScholarWorks Citation**

MGRRE, "MGRRE\_PureOilScoutTickets\_Horner, F S\_30\_21113120810000" (2021). *Legacy Scout Tickets from Pure Oil Company*. 5998.

<https://scholarworks.wmich.edu/pure/5998>

This Document is brought to you for free and open access via ScholarWorks at WMU. It has been accepted for inclusion in Legacy Scout Tickets from Pure Oil Company by an authorized administrator of ScholarWorks at WMU. See the National Digital Catalogue - Science Base Catalogue for more collections submitted by MGRRE.



---

**MGRRE\_PureOilScoutTickets\_Horner, F S\_30\_21113120810000**

API 21113120810000

Permit Number 12081

Lease Name Horner, F S

Well Number 30

County Missaukee

Township 24N

Range 05W

Section 12

2021 DEQ or Pure co\_name Merit Energy Company

Pure Number 200

Latitude 44.4811796

Longitude -84.8551643

THE PURE OIL COMPANY

LOCATION REPORT

Date January 16, 1946

A.F.E. No. \_\_\_\_\_

Division Mich. Producing District \_\_\_\_\_

Lease F. S. Horner, Tr.

Acres \_\_\_\_\_ Lease No. \_\_\_\_\_ Elevation \_\_\_\_\_ Well No. 30 (Serial No. 200)

Quadrangle C-5/2-SE-SE Sec. 12 Twp. 24 N Rge. 5 W Twp. Norwich

Survey \_\_\_\_\_ County Missaukee State Michigan

Operator Sun Oil Co. Map Norwich Township, Missaukee County

2310	2310	Feet from North Line of Lease
660	660	" " East " " "
		" " South " " "
		" " West " " "
		Feet from North Line of Section
660	660	" " East " " <u>1/4</u>
330	330	" " South " " "
		" " West " " "

LEGEND

- Location
- ☀ Gas Well
- Oil Well
- ☀ Gas - Distillate Well
- ∅ or ○ Dry Hole
- Dry Showing Oil
- ☀ Dry Showing Gas
- ⊗ Abandoned Location
- ☀ or ☀ Abandoned Gas Well
- or ● Abandoned Oil Well
- or ○ Input Well

*low*

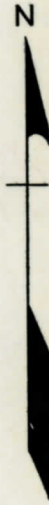
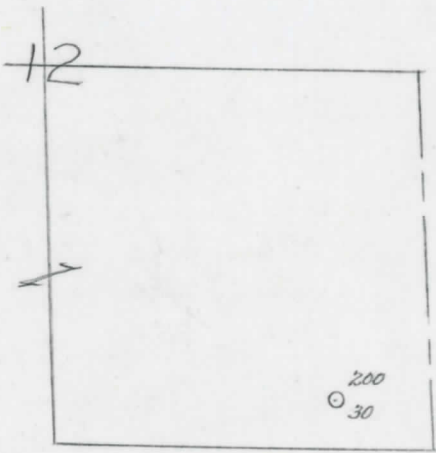

Scale \_\_\_\_\_

Remarks: \_\_\_\_\_

Submitted by CB Civil Engineer

Approved by \_\_\_\_\_ Division Manager

Approved by \_\_\_\_\_ Vice-President - General Manager



LOCATION REPORT

COMPLETION RECORD OF WELLS DRILLED BY OTHER OPERATORS

Michigan Producing Division

Date April 10, 1946 No. 200  
 State Michigan Co. Missaukee District C-5-SE-SE  
 Twp. Norwich Sec. 12 Twp. 24 N Rge. 5 W  
 Well No. 30 Serial No. 200 Farm F. S. Horner, Tr. Acres \_\_\_\_\_  
 Operator Sun Oil Company  
 Date started 2-7-46 Date completed 3-15-46 Elevation 1221.5

PRODUCTION RECORD

1st 24 hours natural None reported.  
 Date of shot \_\_\_\_\_ No. of quarts \_\_\_\_\_ From \_\_\_\_\_ To \_\_\_\_\_ From \_\_\_\_\_ to \_\_\_\_\_  
 Date of acid 3-22-46 No. of gallons 4000  
 1st 24 hours after acid Flowed 50 Barrels  
 Completed as: Oil Well  Gas Well \_\_\_\_\_ Dry Hole \_\_\_\_\_

FORMATION AND CASING RECORD

Formation	Top	Bottom	Top Pay	Bottom Pay	Remarks	Casing	
						Size	Set at
Marshall	615	(1607)				10"	420
Traverse Lime	2388	(1166)				5-3/16"	4431
Dundee	3081	(1859)					
Detroit River	3400	(2178)	4314	4316	(3092)		
			4341	4344	(3119)		
			4350	4359	(3128)		
			4384	4387	(3162)		
Total Depth		4492	(3270)				
Plugged back:		4424	(3202)				
Plugged back T.D.		4364	Comp. 9-26-48				

Remarks Perforated: 4312-4319 with 24 holes; 4339-4362 with 78 holes; 4371-4376 - 20 holes; 4383-4396 - 44 holes; 4403-4406 - 10 holes.

Signed D. C. Shackelford