



Western Michigan University  
ScholarWorks at WMU

---

Legacy Scout Tickets from Pure Oil Company

---

8-20-2021

## MGRRE\_PureOilScoutTickets\_Weider-Vandermuelen Unit\_1\_21113121010000

MGRRE

*Western Michigan University*

Follow this and additional works at: <https://scholarworks.wmich.edu/pure>



Part of the Geology Commons

---

### WMU ScholarWorks Citation

MGRRE, "MGRRE\_PureOilScoutTickets\_Weider-Vandermuelen Unit\_1\_21113121010000" (2021). *Legacy Scout Tickets from Pure Oil Company*. 5999.  
<https://scholarworks.wmich.edu/pure/5999>

This Document is brought to you for free and open access via ScholarWorks at WMU. It has been accepted for inclusion in Legacy Scout Tickets from Pure Oil Company by an authorized administrator of ScholarWorks at WMU. See the National Digital Catalogue - Science Base Catalogue for more collections submitted by MGRRE.



---

**MGRRE\_PureOilScoutTickets\_Weider-Vandermuelen Unit\_1\_21113121010000**

API 21113121010000

Permit Number 12101

Lease Name Weider-Vandermuelen Unit

Well Number 1

County Missaukee

Township 22N

Range 07W

Section 34

2021 DEQ or Pure co\_name Union Drilling and Producing Company

Pure Number 201

Latitude 44.25769

Longitude -85.14313

THE PURE OIL COMPANY

LOCATION REPORT

Date January 30, 1946

A.F.E. No. \_\_\_\_\_

Division Mich. Producing

District \_\_\_\_\_

Lease Weidler-Vandermuelen Unit

Acres \_\_\_\_\_ Lease No. \_\_\_\_\_ Elevation \_\_\_\_\_ Well No. 1 (Serial No. 201)

Quadrangle NW-NW-SE Sec. 34 Twp. 22 N Rge. 7 W Twp. Reeder

Survey \_\_\_\_\_ County Missaukee State Michigan

Operator Union Drilling & Producing Company Map Reeder Township, Missaukee County

Feet from North Line of Lease

2440 2440 " " East " " "

2240 2240 " " South " " "

" " West " " "

Feet from North Line of Section

400 400 " " East " " "

" " South " " "

200 200 " " West " " "

LEGEND

- ☉ Gas Well
- Oil Well
- ☉ or ☉ Gas - Distillate Well
- ☉ or ☉ Dry Hole
- or ● Dry Showing Oil
- Location
- ☉ Dry Showing Gas
- ☉ Abandoned Location
- ☉ or ☉ Abandoned Gas Well
- or ● Abandoned Oil Well
- or ○ Input Well

*low*

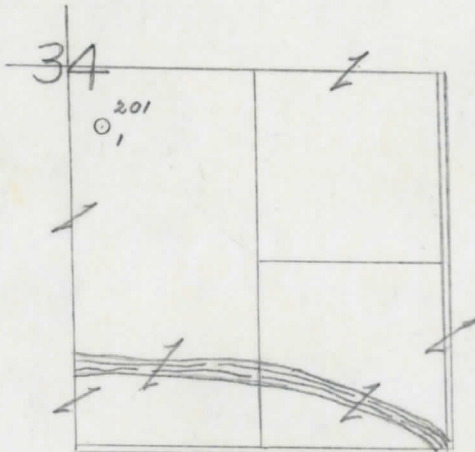

Scale \_\_\_\_\_

Remarks: \_\_\_\_\_

Submitted by CB \_\_\_\_\_  
Civil Engineer

Approved by \_\_\_\_\_  
Division Manager

Approved by \_\_\_\_\_  
Vice-President - General Manager

Date

7 30' 10 1/2

LOCATION REPORT

V.E.E. NO. 114

COMPLETION RECORD OF WELLS DRILLED BY OTHER OPERATORS

W.C.

Michigan Producing Division

Date **March 6, 1946** No. **201**

State **Michigan** Co. **Missaukee** Twp. **Reeder** Sec. **34** Twp. **22 N** Rge. **7 W**

Well No. **1** Serial No. **201** Farm **Weidler-Vandermuelen** Unit Acres

Operator **Union Drilling & Producing Company**

Date started **2-11-46** Date completed **2-20-46** Elevation **1191.1**

PRODUCTION RECORD

1st 24 hours natural

Date of shot No. of quarts From To From to

Date of acid shot No. of gallons

1st 24 hours after acid

Completed as: Oil Well Gas Well Dry Hole **X**

FORMATION AND CASING RECORD

Formation	Top	Bottom	Top Pay	Bottom Pay	Remarks	Casing	
						Size	Set at
Brown Dolomite	1225	(-34)				8-5/8"	316
Mich. Stray	1365	(-174)			Salt water 1394-1406. (-203)	5-3/16"	1390
Total Depth		1406	(-215)				

Remarks **Gas test - no showings of gas.**

Signed **D. C. Shackelford**