



Western Michigan University
ScholarWorks at WMU

Legacy Scout Tickets from Pure Oil Company

8-20-2021

**MGRRE_PureOilScoutTickets_Bunning,
Albert_1_21113122370000**

MGRRE
Western Michigan University

Follow this and additional works at: <https://scholarworks.wmich.edu/pure>



Part of the Geology Commons

WMU ScholarWorks Citation

MGRRE, "MGRRE_PureOilScoutTickets_Bunning, Albert_1_21113122370000" (2021). *Legacy Scout Tickets from Pure Oil Company*. 6003.
<https://scholarworks.wmich.edu/pure/6003>

This Document is brought to you for free and open access via ScholarWorks at WMU. It has been accepted for inclusion in Legacy Scout Tickets from Pure Oil Company by an authorized administrator of ScholarWorks at WMU. See the National Digital Catalogue - Science Base Catalogue for more collections submitted by MGRRE.



MGRRE_PureOilScoutTickets_Bunning, Albert_1_21113122370000

API 21113122370000

Permit Number 12237

Lease Name Bunning, Albert

Well Number 1

County Missaukee

Township 22N

Range 06W

Section 30

2021 DEQ or Pure co_name Union Oil Company of California

Pure Number 209

Latitude 44.27332

Longitude -85.07663

THE PURE OIL COMPANY

LOCATION REPORT

Date April 17, 1946 A.F.E. No. _____

Division Mich. Producing District _____ Lease Albert Bunning
Albert Bunning

Acres _____ Lease No. _____ Elevation _____ Well No. 1 (Serial No. 209)

Quadrangle C-5/2-SE-NE Sec. 30 Twp. 22 N Rge. 6 W ~~SEK~~ ~~RICK~~ Aetna
C S 2 SE NE 30 22 N 6 W Aetna

Survey _____ County Missaukee State Michigan

Operator Pure Oil Co.
The Pure Oil Company Map Aetna Township, Missaukee County

660	660	"	"	East	"	"	"
330	330	"	"	South	"	"	"
		"	"	West	"	"	"

660	660	"	"	East	"	<u>1/4</u>	"
330	330	"	"	South	"	"	"
		"	"	West	"	"	"

LEGEND

- Location
- ☉ Gas Well
- Oil Well
- ☼ Gas - Distillate Well
- ⊖ or ○ Dry Hole
- or ○ Dry Showing Oil
- ☉ Dry Showing Gas
- ⊖ Abandoned Location
- ☼ or ☼ Abandoned Gas Well
- or ● Abandoned Oil Well
- or ○ Input Well

Puro

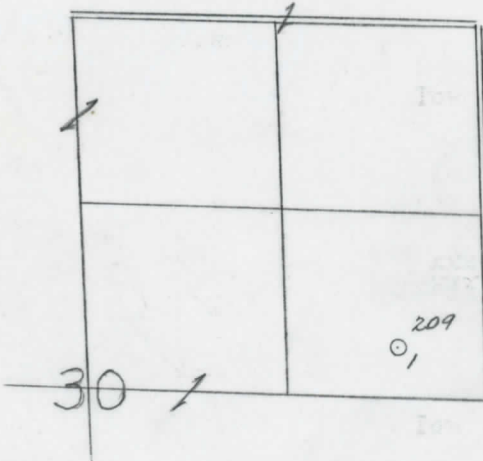

Remarks: Taggart Brothers will drill down or through Marshall; if prospects look good Pure oil will drill the well deeper. look of pure oil will drill the well deeper. look of pure oil will drill the well deeper. Scale _____

Submitted by CB Civil Engineer Approved by _____ Division Manager

Approved by _____ Vice-President - General Manager

COMPLETION RECORD OF WELLS DRILLED BY OTHER OPERATORS

Michigan Producing Division

Date **May 8, 1946** No. **209**
 State **Mich.** Co. **Missaukee** ~~xxxx~~ Twp. **Aetna** Sec. **30** Twp. **22 N** Rge. **6 W**
 Well No. **1** Serial No. **209** Farm **Albert Bunning** Acres _____
 Operator **The Pure Oil Company**
 Date started **4-17-46** Date completed **5-4-46** Elevation **1207.7**

PRODUCTION RECORD

1st 24 hours natural _____
 Date of shot _____ No. of quarts _____ From _____ To _____
 Date of acid _____ No. of gallons _____
 1st 24 hours after acid _____
 Completed as: Oil Well _____ Gas Well _____ Dry Hole **X**

FORMATION AND CASING RECORD

Formation	Top	Bottom	Top Pay	Bottom Pay	Remarks	Casing	
						Size	Set at
Brown Dolomite	1132	S.L.M.	(+76)			13-3/8"	410
Mich. Stray	1302	(-94)			125 ft. sulphur	8-1/4"	1285
Marshall	1434	(-226)			wtr. in 3/4 hr.		
Total Depth		1457	(-249)		1302-1306.		
					(-94)		

Remarks _____

Signed **D. G. Shackelford**