



Legacy Scout Tickets from Pure Oil Company

8-20-2021

**MGRRE_PureOilScoutTickets_Smith, E.
Bertha_1_21113124310000**

MGRRE
Western Michigan University

Follow this and additional works at: <https://scholarworks.wmich.edu/pure>



Part of the Geology Commons

WMU ScholarWorks Citation

MGRRE, "MGRRE_PureOilScoutTickets_Smith, E. Bertha_1_21113124310000" (2021). *Legacy Scout Tickets from Pure Oil Company*. 6007.
<https://scholarworks.wmich.edu/pure/6007>

This Document is brought to you for free and open access via ScholarWorks at WMU. It has been accepted for inclusion in Legacy Scout Tickets from Pure Oil Company by an authorized administrator of ScholarWorks at WMU. See the National Digital Catalogue - Science Base Catalogue for more collections submitted by MGRRE.



MGRRE_PureOilScoutTickets_Smith, E. Bertha_1_21113124310000

API 21113124310000

Permit Number 12431

Lease Name Smith, E. Bertha

Well Number 1

County Missaukee

Township 24N

Range 07W

Section 8

2021 DEQ or Pure co_name Freeman Oil Company

Pure Number 214

Latitude 44.49604

Longitude -85.19088

THE PURE OIL COMPANY

COMPLETION RECORD OF WELLS DRILLED BY OTHER OPERATORS

LOCATION REPORT

Date July 3, 1946 A.F.E. No. E. Bertha Smith
 Division Mich. Producing District _____ Lease E. Bertha Smith
 Acres _____ Lease No. _____ Elevation _____ Well No. 1 (Serial No. 214)
 Quadrangle NE-NW-NW Sec. 8 Twp. 24 N Rge. 7 W Twp. Pioneer
 Survey _____ County Missaukee State Michigan
 Operator Freeman Oil Co Map Pioneer Township, Missaukee County
Freeman Oil Company

<u>330</u>	<u>330</u>	Feet from North Line of Lease
_____	_____	" " East " " "
_____	_____	" " South " " "
<u>990</u>	<u>990</u>	" " West " " "
<u>330</u>	<u>330</u>	Feet from North Line of Section
_____	_____	" " East " " "
_____	_____	" " South " " "
<u>990</u>	<u>990</u>	" " West " " "

LEGEND

- Location
- ☉ Gas Well
- Oil Well
- ☉ Gas - Distillate Well
- or ○ Dry Hole
- or ● Dry Showing Oil
- with slash Dry Showing Gas
- with slash Abandoned Location
- ☉ or ☉ Abandoned Gas Well
- or ● Abandoned Oil Well
- or ○ Input Well

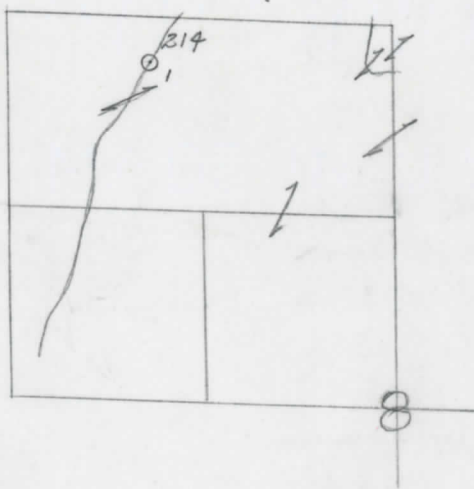

Scale _____

Remarks: _____

Submitted by CB Civil Engineer Approved by _____ Division Manager

Approved by _____ Vice-President - General Manager

Michigan Producing Division

Date October 30, 1946 No 214
 State Mich. Co. Missaukee Dist. _____
 Twp. Pioneer Sec. 8 Twp. 24N Rge. 7W
 Well No. 1 Serial No. 214 Farm E. Bertha Smith Acres _____
 Operator Freeman Oil Co.
 Date started 8-6-46 Date completed 10-19-46 Elevation 1064.7

PRODUCTION RECORD

1st 24 hours natural _____
 Date of shot _____ No. of quarts _____ From _____ To _____
 Date of acid _____ No. of gallons _____
 1st 24 hours after acid _____
 Completed as: Oil Well _____ Gas Well _____ Dry Hole X

FORMATION AND CASING RECORD

Formation	Top	Bottom	Top Pay	Bottom Pay	Remarks	Casing	
						Size	Set at
Brown Dolomite	440	455	(+625)			10-3/4"	400
Dolomite Stray	582	(+483)			Gas 2542-48 (-1477)	8-1/4"	918
Mich. Stray-Good Sand	600	633	(+465)		Gauged 285 MCF	7"	3465
Marshall	708	850	(+358)		Small Show Blk. Oil		
Sunbury	1687	(-622)			2561 (-1496)		
Antrim	2267	(-1202)			1 Bail Salt Wtr.		
Trav. Forn	2487	(-1422)			per Hr. 2561-65	(-1496)	
Trav. Lime	2535	(-1470)			1000' Salt Wtr. 3		
Dundee	3207	(-2142)			Hrs, 3135-42	(-2070)	
Salt	3513	(-2448)			Salt Wtr. 3285-3300	(-2220)	
Total Depth	4520	(-3455)			Hole Filled up		
					Small Show Salt Wtr.		
					3560 (-2495)		

Remarks Small Show Sulphur Gas 4070 and at 4155. 1 Bail. S.W. 1 Hr. 4235-45. Very small show oil 4405-10 - 10 Bail. S.W. 1 1/2 Hrs. 4510-20 - Filled up 3500' S.W. 48 Hrs. 4520. 2480 CTM = 2512 SOM 3193 CTM = 3189 SLM 4385 CTM = 4395 SLM - 7" casing set at 3207. then reset 3465
 (-3000) (-3070) (-3170) (-3445) (-3455)

Signed Harry J. Gaspeny