



Western Michigan University  
ScholarWorks at WMU

---

Legacy Scout Tickets from Pure Oil Company

---

8-20-2021

**MGRRE\_PureOilScoutTickets\_Horner, F S Norwich Unit Tr  
4\_35\_21113128170000**

MGRRE  
*Western Michigan University*

Follow this and additional works at: <https://scholarworks.wmich.edu/pure>



Part of the Geology Commons

---

#### **WMU ScholarWorks Citation**

MGRRE, "MGRRE\_PureOilScoutTickets\_Horner, F S Norwich Unit Tr 4\_35\_21113128170000" (2021).  
*Legacy Scout Tickets from Pure Oil Company*. 6009.  
<https://scholarworks.wmich.edu/pure/6009>

This Document is brought to you for free and open access via ScholarWorks at WMU. It has been accepted for inclusion in Legacy Scout Tickets from Pure Oil Company by an authorized administrator of ScholarWorks at WMU. See the National Digital Catalogue - Science Base Catalogue for more collections submitted by MGRRE.



---

MGRRE\_PureOilScoutTickets\_Horner, F S Norwich Unit Tr 4\_35\_21113128170000

API 21113128170000

Permit Number 12817

Lease Name Horner, F S Norwich Unit Tr 4

Well Number 35

County Missaukee

Township 24N

Range 05W

Section 16

2021 DEQ or Pure co\_name Merit Energy Company

Pure Number 217

Latitude 44.4701837

Longitude -84.9218857

T  
A

# THE PURE OIL COMPANY LOCATION REPORT

Date December 4, 1946 A.F.E. No. \_\_\_\_\_  
 Division Mich. Producing District \_\_\_\_\_ Lease F. S. Horner  
 Acres \_\_\_\_\_ Lease No. \_\_\_\_\_ Elevation \_\_\_\_\_ Well No. 35 (Serial No. 217)  
 Quadrangle C S<sup>1</sup>/<sub>2</sub> NW SE Sec. 16 Twp. 24 N Rge. 5 W Norwich Twp. Norwich  
 Survey \_\_\_\_\_ County Missaukee State Michigan  
 Operator Sun Oil Co. Map Norwich Township, Missaukee County  
Sun Oil Company

<u>3630</u>	<u>3630</u>	Feet from North Line of Lease
_____	_____	" " East " " "
_____	_____	" " South " " "
<u>3300</u>	<u>3300</u>	" " West " " "
<u>990</u>	<u>990</u>	Feet from North Line of Section
_____	_____	" " East " " "
_____	_____	" " South " " "
<u>660</u>	<u>660</u>	" " West " " "

**LEGEND**

- Location
- ☀ Gas Well
- Oil Well
- ☀ Gas - Distillate Well
- ∅ or ○ Dry Hole
- Dry Showing Oil
- ☀ Dry Showing Gas
- ⊗ Abandoned Location
- ☀ or ☀ Abandoned Gas Well
- or ● Abandoned Oil Well
- or ○ Input Well

*Acres Loc*

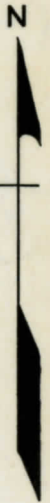
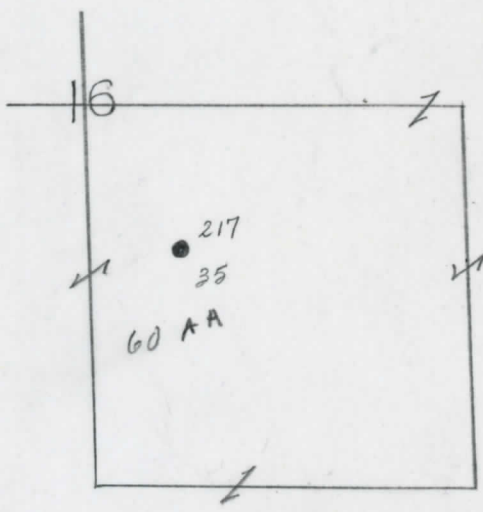

Remarks: \_\_\_\_\_ Scale \_\_\_\_\_

Submitted by CB Civil Engineer Approved by \_\_\_\_\_ Division Manager  
 Approved by \_\_\_\_\_ Vice-President - General Manager