



Western Michigan University
ScholarWorks at WMU

Legacy Scout Tickets from Pure Oil Company

8-20-2021

**MGRRE_PureOilScoutTickets_Milan well aka City of
Milan_1_21115004699000**

MGRRE
Western Michigan University

Follow this and additional works at: <https://scholarworks.wmich.edu/pure>



Part of the Geology Commons

WMU ScholarWorks Citation

MGRRE, "MGRRE_PureOilScoutTickets_Milan well aka City of Milan_1_21115004699000" (2021). *Legacy Scout Tickets from Pure Oil Company*. 6013.
<https://scholarworks.wmich.edu/pure/6013>

This Document is brought to you for free and open access via ScholarWorks at WMU. It has been accepted for inclusion in Legacy Scout Tickets from Pure Oil Company by an authorized administrator of ScholarWorks at WMU. See the National Digital Catalogue - Science Base Catalogue for more collections submitted by MGRRE.



MGRRE_PureOilScoutTickets_Milan well aka City of Milan_1_21115004699000

API 21115004699000

Permit Number 469

Lease Name Milan well aka City of Milan

Well Number 1

County Monroe

Township 05S

Range 06E

Section 2

2021 DEQ or Pure co_name Milan Oil and Gas Company

Pure Number 6

Latitude 42.0769707

Longitude -83.6858341

THE PURE OIL COMPANY
LOCATION REPORTDATE 2-21-29No. 6STATE Mich COUNTY Monroe DIST. Milan SEC. 2 TOWN 58 RANGE 6E
TWP. Milan PREC.WELL No. (SERIAL No. 6) FARM City of Milan ACRESNAME OF STREAM OR WATERS Saline River QUADRANGLE Milan top 2 1/2" x 4 1/4"OPERATOR MAP Milan top 2 1/2" x 4 1/4"

..... Feet from North Line of Farm

..... " " East " " "

..... " " South " " "

..... " " West " " "

800 Feet from North Line of Section300 " " East " " "

..... " " South " " "

7600 " " West " " "

LEGEND

O LOCATION

① RIG

⊕ DRILLING

⊗ GAS WELL

● OIL WELL

⬮ SMALL OIL WELL

⊗ DRY HOLE

⬮ DRY SHOWING OIL

⊗ DRY SHOWING GAS

⊗ ABANDONED LOCATION

⬮ ABANDONED GAS WELL

⬮ ABANDONED OIL WELL

NOTE: Below make tracing from map, (when no map is obtainable make sketch) showing farm, center of section, this location with measurements and also wells, dry holes, or other locations in the vicinity of this location. Make copy to keep for reference and send original to Columbus office.

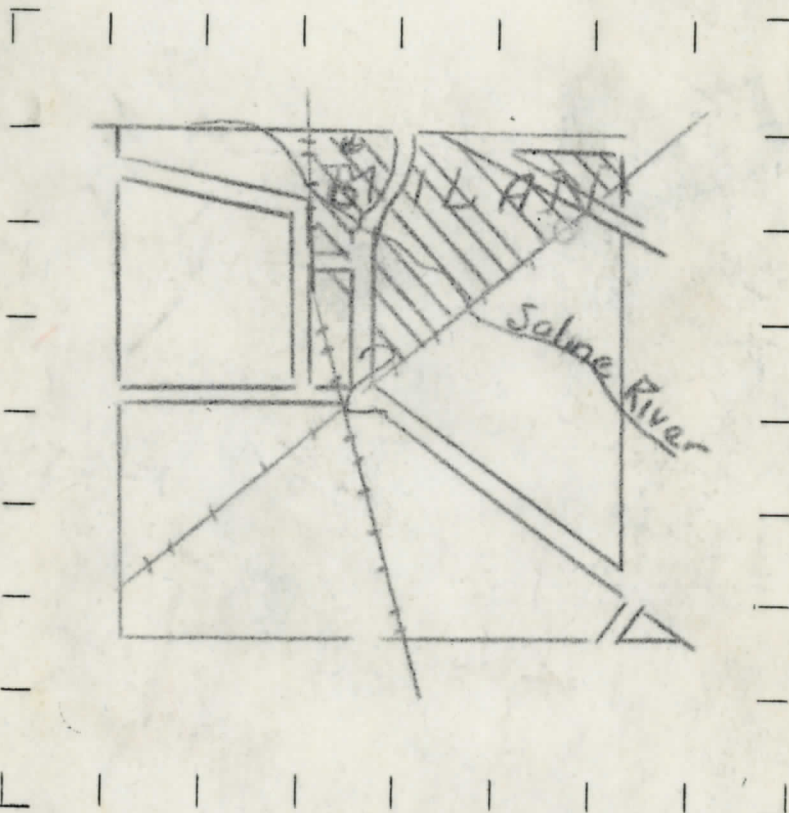

REMARKS:

Pub 19 Mich Geol Surv. Page 81

SIGNED

Superintendent or Foreman.

STATE Mich COUNTY Monroe DIST. Milan SEC. 2 TOWN 5S RANGE 6E
 WELL No. 1 (SERIAL No. 6) FARM City of Milan ACRES

NAME OF STREAM OR WATERS Saline River QUADRANGLE

OPERATOR City of Milan MAP Milan twp 2 1/2" = 1 Mi

Feet from North Line of Farm

" " East " " "
 " " South " " "
 " " West " " "

300 Feet from North Line of Section

" " East " " "
 " " South " " "
2600 " " West " " "

LEGEND

- | | |
|------------------|----------------------|
| ○ LOCATION | ⊗ DRY HOLE |
| ① RIG | ⊕ DRY SHOWING OIL |
| ⊕ DRILLING | ⊗ DRY SHOWING GAS |
| ⊗ GAS WELL | ⊗ ABANDONED LOCATION |
| ● OIL WELL | ⊗ ABANDONED GAS WELL |
| ⊕ SMALL OIL WELL | ⊗ ABANDONED OIL WELL |

NOTE: Below make tracing from map, (when no map is obtainable make sketch) showing farm, center of section, this location with measurements and also wells, dry holes, or other locations in the vicinity of this location. Make copy to keep for reference and send original to Columbus office.

E1. 685

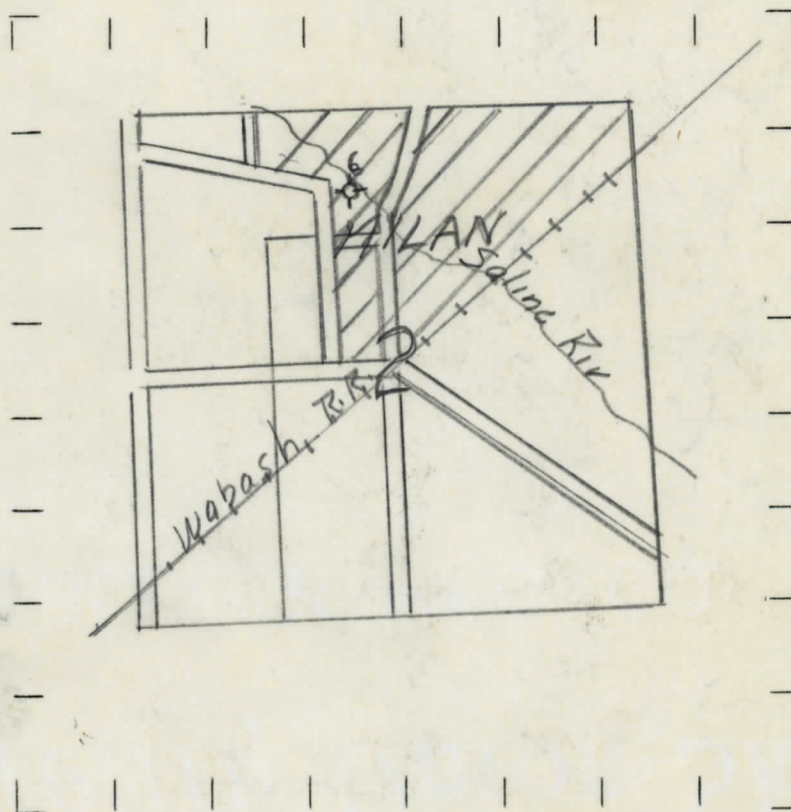

REMARKS:

SIGNED

Superintendent or Foreman.

