



Western Michigan University  
ScholarWorks at WMU

---

Legacy Scout Tickets from Pure Oil Company

---

8-20-2021

**MGRRE\_PureOilScoutTickets\_Roe, F (Orig Cletus  
Dusseau)\_1\_21115000549000**

MGRRE  
*Western Michigan University*

Follow this and additional works at: <https://scholarworks.wmich.edu/pure>



Part of the Geology Commons

---

#### WMU ScholarWorks Citation

MGRRE, "MGRRE\_PureOilScoutTickets\_Roe, F (Orig Cletus Dusseau)\_1\_21115000549000" (2021). *Legacy Scout Tickets from Pure Oil Company*. 6018.  
<https://scholarworks.wmich.edu/pure/6018>

This Document is brought to you for free and open access via ScholarWorks at WMU. It has been accepted for inclusion in Legacy Scout Tickets from Pure Oil Company by an authorized administrator of ScholarWorks at WMU. See the National Digital Catalogue - Science Base Catalogue for more collections submitted by MGRRE.



---

**MGRRE\_PureOilScoutTickets\_Roe, F (Orig Cletus Dusseau)\_1\_21115000549000**

API 21115000549000

Permit Number 54

Lease Name Roe, F (Orig Cletus Dusseau)

Well Number 1

County Monroe

Township 06S

Range 06E

Section 19

2021 DEQ or Pure co\_name Deerfield Oil and Gas Company

Pure Number 19

Latitude 41.94454

Longitude -83.75973

*Completed Location Report*

DATE April 17th 1928

THE PURE OIL COMPANY

LOCATION REPORT

No. 19STATE Michigan COUNTY MonroeDIST. Dundee  
TWP. 19  
PREC. 89@SEC. 19TOWN 65RANGE 6EWELL No. 1 (SERIAL No. 19) FARM Frank Roe ACRES 89@

NAME OF STREAM OR WATERS

QUADRANGLE

OPERATOR Deerfield Oil CoMAP Scale 4 1/4 inches = 1 mile

Feet from North Line of Farm

" " East " " "

" " South " " "

" " West " " "

Feet from North Line of Section

" " East " " "

" " South " " "

" " West " " "

## LEGEND

O LOCATION

① RIG

⊕ DRILLING

⊗ GAS WELL

● OIL WELL

⬮ SMALL OIL WELL

⬮ DRY HOLE

⬮ DRY SHOWING OIL

⬮ DRY SHOWING GAS

⬮ ABANDONED LOCATION

⬮ ABANDONED GAS WELL

⬮ ABANDONED OIL WELL

NOTE: Below make tracing from map (when no map is obtainable make sketch), showing farm, center of section, this location with measurements and also wells, dry holes, or other locations in the vicinity of this location. Make copy to keep for reference and send original to Columbus office.

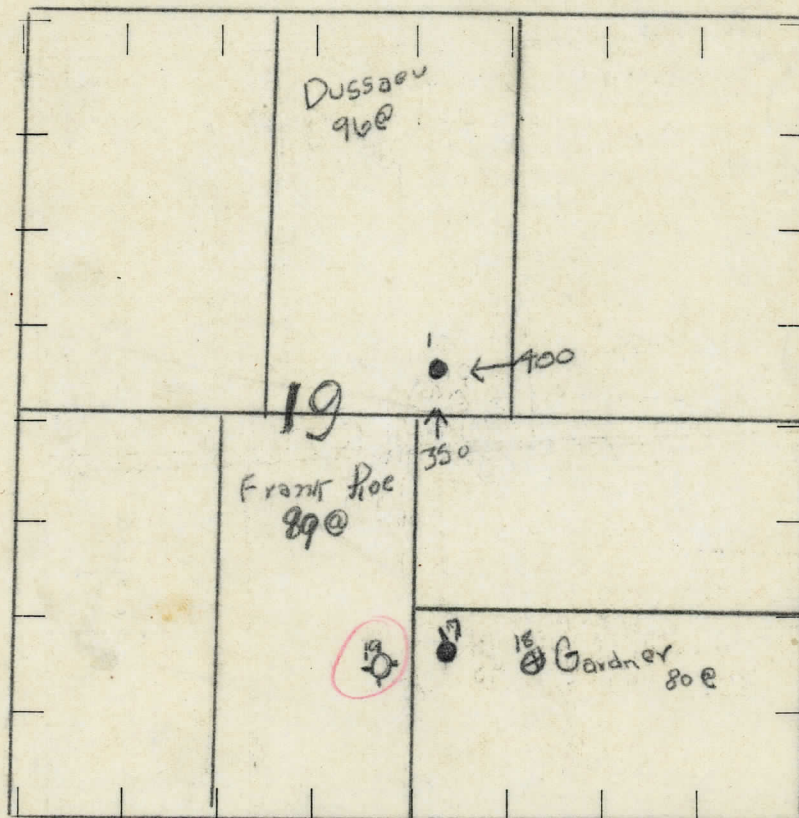

REMARKS:

No. 19 300 west of Number 17

SIGNED

Superintendent or Foreman.

OBSERVATION *20916* *11:15 AM*  
 NAME OF SURVEYOR OR MEASURER *CONTRACTOR*  
 WELL NO. *2* (SERIAL NO. *19*) FARM *Gardner* ACRES  
 STATE *ILLINOIS* COUNTY *DEERFIELD* TOWNSHIP *14* RANGE *10*  
 NAME OF STREAM OR WATERS *Deerfield Oil Gas Co* QUADRANGLE  
 OPERATOR *Stamp* MAP

Feet from North Line of Farm  
 " " East " " "  
 " " South " " "  
 " " West " " "  
 Feet from North Line of Section  
 " " East " " "  
 " " South " " "  
 " " West " " "

**LEGEND**

- |                  |                      |
|------------------|----------------------|
| ○ LOCATION       | ⊕ DRY HOLE           |
| ① RIG            | ⬢ DRY SHOWING OIL    |
| ⊕ DRILLING       | ⬢ DRY SHOWING GAS    |
| ⊙ GAS WELL       | ⊙ ABANDONED LOCATION |
| ● OIL WELL       | ⊙ ABANDONED GAS WELL |
| ⬢ SMALL OIL WELL | ⬢ ABANDONED OIL WELL |

NOTE: Below make tracing from map, (when no map is obtainable make sketch) showing farm, center of section, this location with measurements and also wells, dry holes, or other locations in the vicinity of this location. Make copy to keep for reference and send original to Chicago office.

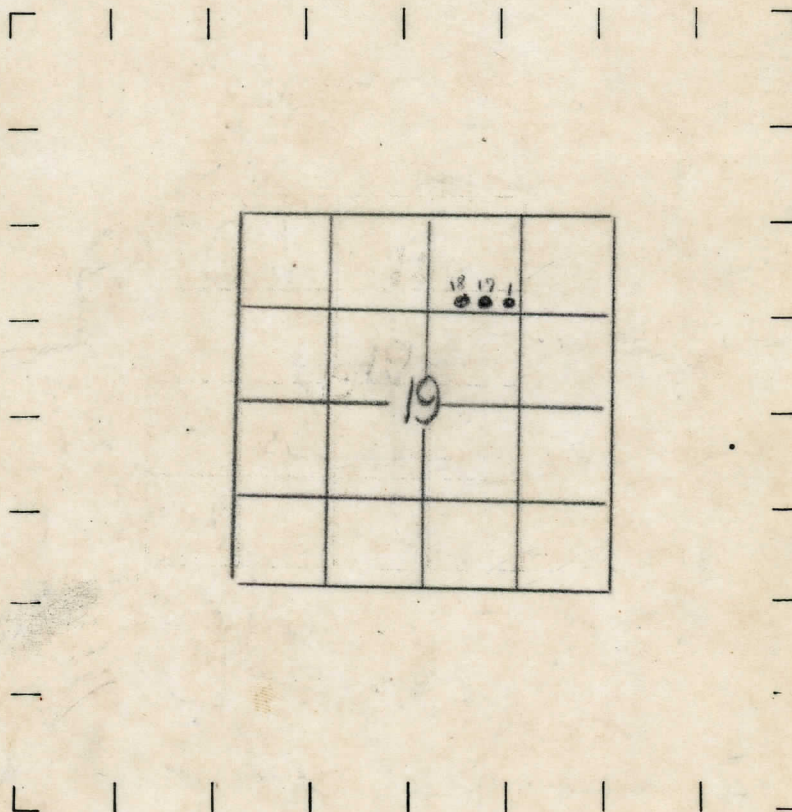

REMARKS:

SIGNED

Superintendent or Foreman.

— ОУДВАНГЕ

ACHES

ЪВЕС  
ЛАЪ

2EC

LOM

"KUNDE"

# COMPLETION RECORD

No. 12

DIST. Dundee  
TWP. ....  
PREC. ....

WELL No. 1 (SERIAL No. 19) Farm Cletus Duesco ACRES 96

NAME OF STREAM OR WATERS.....QUADRANGLE.....

OPERATOR Deerfield oil & Gas Co. MAP Stamp.

LOCATION REPORT SENT IN (DATE) March .24th 1928

WELL STARTED (DATE) 1937 WELL COMPLETED (DATE) 1937

## OIL WELL

### XXX GAS WELL

## DRY HOLE

## ABANDONED WELL

**CROSS OUT THREE OF THE ABOVE  
WELL RECORD**

DATE OF SHOT 1927 NUMBER OF QUARTS                     

1st 24 HOURS PRODUCTION				Well still pumping water		BARRELS OR FEET	
2nd	"	"	"			"	"
3rd	"	"	"			"	"
4th	"	"	"			"	"
5th	"	"	"			"	"

## SAND AND CASING

[illegible]

REMARKS	Unable to get record of this well, but pumper said that it was only pumping water and had been since he had taken charge.
---------	---

NOTE:—MAKE COPY TO KEEP FOR REFERENCE AND SEND ORIGINAL TO COLUMBUS OFFICE. LIST MATERIAL CHARGEABLE TO WELL ON OTHER SIDE.

**SIGNED**

SUPT. OR FOREMAN.