



Western Michigan University
ScholarWorks at WMU

Legacy Scout Tickets from Pure Oil Company

8-20-2021

MGRRE_PureOilScoutTickets_Bragg, LaMonte_1_na

MGRRE

Western Michigan University

Follow this and additional works at: <https://scholarworks.wmich.edu/pure>



Part of the Geology Commons

WMU ScholarWorks Citation

MGRRE, "MGRRE_PureOilScoutTickets_Bragg, LaMonte_1_na" (2021). *Legacy Scout Tickets from Pure Oil Company*. 6035.

<https://scholarworks.wmich.edu/pure/6035>

This Document is brought to you for free and open access via ScholarWorks at WMU. It has been accepted for inclusion in Legacy Scout Tickets from Pure Oil Company by an authorized administrator of ScholarWorks at WMU. See the National Digital Catalogue - Science Base Catalogue for more collections submitted by MGRRE.



MGRRE_PureOilScoutTickets_Bragg, LaMonte_1_na

API na

Permit Number na

Lease Name Bragg, LaMonte

Well Number 1

County Monroe

Township 06S

Range 06E

Section 30

2021 DEQ or Pure co_name James S. Brailey

Pure Number 36

Latitude 41.9300098

Longitude -83.7598857

THE PURE OIL COMPANY

Date 2-3-43 Corrected LOCATION REPORT A.F.E. No. _____

Division Mich. Producing District _____ Lease LaMonte Bragg, et ux

Acres _____ Lease No. _____ Elevation _____ Well No. 1 (Serial No. 36)











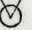

Quadrangle SE SW NW Sec. 30 Twp. 6 S Rge. 6 E ~~XBNX~~ ~~XDSX~~ Twp. Dundee

Survey _____ County Monroe State Michigan

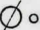
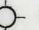
Operator James S. Brailey Map Dundee Township, Monroe County

____ Feet from North Line of Lease
____ " " East " " "
____ " " South " " "
____ " " West " " "
____ Feet from North Line of Section
____ " " East " " "
____ " " South " " "
____ " " West " " "

LEGEND

- Location
- | | |
|---|---|
|  Gas Well |  Dry Showing Gas |
|  Oil Well |  Abandoned Location |
|  Gas - Distillate Well |  or  Abandoned Gas Well |
|  or  Dry Hole |  or  Abandoned Oil Well |
|  Dry Showing Oil |  or  Input Well |

See plat - Serial No. Monroe 36.



Remarks: Change of operator. Scale _____

Submitted by J.S. - Scouting Dept. Approved by _____ Division Manager

~~Oil Engineer~~ Approved by _____ Vice-President - General Manager

Division Michigan Production District of Monroe Block 3 of 1X
Date 5-3-33 Collected LOCATION REPORT A.E.E. No.
DATE February 4, 1937 Corrected LOCATION REPORT No. 36
STATE Michigan COUNTY Monroe DIST. Dundee SEC. 30 TOWN 6S RANGE 6E
WELL No. 11 (SERIAL No. 336) FARM PREC. LaMonte Bragg 8-299

NAME OF STREAM OR WATERS QUADRANGLE SE-SW-NW.
OPERATOR A. V. Oil & Gas Company MAP Dundee Township, Monroe County
A.V. Oil & Gas Co. Dundee-Monroe

Feet from North Line of Farm

" " East " " "
" " South " " "
" " West " " "

Feet from North Line of Section

" " East " " "
" " South " " "
" " West " " "

24-506

- LEGEND
- | | |
|------------------|----------------------|
| ○ LOCATION | ⊕ DRY HOLE |
| ① RIG | ⊕ DRY SHOWING OIL |
| ⊕ DRILLING | ⊕ DRY SHOWING GAS |
| ⊕ GAS WELL | ⊕ ABANDONED LOCATION |
| ● OIL WELL | ⊕ ABANDONED GAS WELL |
| ⊕ SMALL OIL WELL | ⊕ ABANDONED OIL WELL |

NOTE: Below make tracing from map, (when no map is obtainable make sketch) showing farm, center of section, this location with measurements and also wells, dry holes, or other locations in the vicinity of this location. Make copy to keep for reference and send original to Columbus office.

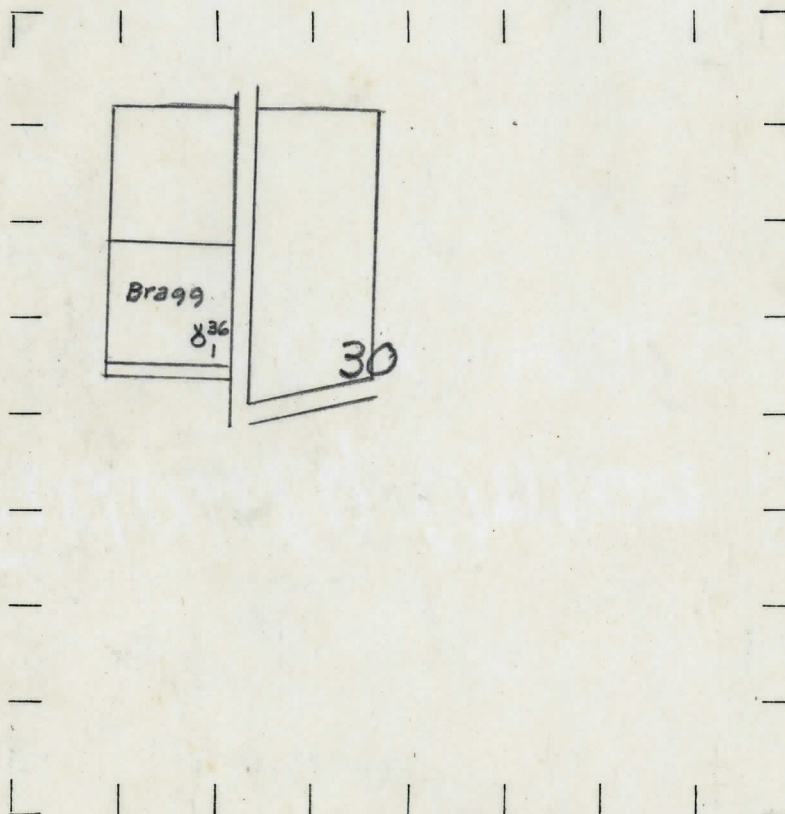

REMARKS:

SIGNED

R. L. Yeager.
Superintendent or Foreman.

DATE May 21, 1936 LOCATION REPORT No. 56
STATE Michigan COUNTY Monroe DIST. Dundee SEC. 30 TOWN 6 S RANGE 6 E
WELL No. 1 (SERIAL No. 36) FARM LaMonte Bragg et ux ACRES

NAME OF STREAM OR WATERS _____ QUADRANGLE SE SW NW
OPERATOR Charles M. Ross & John Vale Map Dundee Township, Monroe County
Chas M. Ross & John Vale Dundee - Monroe

Feet from North Line of Farm
225 225 " " East " " "
1595 1545 " " South " " "
" " West " " "
Feet from North Line of Section
" " East " " "
225 225 " " South " 1 1/4 "
1095 1095 " " West " " "

- LEGEND
- | | |
|------------------|----------------------|
| ○ LOCATION | ⊙ DRY HOLE |
| ① RIG | ⬤ DRY SHOWING OIL |
| ⊕ DRILLING | ⊙ DRY SHOWING GAS |
| ☼ GAS WELL | ⊙ ABANDONED LOCATION |
| ● OIL WELL | ☼ ABANDONED GAS WELL |
| ⬤ SMALL OIL WELL | ⬤ ABANDONED OIL WELL |

NOTE: Below make tracing from map, (when no map is obtainable make sketch) showing farm, center of section, this location with measurements and also wells, dry holes, or other locations in the vicinity of this location.

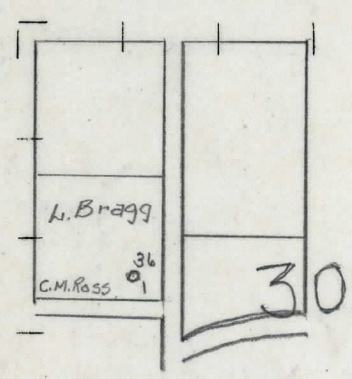

REMARKS: _____

SIGNED R. L. Yeager
Superintendent or Foreman.

