



Western Michigan University
ScholarWorks at WMU

Legacy Scout Tickets from Pure Oil Company

8-20-2021

MGRRE_PureOilScoutTickets_Clampitt,
James_1_21115050310000

MGRRE
Western Michigan University

Follow this and additional works at: <https://scholarworks.wmich.edu/pure>



Part of the Geology Commons

WMU ScholarWorks Citation

MGRRE, "MGRRE_PureOilScoutTickets_Clampitt, James_1_21115050310000" (2021). *Legacy Scout Tickets from Pure Oil Company*. 6044.
<https://scholarworks.wmich.edu/pure/6044>

This Document is brought to you for free and open access via ScholarWorks at WMU. It has been accepted for inclusion in Legacy Scout Tickets from Pure Oil Company by an authorized administrator of ScholarWorks at WMU. See the National Digital Catalogue - Science Base Catalogue for more collections submitted by MGRRE.



MGRRE_PureOilScoutTickets_Clampitt, James_1_21115050310000

API 21115050310000

Permit Number 5031

Lease Name Clampitt, James

Well Number 1

County Monroe

Township 08S

Range 06E

Section 28

2021 DEQ or Pure co_name Oryx Energy Company

Pure Number 45

Latitude 41.76

Longitude -83.7242

THE PURE OIL COMPANY

COMPLETION RECORD OF WELLS DRILLED BY OTHER OPERATORS

DATE May 19, 1938

LOCATION REPORT

No. 45

STATE Michigan COUNTY Monroe TWP Whiteford SEC. 28 TOWN 8 S RANGE 6 E

WELL No. 1 (SERIAL No. 45) FARM James Clampitt ACRES

NAME OF STREAM OR WATERS QUADRANGLE NW-NW-NW

OPERATOR Sun Oil Company Map Whiteford Township, Monroe County

33330 Feet from North Line of Farm

" " East " " "

" " South " " "

33330 " " West " " "

33330 Feet from North Line of Section

" " East " " "

" " South " " "

33330 " " West " " "

LEGEND

○ LOCATION

⊙ RIG

⊕ DRILLING

☼ GAS WELL

● OIL WELL

⦿ SMALL OIL WELL

⊖ DRY HOLE

⦿ DRY SHOWING OIL

⦿ DRY SHOWING GAS

⦿ ABANDONED LOCATION

⦿ ABANDONED GAS WELL

⦿ ABANDONED OIL WELL

NOTE: Below make tracing from map, (when no map is obtainable make sketch) showing farm, center of section, this location with measurements and also wells, dry holes, or other locations in the vicinity of this location.

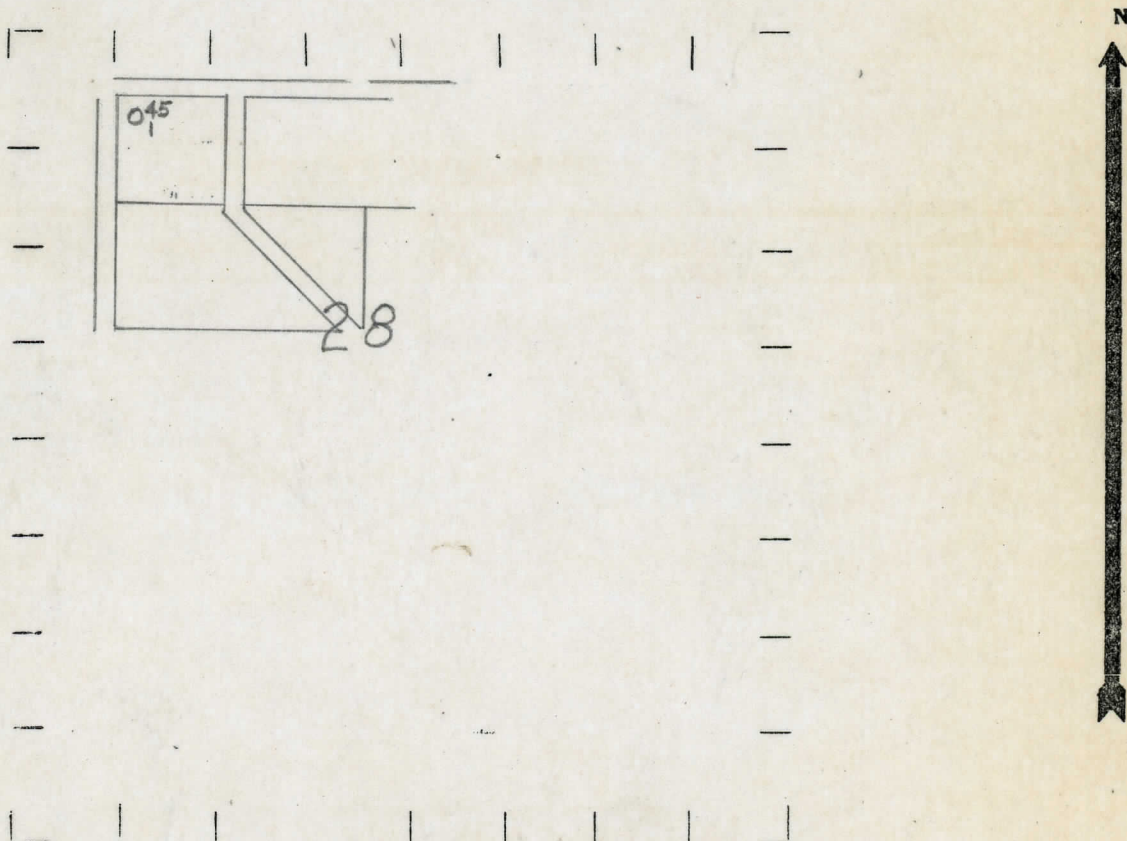

REMARKS:

SIGNED

R. L. Fagan

Superintendent or Foreman

