



Western Michigan University
ScholarWorks at WMU

Legacy Scout Tickets from Pure Oil Company

8-20-2021

MGRRE_PureOilScoutTickets_Beland, Elmer_1_21115071480000

MGRRE

Western Michigan University

Follow this and additional works at: <https://scholarworks.wmich.edu/pure>



Part of the Geology Commons

WMU ScholarWorks Citation

MGRRE, "MGRRE_PureOilScoutTickets_Beland, Elmer_1_21115071480000" (2021). *Legacy Scout Tickets from Pure Oil Company*. 6061.

<https://scholarworks.wmich.edu/pure/6061>

This Document is brought to you for free and open access via ScholarWorks at WMU. It has been accepted for inclusion in Legacy Scout Tickets from Pure Oil Company by an authorized administrator of ScholarWorks at WMU. See the National Digital Catalogue - Science Base Catalogue for more collections submitted by MGRRE.



MGRRE_PureOilScoutTickets_Beland, Elmer_1_21115071480000

API 21115071480000

Permit Number 7148

Lease Name Beland, Elmer

Well Number 1

County Monroe

Township 06S

Range 06E

Section 30

2021 DEQ or Pure co_name McPheron, M. R.

Pure Number 62

Latitude 41.93682

Longitude -83.75384

Form 24—WELL REPORT—OUTSIDE OPERATIONS.

SERIAL NO. 62STATE Michigan ~~PSH~~ Monroe CO.OPERATOR M. R. McPheronFARM Elmer Beland WELL NO. 1TWP. Dundee S. 30 T. 6S R. 6E
~~SURVEY~~LOC. NW NE NEWILDCAT ☐ FIELD ☐ FIELD NAME _____

MAP NO. _____ CO-ORD. _____ ELEV. _____

STATUS _____

Operator's name changed from:
James S. Brailey

NORTH

DATE 8-7-50 SCOUT H. J. G.

THE PURE OIL COMPANY

LOCATION REPORT

Date 2-3-43 Corrected A.F.E. No. _____

Division Mich. Producing District _____ Lease Elmer Beland

Acres _____ Lease No. _____ Elevation _____ Well No. 1 (Serial No. 62)

Quadrangle NW NE NE Sec. 30 Twp. 6 S Rge. 6 E ~~DEKX~~ ~~DEKX~~ Twp. Dundee

Survey _____ County Monroe State Michigan

Operator James S. Brailey Map Dundee Township, Monroe County

Feet from North Line of Lease

" " East " " "

" " South " " "

" " West " " "

Feet from North Line of Section

" " East " " "

" " South " " "

" " West " " "

LEGEND

○ Location

☀ Gas Well

● Oil Well

☀ Gas - Distillate Well

○ or ○ Dry Hole

● Dry Showing Oil

☀ Dry Showing Gas

⊗ Abandoned Location

☀ or ☀ Abandoned Gas Well

● or ● Abandoned Oil Well

⊗ or ⊗ Input Well

See plat - Serial No. Monroe 62.

N

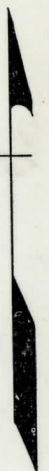

Scale _____

Remarks: Change of operator.

Submitted by J. S. - Scouting Dept. Civil Engineer

Approved by _____ Division Manager

Approved by _____ Vice-President - General Manager

Date 5-3-13 Collected LOCATION REPORT No. 62
DATE December 20, 1939 LOCATION REPORT
STATE Michigan COUNTY Monroe DIST. Dundee SEC. 30 TOWN 6 S RANGE 6 E
WELL No. 1 (SERIAL No. 62) FARM Elmer Beland ACRES

NAME OF STREAM OR WATERS _____ QUADRANGLE NW-NE-NE
OPERATOR A. V. Oil & Gas Company Map Dundee Township, Monroe County

2220 Feet from North Line of Farm
" " East " " "
" " South " " "
2220 " " West " " "
2220 Feet from North Line of Section
1/100 " " East " " "
" " South " " "
" " West " " "

- LEGEND
- | | |
|------------------|----------------------|
| ○ LOCATION | ⊙ DRY HOLE |
| ① RIG | ⊕ DRY SHOWING OIL |
| ⊕ DRILLING | ⊙ DRY SHOWING GAS |
| ⊗ GAS WELL | ⊗ ABANDONED LOCATION |
| ● OIL WELL | ⊗ ABANDONED GAS WELL |
| ⊕ SMALL OIL WELL | ⊗ ABANDONED OIL WELL |

NOTE: Below make tracing from map, (when no map is obtainable make sketch) showing farm, center of section, this location with measurements and also wells, dry holes, or other locations in the vicinity of this location.

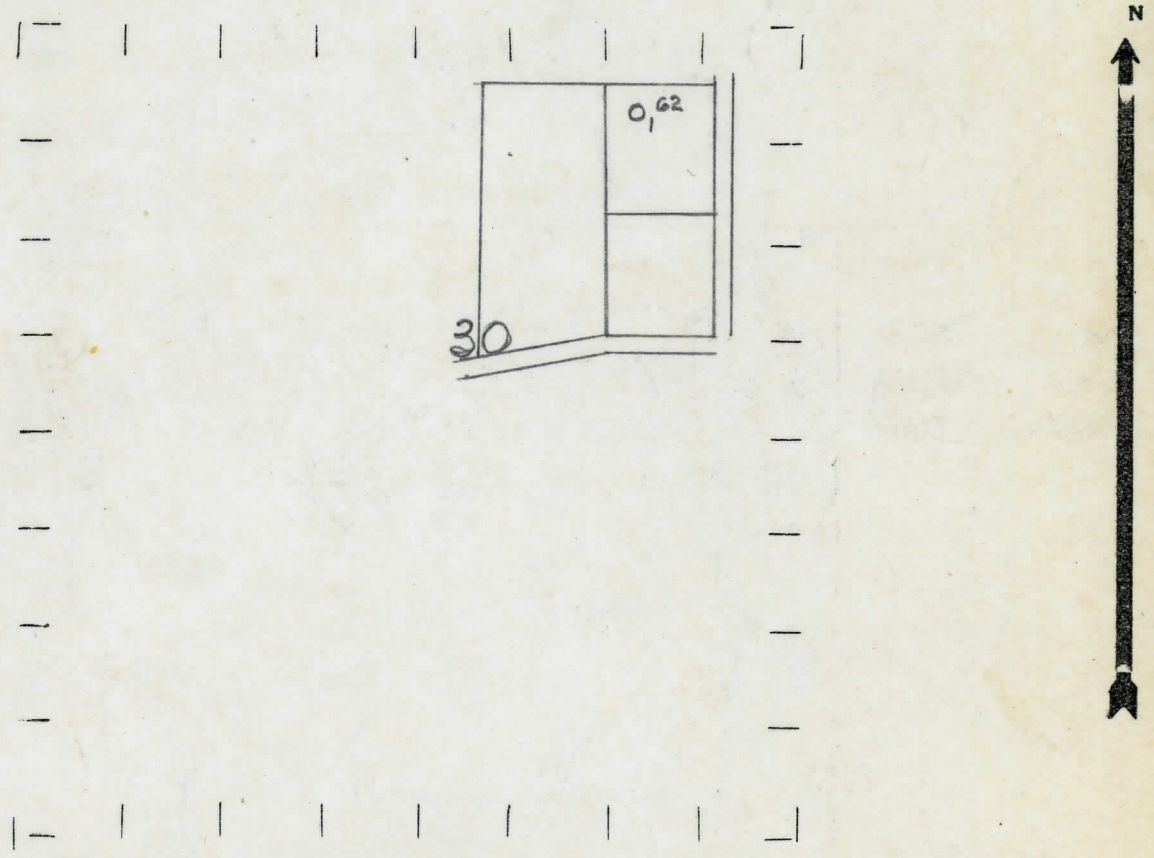

REMARKS:

SIGNED

Superintendent or Foreman.

Signed **D. C. Shackelford**