



Western Michigan University  
ScholarWorks at WMU

---

Legacy Scout Tickets from Pure Oil Company

---

8-20-2021

**MGRRE\_PureOilScoutTickets\_Rowe, Albert\_1\_21115071900000**

MGRRE

*Western Michigan University*

Follow this and additional works at: <https://scholarworks.wmich.edu/pure>



Part of the Geology Commons

---

#### WMU ScholarWorks Citation

MGRRE, "MGRRE\_PureOilScoutTickets\_Rowe, Albert\_1\_21115071900000" (2021). *Legacy Scout Tickets from Pure Oil Company*. 6064.

<https://scholarworks.wmich.edu/pure/6064>

This Document is brought to you for free and open access via ScholarWorks at WMU. It has been accepted for inclusion in Legacy Scout Tickets from Pure Oil Company by an authorized administrator of ScholarWorks at WMU. See the National Digital Catalogue - Science Base Catalogue for more collections submitted by MGRRE.



---

**MGRRE\_PureOilScoutTickets\_Rowe, Albert\_1\_21115071900000**

API 21115071900000

Permit Number 7190

Lease Name Rowe, Albert

Well Number 1

County Monroe

Township 06S

Range 06E

Section 30

2021 DEQ or Pure co\_name Simon, W. J.

Pure Number 65

Latitude 41.92567

Longitude -83.7507

## THE PURE OIL COMPANY

DATE December 28, 1939

## LOCATION REPORT

No. 65STATE MichiganCOUNTY MonroeDIST. DundeeTWP. DundeePREC. A. RoweSEC. 30TOWN 6 SRANGE 6 EWELL No. 1 (SERIAL No. 65) FARM

ACRES

NAME OF STREAM OR WATERS

QUADRANGLE NE SE SEOPERATOR Skinner & Shiffman

Map

Dundee Township, Monroe CountySkinner & ShiffmanDundee-Mon

Feet from North Line of Farm

3330

" " East " " "

9990

" " South " " "

" " West " " "

Feet from North Line of Section

3330

" " East " " "

9990

" " South " " "

" " West " " "

## LEGEND

○ LOCATION

⊕ RIG

⊕ DRILLING

☀ GAS WELL

● OIL WELL

● SMALL OIL WELL

⊙ DRY HOLE

⊙ DRY SHOWING OIL

⊙ DRY SHOWING GAS

⊙ ABANDONED LOCATION

☀ ABANDONED GAS WELL

● ABANDONED OIL WELL

NOTE: Below make tracing from map, (when no map is obtainable make sketch) showing farm, center of section, this location with measurements and also wells, dry holes, or other locations in the vicinity of this location.

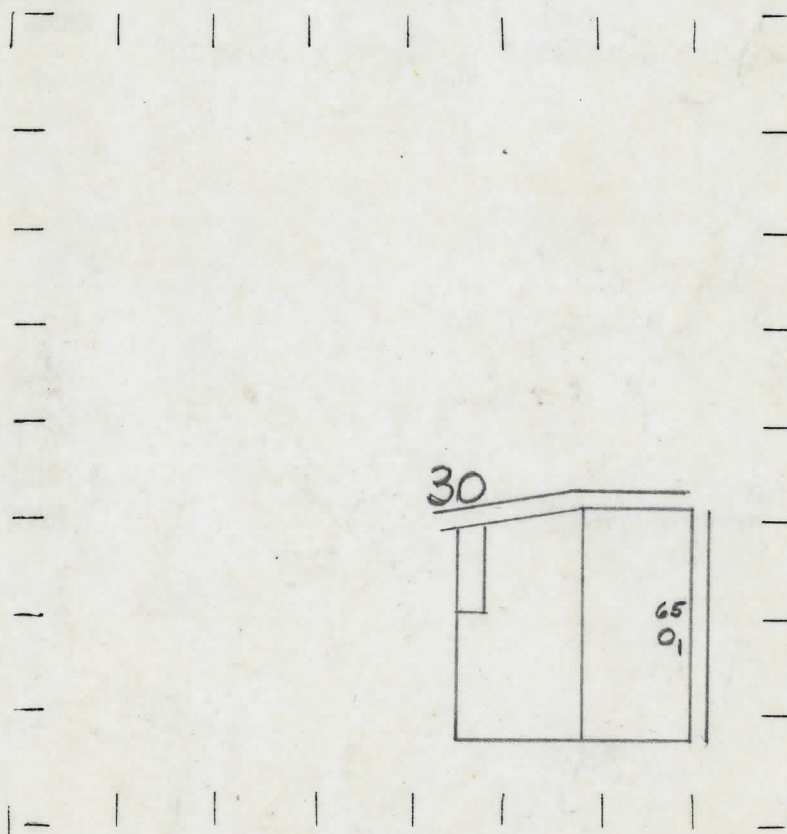

REMARKS:

SIGNED

Superintendent or Foreman.



Michigan Producing Division

Date April 3, 1940 No. 65  
State Mich. County Monroe Dist. ~~Monroe~~  
Twp. Dundee Sec. 30 Twp. 6 S Rge. 6 E  
(Serial No.)  
Well No. 1 (~~County~~ No.) 65 Farm Albert Rowe Acres  
By  
Operator B. J. Skinner & D. J. Shiffman Information secured from Scouting Department  
Date well started 2-3-40 Dated well completed 3-12-40 Elevation 678.1

# PRODUCTION RECORD

|   |   |
|---|---|
| 1st 24 hours natural                    | 100 Barrels (Swabbed)                       |
| 2nd 24 hours natural                    |   |
| Date of shot                            | No. of quarts From to From to               |
| Date of acid 3-22-40                    | No. of gallons 500                          |
| 1st 24 hours after acid <del>shot</del> | 100 Barrels (Flowed) Settled to 40 barrels. |
| 2nd 24 hours after acid                 |   |

## FORMATION AND CASING RECORD

[illegible][illegible]

Signed D. C. Shackelford