



Western Michigan University  
ScholarWorks at WMU

---

Legacy Scout Tickets from Pure Oil Company

---

8-20-2021

**MGRRE\_PureOilScoutTickets\_Brackett, Ellen\_1\_21115074710000**

MGRRE

*Western Michigan University*

Follow this and additional works at: <https://scholarworks.wmich.edu/pure>



Part of the Geology Commons

---

#### WMU ScholarWorks Citation

MGRRE, "MGRRE\_PureOilScoutTickets\_Brackett, Ellen\_1\_21115074710000" (2021). *Legacy Scout Tickets from Pure Oil Company*. 6073.

<https://scholarworks.wmich.edu/pure/6073>

This Document is brought to you for free and open access via ScholarWorks at WMU. It has been accepted for inclusion in Legacy Scout Tickets from Pure Oil Company by an authorized administrator of ScholarWorks at WMU. See the National Digital Catalogue - Science Base Catalogue for more collections submitted by MGRRE.



---

**MGRRE\_PureOilScoutTickets\_Brackett, Ellen\_1\_21115074710000**

API 21115074710000

Permit Number 7471

Lease Name Brackett, Ellen

Well Number 1

County Monroe

Township 07S

Range 06E

Section 4

2021 DEQ or Pure co\_name Harvey W. L

Pure Number 74

Latitude 41.90814

Longitude -83.72436

## THE PURE OIL COMPANY

DATE March 27, 1940

## LOCATION REPORT

No. 74

STATE Michigan COUNTY Monroe DIST. Summerfield TWP. Summerfield SEC. 4 TOWN 7 S RANGE 6 E  
 WELL No. 1 (SERIAL No. 74) FARM Ellen Brackett ACRES 6 E

NAME OF STREAM OR WATERS \_\_\_\_\_ QUADRANGLE NW NE NWOPERATOR W. L. Harvey Map Summerfield Township, Monroe County221 221 Feet from North Line of Farm

" " East " " "

" " South " " "

221 221 " " West " " "221 221 Feet from North Line of Section1099 1099 " " East " " "

" " South " " "

" " West " " "

## LEGEND

○ LOCATION

① RIG

⊕ DRILLING

☀ GAS WELL

● OIL WELL

● SMALL OIL WELL

⊖ DRY HOLE

⊖ DRY SHOWING OIL

⊖ DRY SHOWING GAS

⊖ ABANDONED LOCATION

⊖ ABANDONED GAS WELL

⊖ ABANDONED OIL WELL

NOTE: Below make tracing from map, (when no map is obtainable make sketch) showing farm, center of section, this location with measurements and also wells, dry holes, or other locations in the vicinity of this location.

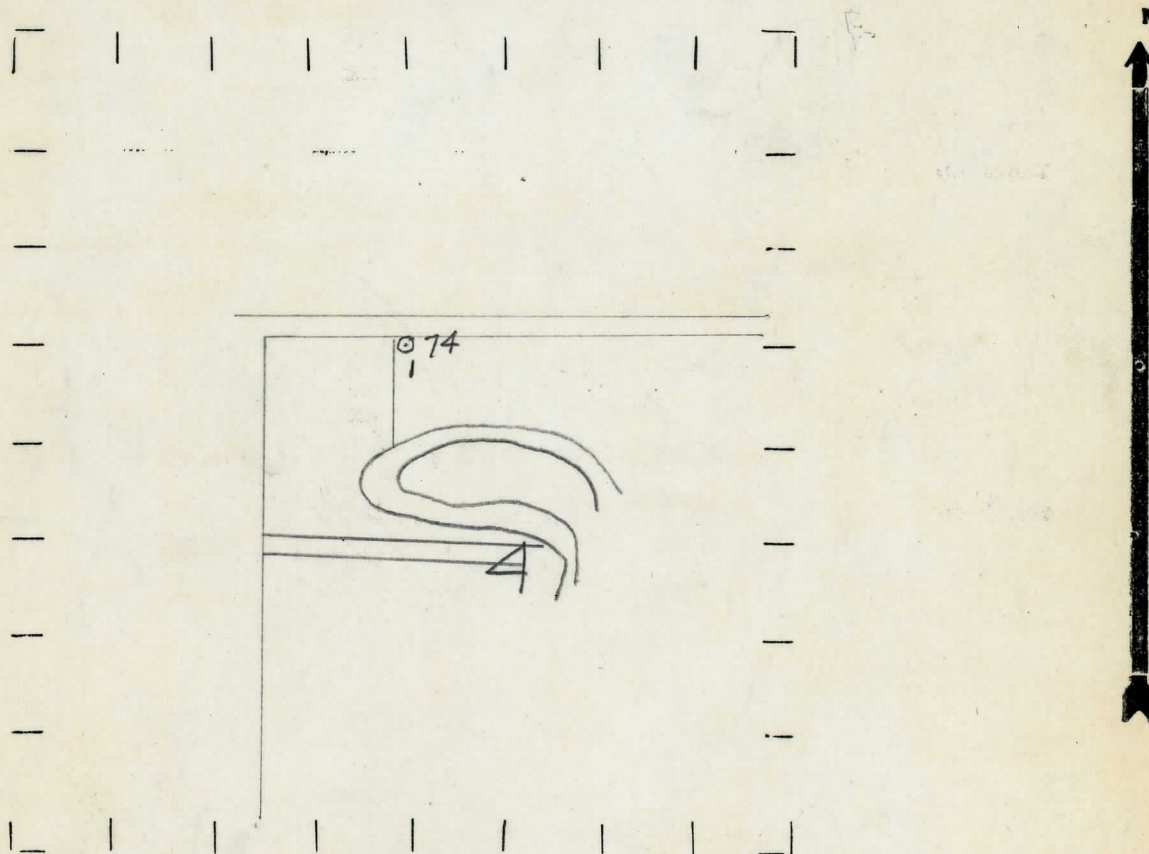

REMARKS:

SIGNED

W

Superintendent or Foreman.



Michigan Producing Division

# PRODUCTION RECORD

## FORMATION AND CASING RECORD

Remarks Water at 80' and show gas at 785'.

Signed D. C. Shackelford