



Western Michigan University  
ScholarWorks at WMU

---

Legacy Scout Tickets from Pure Oil Company

---

8-20-2021

**MGRRE\_PureOilScoutTickets\_Rowe, Mynee\_1\_21115075310000**

MGRRE

*Western Michigan University*

Follow this and additional works at: <https://scholarworks.wmich.edu/pure>



Part of the Geology Commons

---

#### WMU ScholarWorks Citation

MGRRE, "MGRRE\_PureOilScoutTickets\_Rowe, Mynee\_1\_21115075310000" (2021). *Legacy Scout Tickets from Pure Oil Company*. 6075.

<https://scholarworks.wmich.edu/pure/6075>

This Document is brought to you for free and open access via ScholarWorks at WMU. It has been accepted for inclusion in Legacy Scout Tickets from Pure Oil Company by an authorized administrator of ScholarWorks at WMU. See the National Digital Catalogue - Science Base Catalogue for more collections submitted by MGRRE.



---

**MGRRE\_PureOilScoutTickets\_Rowe, Mynee\_1\_21115075310000**

API 21115075310000

Permit Number 7531

Lease Name Rowe, Mynee

Well Number 1

County Monroe

Township 06S

Range 06E

Section 30

2021 DEQ or Pure co\_name Fisher McCall Oil and Gas, Incorporated

Pure Number 76

Latitude 41.92564

Longitude -83.75312

THE PURE OIL COMPANY  
THE PURE OIL COMPANY

Date March 24, 1943 Corrected LOCATION REPORT A.F.E. No. \_\_\_\_\_  
 Division Mich. Producing District \_\_\_\_\_ Lease M. Rowe  
 Acres \_\_\_\_\_ Lease No. \_\_\_\_\_ Elevation \_\_\_\_\_ Well No. 1 (Serial No. 76)  
 Quadrangle NW SE SE Sec. 30 Twp. 6 S Rge. 6 E Twp. Dundee  
 Survey \_\_\_\_\_ County Monroe State Michigan  
 Operator Fisher-McCall Oil & Gas, Inc. Map Dundee Township, Monroe County

Feet from North Line of Lease

" " East " " "

" " South " " "

" " West " " "

Feet from North Line of Section

" " East " " "

" " South " " "

" " West " " "

## LEGEND

○ Location



Gas Well



Dry Showing Gas



Oil Well



Abandoned Location



Gas - Distillate Well



Abandoned Gas Well

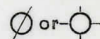

Dry Hole



Abandoned Oil Well



Dry Showing Oil



Input Well

See plat - Monroe #76.

Remarks: Change of operator. Scale \_\_\_\_\_Submitted by Scouting Dept. - J.S. Approved by \_\_\_\_\_ Division Manager

Approved by \_\_\_\_\_ Vice-President - General Manager

Division Michigan District No. 10  
Date March 31, 1913 Collected LOCATION REPORT A.E.E. No.  
DATE March 31, 1913 LOCATION REPORT No. 10  
STATE Michigan COUNTY Monroe DIST. Dundee SEC. 30 TOWN 6 S RANGE 6 E  
WELL No. 1 (SERIAL No. 76) FARM Myer Rowe Rowe ACRES

NAME OF STREAM OR WATERS QUADRANGLE NW SE SE  
OPERATOR Alcoba Oil Company Map Dundee Township, Monroe County  
Alcoba Oil Co. Dundee - Monroe

Feet from North Line of Farm  
330 330 " " East " " "  
990 990 " " South " " "  
330 330 " " West " " "

Feet from North Line of Section  
990 990 " " East " 1/4 "  
990 990 " " South " " "  
330 " " West " " "

#### LEGEND

- |                  |                      |
|------------------|----------------------|
| ○ LOCATION       | ⊙ DRY HOLE           |
| ⊕ RIG            | ⊙ DRY SHOWING OIL    |
| ⊕ DRILLING       | ⊙ DRY SHOWING GAS    |
| ☀ GAS WELL       | ⊙ ABANDONED LOCATION |
| ● OIL WELL       | ☀ ABANDONED GAS WELL |
| ⬮ SMALL OIL WELL | ● ABANDONED OIL WELL |

NOTE: Below make tracing from map, (when no map is obtainable make sketch) showing farm, center of section, this location with measurements and also wells, dry holes, or other locations in the vicinity of this location.

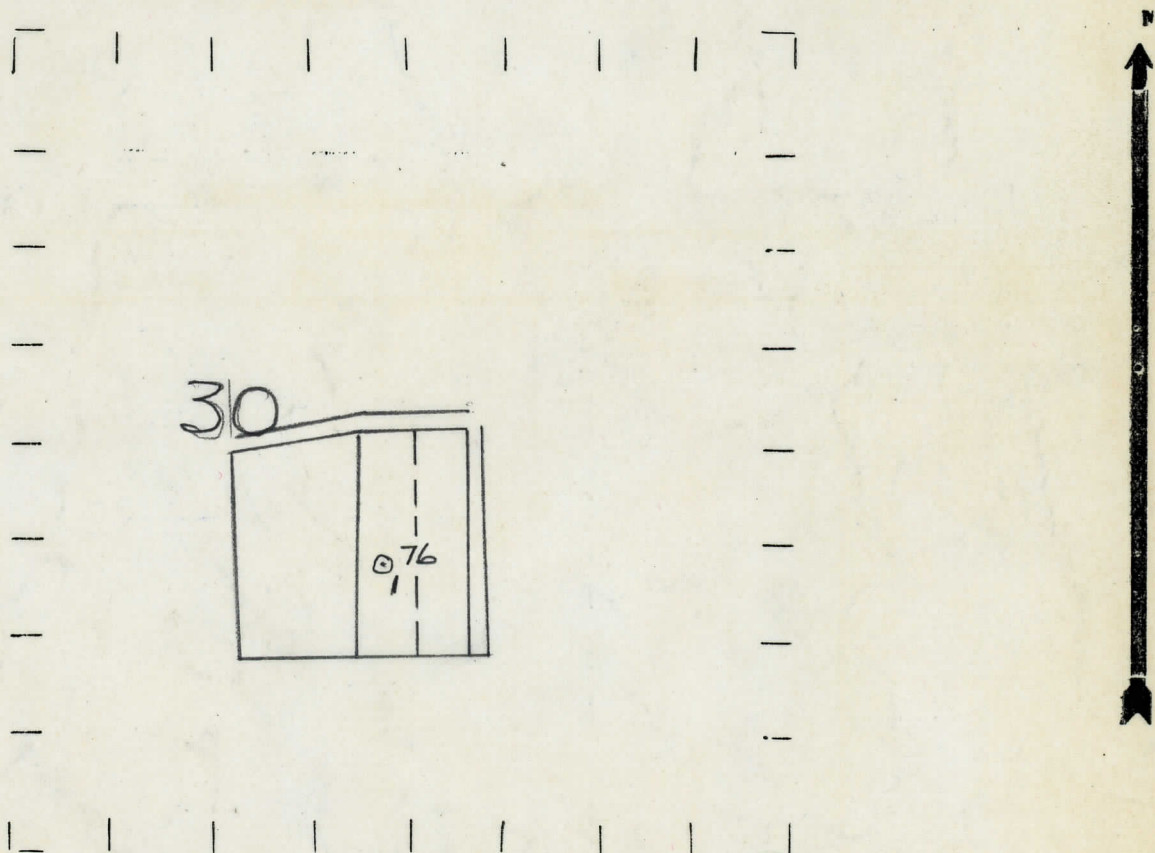

REMARKS:

SIGNED

W

Superintendent or Foreman.



Date August 7, 1940

No. 76

State Mich. County Monroe Twp. Dundee Sec. 30 Twp. 6 S Rge. 6 E

(Serial No.)

Well No. 1 (County No. 76) Farm Mynce Rowe Acres

Operator Alcoba Oil Company Information secured <sup>By</sup> ~~from~~ Scouting Department

Date well started 4-27-40 Dated well completed 6-15-40 Elevation 676.5

# PRODUCTION RECORD

	Dry Hole
1st 24 hours natural	

2nd 24 hours natural

Date of shot	No. of quarts	From	to	From	to
6-17-40	180				

Date of acid	No. of gallons
--------------	----------------

shot  
1st 24 hours after ~~acid~~ No results.

shot  
2nd 24 hours after acid

# FORMATION AND CASING RECORD

[illegible]

Remarks Show gas at 505'.

Signed

D. C. Shackelford