



Western Michigan University
ScholarWorks at WMU

Legacy Scout Tickets from Pure Oil Company

8-20-2021

MGRRE_PureOilScoutTickets_Hagen, Carl_1_21115077660000

MGRRE

Western Michigan University

Follow this and additional works at: <https://scholarworks.wmich.edu/pure>



Part of the Geology Commons

WMU ScholarWorks Citation

MGRRE, "MGRRE_PureOilScoutTickets_Hagen, Carl_1_21115077660000" (2021). *Legacy Scout Tickets from Pure Oil Company*. 6084.

<https://scholarworks.wmich.edu/pure/6084>

This Document is brought to you for free and open access via ScholarWorks at WMU. It has been accepted for inclusion in Legacy Scout Tickets from Pure Oil Company by an authorized administrator of ScholarWorks at WMU. See the National Digital Catalogue - Science Base Catalogue for more collections submitted by MGRRE.



MGRRE_PureOilScoutTickets_Hagen, Carl_1_21115077660000

API 21115077660000

Permit Number 7766

Lease Name Hagen, Carl

Well Number 1

County Monroe

Township 06S

Range 06E

Section 29

2021 DEQ or Pure co_name Jetter Drilling Company

Pure Number 86

Latitude 41.92413

Longitude -83.7311

DATE June 19, 1940 COMPLETION RECORD OF LOCATION REPORT OTHER OPERATORS

No. 86

STATE Michigan COUNTY Monroe DIST. Dundee TWP. Dundee SEC. 29 TOWN 6S RANGE 6E

WELL No. 1 (SERIAL No. 86) FARM Carl Hagen Hagen ACRES

NAME OF STREAM OR WATERS QUADRANGLE SE-SE-SE-SE

OPERATOR Jetter Drilling Company Map Dundee Township, Monroe County
Jetter Drilg Co. Dundee Monroe

Feet from North Line of Farm

330 330 " " East " " "

330 330 " " South " " "

" " West " " "

Feet from North Line of Section

330 330 " " East " 1/4 "

330 330 " " South " " "

" " West " " "

LEGEND

- LOCATION
- ① RIG
- ⊕ DRILLING
- ☀ GAS WELL
- OIL WELL
- ◆ SMALL OIL WELL
- ⊙ DRY HOLE
- ◆ DRY SHOWING OIL
- ☀ DRY SHOWING GAS
- ⊙ ABANDONED LOCATION
- ☀ ABANDONED GAS WELL
- ABANDONED OIL WELL

NOTE: Below make tracing from map, (when no map is obtainable make sketch) showing farm, center of section, this location with measurements and also wells, dry holes, or other locations in the vicinity of this location.

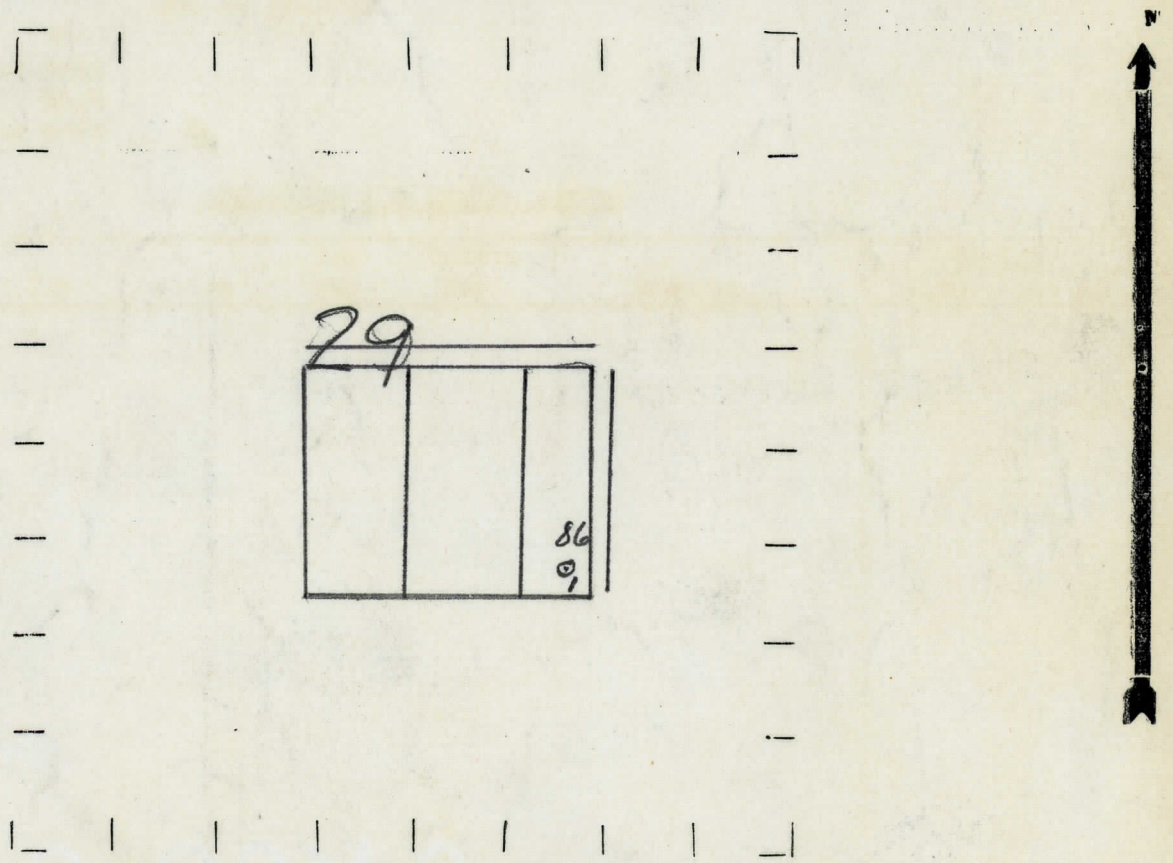

REMARKS:

SIGNED

W
Superintendent or Foreman.

