



Western Michigan University  
ScholarWorks at WMU

---

Legacy Scout Tickets from Pure Oil Company

---

8-20-2021

**MGRRE\_PureOilScoutTickets\_Plotner, Orville  
W.\_1\_21115079360000**

MGRRE  
*Western Michigan University*

Follow this and additional works at: <https://scholarworks.wmich.edu/pure>



Part of the Geology Commons

---

#### **WMU ScholarWorks Citation**

MGRRE, "MGRRE\_PureOilScoutTickets\_Plotner, Orville W.\_1\_21115079360000" (2021). *Legacy Scout Tickets from Pure Oil Company*. 6086.  
<https://scholarworks.wmich.edu/pure/6086>

This Document is brought to you for free and open access via ScholarWorks at WMU. It has been accepted for inclusion in Legacy Scout Tickets from Pure Oil Company by an authorized administrator of ScholarWorks at WMU. See the National Digital Catalogue - Science Base Catalogue for more collections submitted by MGRRE.



---

**MGRRE\_PureOilScoutTickets\_Plotner, Orville W.\_1\_21115079360000**

API 21115079360000

Permit Number 7936

Lease Name Plotner, Orville W.

Well Number 1

County Monroe

Township 06S

Range 06E

Section 31

2021 DEQ or Pure co\_name Cook, Regis P.

Pure Number 88

Latitude 41.92225

Longitude -83.75828

DATE August 28, 1940

Corrected

## LOCATION REPORT

No. 88STATE MichiganCOUNTY MonroeMonroe

RIST

TWP

PREC

SummerfieldSEC. 31TOWN 6 SRANGE 6 E6 EWELL No. 1 (SERIAL No. 88) FARM Plotner

ACRES

NAME OF STREAM OR WATERS

QUADRANGLE NE NE NE-NEOPERATOR Regis CookMap Summerfield Township, Monroe County220 220 Regis Cook Feet from North Line of Farm220 220 " " East " " "

" " South " " "

" " West " " "

220 220 Feet from North Line of Section220 220 " " East " " "

" " South " " "

" " West " " "

## LEGEND

○ LOCATION

① RIG

⊕ DRILLING

☼ GAS WELL

● OIL WELL

● SMALL OIL WELL

⊙ DRY HOLE

● DRY SHOWING OIL

⊙ DRY SHOWING GAS

⊙ ABANDONED LOCATION

☼ ABANDONED GAS WELL

● ABANDONED OIL WELL

NOTE: Below make tracing from map, (when no map is obtainable make sketch) showing farm, center of section, this location with measurements and also wells, dry holes, or other locations in the vicinity of this location.

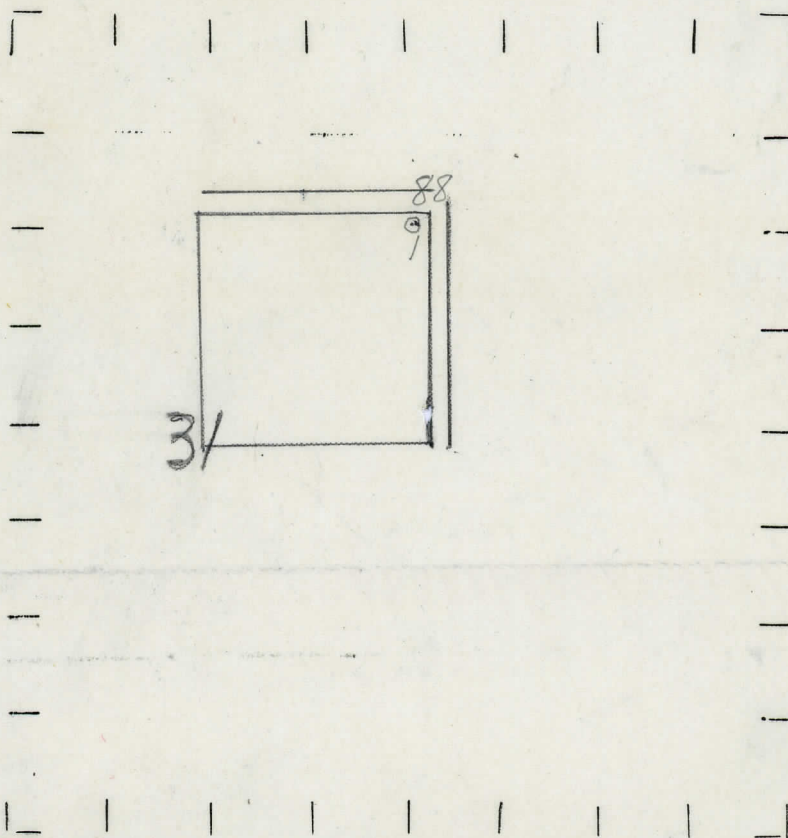
REMARKS: Correcting location

SIGNED

Superintendent or Foreman.



OBSERVATOR Regis Cook Map Summerfield Township, Monroe County  
 NAME OF STREAM OR WATERS \_\_\_\_\_ QUADRANGLE NW NW NE  
 WELL No. 1 (SERIAL No. 88) FARM Orville W. Plotner ACRES \_\_\_\_\_  
 OPERATOR Regis Cook Map Summerfield Township, Monroe County

Regis Cook  
 Feet from North Line of Farm  
 " " East " " "  
220 220 " " South " " "  
220 220 " " West " " "  
440 440 Feet from North Line of Section 1/4 1/4  
 " " East " " "  
 " " South " " "  
220 220 " " West " " "

- LEGEND
- LOCATION
  - ① RIG
  - ⊕ DRILLING
  - ☀ GAS WELL
  - OIL WELL
  - SMALL OIL WELL
  - ⊙ DRY HOLE
  - ◆ DRY SHOWING OIL
  - ⊙ DRY SHOWING GAS
  - ⊙ ABANDONED LOCATION
  - ☀ ABANDONED GAS WELL
  - ABANDONED OIL WELL

NOTE: Below make tracing from map. (when no map is obtainable make sketch) showing farm, center of section, this location with measurements and also wells, dry holes, or other locations in the vicinity of this location.

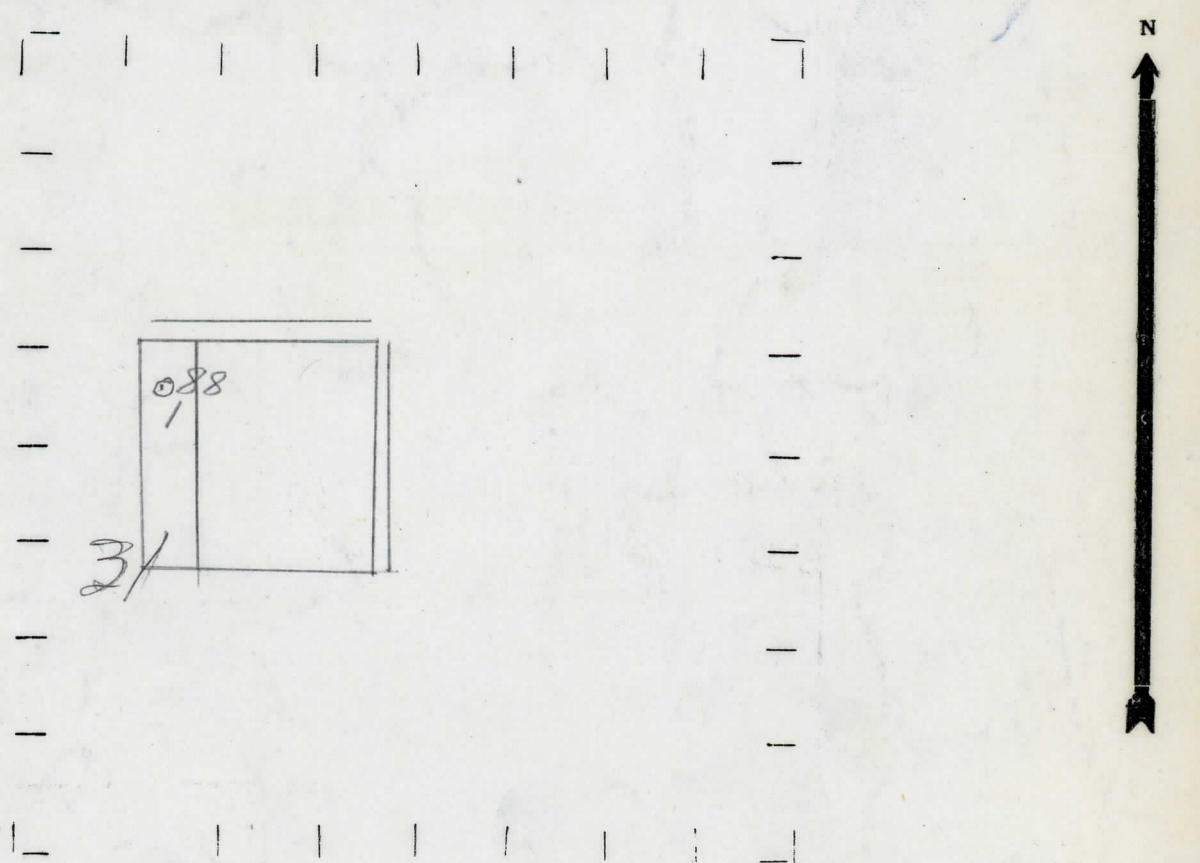

REMARKS:

---



---



---

SIGNED W  
 Subertintendent or Foreman.



OBEYALON **Regis Cook** MFB Summerfield Township, Monroe County  
 Date \_\_\_\_\_  
 State **Mich.** County **Monroe** Twp. **Summerfield** Sec. **31** Twp. **6 S** Rge. **6 E**  
 (Serial No.)  
 Well No. **1** (County No.) **83** Farm **Orville W. Plotner** Acres \_\_\_\_\_  
 Operator **Regis Cook** By \_\_\_\_\_ Information secured from **Scouting Department**  
 Date well started **9-20-40** Date well completed **7-27-41** Elevation **680.4**

1st 24 hours natural.....Temporarily abandoned.

2nd 24 hours natural.....

8-2-41  
6-28-41

No. of 300  
100

Date of shot..... From ..... to ..... From ..... to .....

Date of acid..... No. of gallons .....

shot

1st 24 hours after ~~acid~~..... No results.

shot

2nd 24 hours after acid.....

[illegible]

Signed ..... **D. C. Shackelford**