



Western Michigan University
ScholarWorks at WMU

Legacy Scout Tickets from Pure Oil Company

8-20-2021

MGRRE_PureOilScoutTickets_Cain_1_21115072110000

MGRRE

Western Michigan University

Follow this and additional works at: <https://scholarworks.wmich.edu/pure>



Part of the Geology Commons

WMU ScholarWorks Citation

MGRRE, "MGRRE_PureOilScoutTickets_Cain_1_21115072110000" (2021). *Legacy Scout Tickets from Pure Oil Company*. 6088.

<https://scholarworks.wmich.edu/pure/6088>

This Document is brought to you for free and open access via ScholarWorks at WMU. It has been accepted for inclusion in Legacy Scout Tickets from Pure Oil Company by an authorized administrator of ScholarWorks at WMU. See the National Digital Catalogue - Science Base Catalogue for more collections submitted by MGRRE.



MGRRE_PureOilScoutTickets_Cain_1_21115072110000

API 21115072110000

Permit Number 7211

Lease Name Cain

Well Number 1

County Monroe

Township 06S

Range 06E

Section 31

2021 DEQ or Pure co_name Powell, Otto H. and Gilbreath, F. E.

Pure Number 90

Latitude 41.91483

Longitude -83.76318

DATE September 11, 1940

LOCATION REPORT

No. 90

STATE Michigan COUNTY Monroe DIST. Summerfield TWP. Summerfield SEC. 31 TOWN 6S RANGE 6E
 WELL No. 1 (SERIAL No. 90) FARM Cain ACRES

NAME OF STREAM OR WATERS

QUADRANGLE NW-NE-SWOPERATOR Otto H. Powell & F. E. Gilbreath

Map

Summerfield Township, Monroe County

330 330 Feet from North Line of Farm

" " East " " "

" " South " " "

330 330 " " West " " "

330 330 Feet from North Line of Section 1/4/4

1170 1170 " " East " " "

" " South " " "

" " West " " "

LEGEND

○ LOCATION

⊕ RIG

⊕ DRILLING

⊗ GAS WELL

● OIL WELL

● SMALL OIL WELL

⊖ DRY HOLE

⊖ DRY SHOWING OIL

⊖ DRY SHOWING GAS

⊖ ABANDONED LOCATION

⊖ ABANDONED GAS WELL

⊖ ABANDONED OIL WELL

NOTE: Below make tracing from map. (when no map is obtainable make sketch) showing farm, center of section, this location with measurements and also wells, dry holes, or other locations in the vicinity of this location.

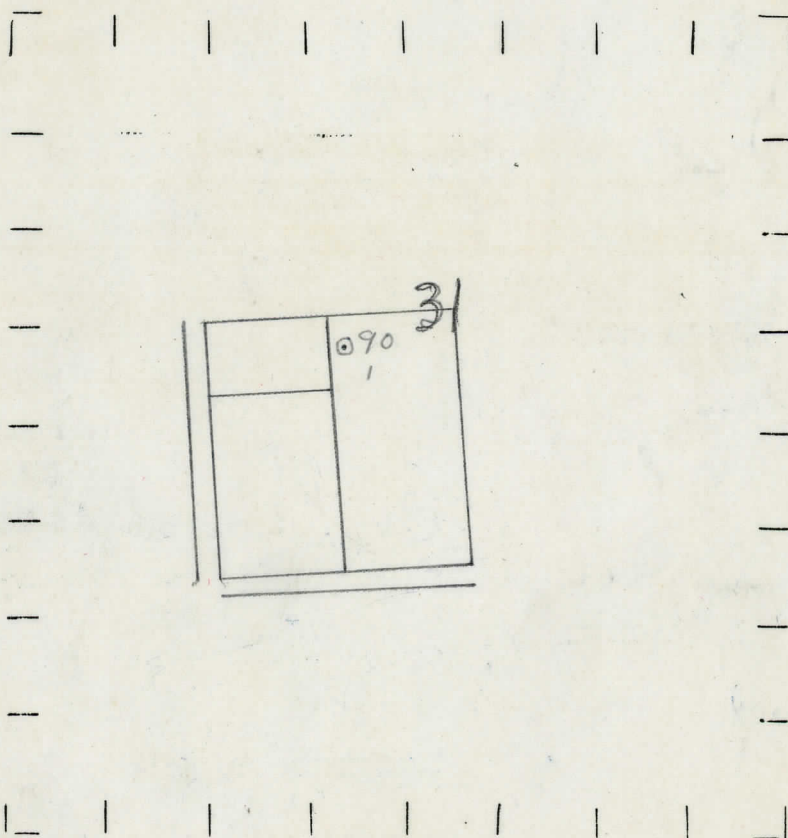

REMARKS:

SIGNED

W
 Superintendent or Foreman.

Michigan Producing

Date _____ No. _____

State November 6, 1940 Dist. _____

County _____ Twp. _____

(Serial No.) _____ Sec. _____ Twp. _____ Rge. 90

Well No. Mich. (County No.) Monroe Farm Summerfield 31 6S 6E

Acres _____

Operator 1 XXXXXXXXXX 90 Cain By _____

Information secured from _____

Date well O.E. Powell & F.E. Gilbreath well completed XXXX Scouting Dept.

Elevation _____

9-16-40 10-30-40 6777

PRODUCTION RECORD

1st 24 hours natural

2nd 24 hours natural **Dry Hole**

Date of shot No. of quarts From to From to

Date of acid No. of gallons

shot

1st 24 hours after acid

shot

2nd 24 hours after acid

FORMATION AND CASING RECORD

Formation	Top	Bottom	Top Pay	Bottom Pay	Remarks	Casing	
						Size	Set at
					Water at 85'	8-1/4"	60'
Sylvania	185	265				6-5/8"	1458'
Niagaran	1050						
Clinton	1220						
Trenton	2034 S.L.M.						
Total Depth		2151			No Water		

Remarks

2062 CTM - 2046 SLM

Signed