



Western Michigan University  
ScholarWorks at WMU

---

Legacy Scout Tickets from Pure Oil Company

---

8-20-2021

**MGRRE\_PureOilScoutTickets\_Bragg,  
Lamonte\_B-1\_21115080800000**

MGRRE  
*Western Michigan University*

Follow this and additional works at: <https://scholarworks.wmich.edu/pure>



Part of the Geology Commons

---

#### WMU ScholarWorks Citation

MGRRE, "MGRRE\_PureOilScoutTickets\_Bragg, Lamonte\_B-1\_21115080800000" (2021). *Legacy Scout Tickets from Pure Oil Company*. 6091.  
<https://scholarworks.wmich.edu/pure/6091>

This Document is brought to you for free and open access via ScholarWorks at WMU. It has been accepted for inclusion in Legacy Scout Tickets from Pure Oil Company by an authorized administrator of ScholarWorks at WMU. See the National Digital Catalogue - Science Base Catalogue for more collections submitted by MGRRE.



---

**MGRRE\_PureOilScoutTickets\_Bragg, Lamonte\_B-1\_21115080800000**

API 21115080800000

Permit Number 8080

Lease Name Bragg, Lamonte

Well Number B-1

County Monroe

Township 06S

Range 06E

Section 30

2021 DEQ or Pure co\_name Austin, Harry

Pure Number 93

Latitude 41.92815

Longitude -83.76584

# THE PURE OIL COMPANY

## LOCATION REPORT

Date November 11, 1944

A.F.E. No. \_\_\_\_\_

Division Mich. Producing

District \_\_\_\_\_

Lease LaMonte Bragg

Acres \_\_\_\_\_

Lease No. \_\_\_\_\_

Elevation \_\_\_\_\_

Well No. B-1 (Serial No. 93)Quadrangle SE NW SWSec. 30Twp. 6 SRge. 6 E~~Box~~  
~~Dist~~  
Twp.Dundee

Survey \_\_\_\_\_

County MonroeState MichiganOperator Harry AustinMap Dundee Township, Monroe County

Feet from North Line of Lease

" " East " " "

" " South " " "

" " West " " "

Feet from North Line of Section

" " East " " "

" " South " " "

" " West " " "

## LEGEND

○ Location



Gas Well



Oil Well



Gas - Distillate Well



Dry Hole



Dry Showing Oil



Dry Showing Gas



Abandoned Location

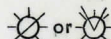

Abandoned Gas Well



Abandoned Oil Well

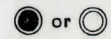

Input Well

Plugged and abandoned 9-21-44.

Total Depth 2150'.

N

Scale \_\_\_\_\_

Remarks: \_\_\_\_\_

Submitted by \_\_\_\_\_

Civil Engineer

Approved by \_\_\_\_\_

Division Manager

Approved by \_\_\_\_\_

Vice-President - General Manager

Division Mich. Producing District Monroe Lease LaMonte Bragg

Date June 4, 1942 Corrected LOCATION REPORT W.L.E. No. \_\_\_\_\_ A.F.E. No. \_\_\_\_\_

Division Mich. Producing District \_\_\_\_\_ Lease LaMonte Bragg

Acres \_\_\_\_\_ Lease No. \_\_\_\_\_ Elevation \_\_\_\_\_ Well No. B-1 (Serial No. 93)

Quadrangle SE NW SW Sec. 30 Twp. 6 S Rge. 6 E Dundee

Survey \_\_\_\_\_ County Monroe State Michigan

Operator Harry Austin Map Dundee Township, Monroe County

Feet from North Line of Lease  
" " East " " "  
" " South " " "  
" " West " " "  
Feet from North Line of Section  
" " East " " "  
" " South " " "  
" " West " " "

LEGEND

Gas Well	Location	Dry Showing Gas
Oil Well		Abandoned Location
Gas - Distillate Well	or	Abandoned Gas Well
or  Dry Hole	or	Abandoned Oil Well
Dry Showing Oil	or	Input Well

See plat - Serial No. Monroe 93.

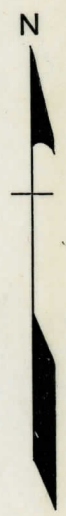

Remarks: Change of operator. Scale \_\_\_\_\_

Submitted by Scouting Dept.-J.S. ~~Oil Engineer~~ Approved by \_\_\_\_\_ Division Manager

Approved by \_\_\_\_\_ Vice-President - General Manager



Superintendent or Foreman.



NAME OF ALLEYS OR LOTS  
 WELL No. 8-1 (SERIAL No. 93) FARM LaMonte Bragg  
 STATE Michigan COUNTY Monroe DIST. Dundee SEC. 30 TOWN 6 S RANGE 6 E  
 WELL No. B-1 (SERIAL No. 93) FARM LaMonte Bragg ACRES SE-NW-SW  
 NAME OF STREAM OR WATERS \_\_\_\_\_ QUADRANGLE SE NW SW

OPERATOR Consolidated Developers Map Dundee Township, Monroe County  
Consolidated Developers Dundee - Monroe

220 220 Feet from North Line of Farm  
 295 295 " " East " " "  
 " " South " " "  
 " " West " " "  
 Feet from North Line of Section  
 1980 1980 " " East " " "  
 " " South " 1/4/4 "  
 1025 1025 " " West " " "

225  
 Sp 10-3-40  
 85/8 81

- LEGEND**
- LOCATION
  - ⊕ RIG
  - ⊕ DRILLING
  - ☀ GAS WELL
  - OIL WELL
  - ◆ SMALL OIL WELL
  - ⊙ DRY HOLE
  - ◆ DRY SHOWING OIL
  - ⊙ DRY SHOWING GAS
  - ⊙ ABANDONED LOCATION
  - ☀ ABANDONED GAS WELL
  - ABANDONED OIL WELL

NOTE: Below make tracing from map. (when no map is obtainable make sketch) showing farm, center of section, this location with measurements and also wells, dry holes, or other locations in the vicinity of this location.

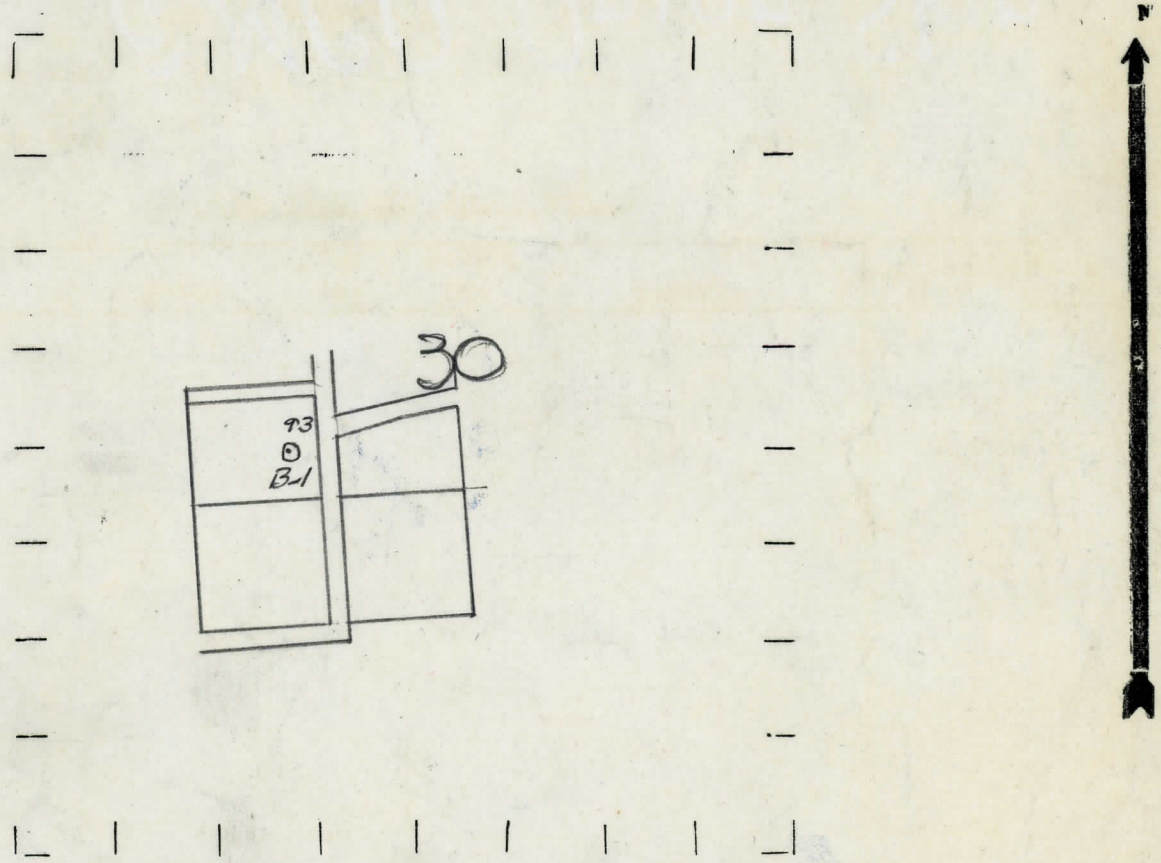

REMARKS:

SIGNED W  
 Superintendent or Foreman.



Division

No. 93

**Dist**

Twp.

## Dundee

Sec.

Twp.

Rge. 6

Farm

LaMonte Bragg

...Acres

By

Date well started 10-3-40      Dated well completed 11-22-40      Elevation 676.0

## 16

1st ~~24~~ hours natural 2 Bailleurs Oil.

2nd 24 hours natural

Date of shot	No. of quarts	From	to	From	to
11-25-40	80				

Date of acid	No. of gallons
1900	100
1901	100
1902	100
1903	100
1904	100
1905	100
1906	100
1907	100
1908	100
1909	100
1910	100
1911	100
1912	100
1913	100
1914	100
1915	100
1916	100
1917	100
1918	100
1919	100
1920	100
1921	100
1922	100
1923	100
1924	100
1925	100
1926	100
1927	100
1928	100
1929	100
1930	100
1931	100
1932	100
1933	100
1934	100
1935	100
1936	100
1937	100
1938	100
1939	100
1940	100
1941	100
1942	100
1943	100
1944	100
1945	100
1946	100
1947	100
1948	100
1949	100
1950	100
1951	100
1952	100
1953	100
1954	100
1955	100
1956	100
1957	100
1958	100
1959	100
1960	100
1961	100
1962	100
1963	100
1964	100
1965	100
1966	100
1967	100
1968	100
1969	100
1970	100
1971	100
1972	100
1973	100
1974	100
1975	100
1976	100
1977	100
1978	100
1979	100
1980	100
1981	100
1982	100
1983	100
1984	100
1985	100
1986	100
1987	100
1988	100
1989	100
1990	100
1991	100
1992	100
1993	100
1994	100
1995	100
1996	100
1997	100
1998	100
1999	100
2000	100
2001	100
2002	100
2003	100
2004	100
2005	100
2006	100
2007	100
2008	100
2009	100
2010	100
2011	100
2012	100
2013	100
2014	100
2015	100
2016	100
2017	100
2018	100
2019	100
2020	100
2021	100
2022	100
2023	100
2024	100
2025	100
2026	100
2027	100
2028	100
2029	100
2030	100
2031	100
2032	100
2033	100
2034	100
2035	100
2036	100
2037	100
2038	100
2039	100
2040	100
2041	100
2042	100
2043	100
2044	100
2045	100
2046	100
2047	100
2048	100
2049	100
2050	100
2051	100
2052	100
2053	100
2054	100
2055	100

shot  
1st 24 hours after ~~1000~~ 20 Barrels (Pumped)

shot  
2nd 24 hours after acid

# FORMATION AND CASING RECORD

[illegible]

Remarks

Signed **D. C. Shackelford**