



Western Michigan University  
ScholarWorks at WMU

---

Legacy Scout Tickets from Pure Oil Company

---

8-20-2021

**MGRRE\_PureOilScoutTickets\_Heirs, John  
Delaney\_1\_21115085260000**

MGRRE  
*Western Michigan University*

Follow this and additional works at: <https://scholarworks.wmich.edu/pure>



Part of the Geology Commons

---

#### WMU ScholarWorks Citation

MGRRE, "MGRRE\_PureOilScoutTickets\_Heirs, John Delaney\_1\_21115085260000" (2021). *Legacy Scout Tickets from Pure Oil Company*. 6093.  
<https://scholarworks.wmich.edu/pure/6093>

This Document is brought to you for free and open access via ScholarWorks at WMU. It has been accepted for inclusion in Legacy Scout Tickets from Pure Oil Company by an authorized administrator of ScholarWorks at WMU. See the National Digital Catalogue - Science Base Catalogue for more collections submitted by MGRRE.



---

MGRRE\_PureOilScoutTickets\_Heirs, John Delaney\_1\_21115085260000

API 21115085260000

Permit Number 8526

Lease Name Heirs, John Delaney

Well Number 1

County Monroe

Township 06S

Range 06E

Section 30

2021 DEQ or Pure co\_name McEvoy, Henry L.

Pure Number 95

Latitude 41.92587

Longitude -83.75838

THE PURE OIL COMPANY

LOCATION REPORT

DATE April 9, 1941

No. 95

STATE Michigan COUNTY Monroe TWP Dundee SEC 30 TOWN 6S RANGE 6E  
WELL No. 1/ (SERIAL No. 95) FARM John Delaney Heirs ACRES

NAME OF STREAM OR WATERS QUADRANGLE NW SW SE

OPERATOR Henry L. McEvoy Map Dundee Township, Monroe County

220 220 Feet from North Line of Farm

" " East " " "

" " South " " "

220 220 " " West " " "

Feet from North Line of Section

" " East " " "

1100 1100 " " South " 1/4 "

220 220 " " West " " "

Dundee - Monroe

LEGEND

○ LOCATION

⊕ RIG

⊕ DRILLING

⊕ GAS WELL

● OIL WELL

⬮ SMALL OIL WELL

⬮ DRY HOLE

⬮ DRY SHOWING OIL

⬮ DRY SHOWING GAS

⬮ ABANDONED LOCATION

⬮ ABANDONED GAS WELL

⬮ ABANDONED OIL WELL

NOTE: Below make tracing from map, (when no map is obtainable make sketch) showing farm, center of section, this location with measurements and also wells, dry holes, or other locations in the vicinity of this location.

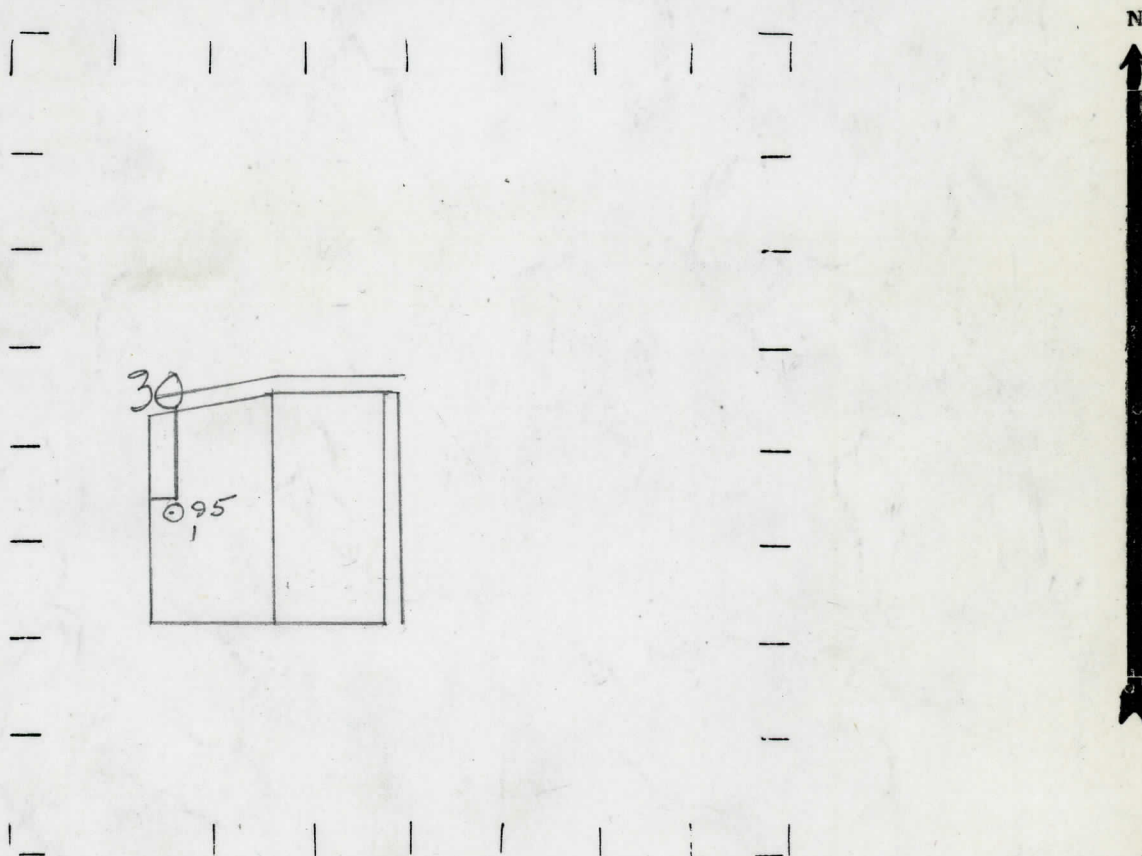

REMARKS:

SIGNED

Superintendent or Foreman.



Signed D. C. Shackelford