



Western Michigan University  
ScholarWorks at WMU

---

Legacy Scout Tickets from Pure Oil Company

---

8-20-2021

**MGRRE\_PureOilScoutTickets\_Duval, Amelia\_2\_21115085370000**

MGRRE

*Western Michigan University*

Follow this and additional works at: <https://scholarworks.wmich.edu/pure>



Part of the Geology Commons

---

#### WMU ScholarWorks Citation

MGRRE, "MGRRE\_PureOilScoutTickets\_Duval, Amelia\_2\_21115085370000" (2021). *Legacy Scout Tickets from Pure Oil Company*. 6094.

<https://scholarworks.wmich.edu/pure/6094>

This Document is brought to you for free and open access via ScholarWorks at WMU. It has been accepted for inclusion in Legacy Scout Tickets from Pure Oil Company by an authorized administrator of ScholarWorks at WMU. See the National Digital Catalogue - Science Base Catalogue for more collections submitted by MGRRE.



---

**MGRRE\_PureOilScoutTickets\_Duval, Amelia\_2\_21115085370000**

API 21115085370000

Permit Number 8537

Lease Name Duval, Amelia

Well Number 2

County Monroe

Township 06S

Range 06E

Section 31

2021 DEQ or Pure co\_name Douglass, Fred M.

Pure Number 96

Latitude 41.9207436

Longitude -83.7657402

THE PURE OIL COMPANY

LOCATION REPORT

DATE April 16, 1941

No. 96

STATE Michigan

COUNTY

Monroe

DIST

Summerfield

SEC

31

TOWN

48

RANGE

6 E

WELL No. 22

(SERIAL No. 96)

FARM

PREC

Amelia Duval

ACRES

NAME OF STREAM OR WATERS

QUADRANGLE

SE NW NW

OPERATOR Fred M. Douglass

Map

Summerfield Township, Monroe County

Feet from North Line of Farm

Low

Summerfield - Monroe

LEGEND

○ LOCATION

① RIG

⊕ DRILLING

☀ GAS WELL

● OIL WELL

● SMALL OIL WELL

⊙ DRY HOLE

⊙ DRY SHOWING OIL

⊙ DRY SHOWING GAS

⊙ ABANDONED LOCATION

⊙ ABANDONED GAS WELL

⊙ ABANDONED OIL WELL

220 220

1252 1252

743 743

Feet from North Line of Section

1/4 1/4

East

South

West

NOTE: Below make tracing from map, (when no map is obtainable make sketch) showing farm, center of section, this location with measurements and also wells, dry holes, or other locations in the vicinity of this location.

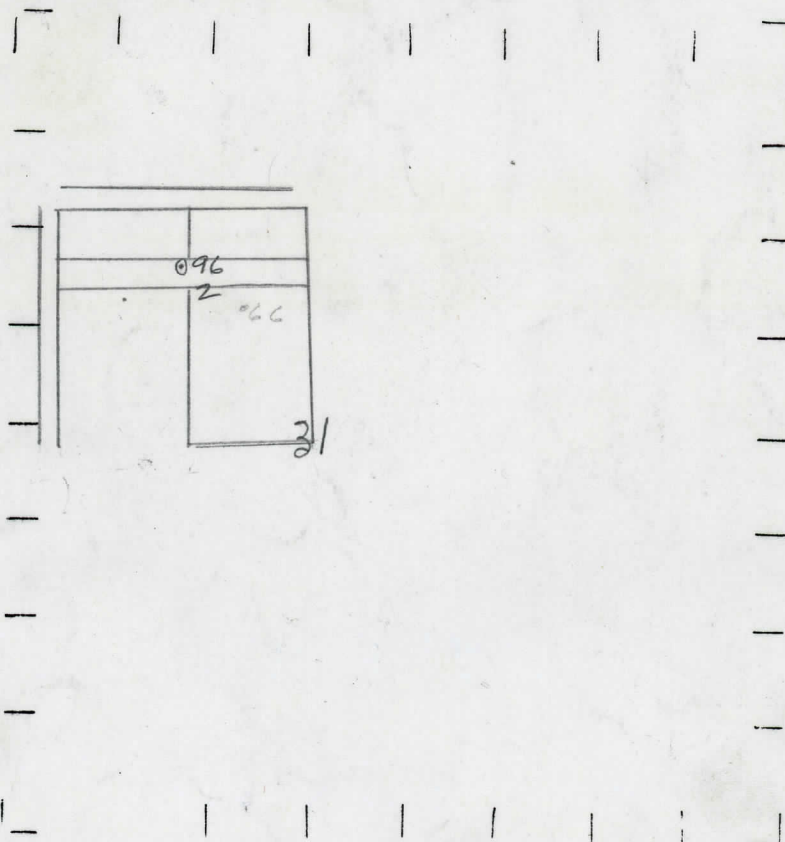

REMARKS:

SIGNED

Superintendent or Foreman.







No. 96

Well No. 2 (Serial No.) 96 Farm Amelia Duval Acres .....  
(County No.)

Operator **Fred M. Douglass** Information secured <sup>By</sup> ~~from~~ **Scouting Department**

Date well started \_\_\_\_\_ Date well completed **6-15-42** Elevation **674.1**

1st 24 hours natural	Dry Hole
----------------------	----------

2nd 24 hours natural

[illegible]

Date of acid **6-19-42** No. of gallons **1500**

1st 24 hours after acid ~~shock~~ No results.

2nd 24 hours after acid shot

# FORMATION AND CASING RECORD

[illegible]

Remarks Deepened from its old total depth of 2174' - additional information to our former Completion Report.

Signed D. C. Shackelford