



Western Michigan University
ScholarWorks at WMU

Legacy Scout Tickets from Pure Oil Company

8-20-2021

**MGRRE_PureOilScoutTickets_Bragg,
Ebenezer_2_21115088470000**

MGRRE
Western Michigan University

Follow this and additional works at: <https://scholarworks.wmich.edu/pure>



Part of the Geology Commons

WMU ScholarWorks Citation

MGRRE, "MGRRE_PureOilScoutTickets_Bragg, Ebenezer_2_21115088470000" (2021). *Legacy Scout Tickets from Pure Oil Company*. 6098.
<https://scholarworks.wmich.edu/pure/6098>

This Document is brought to you for free and open access via ScholarWorks at WMU. It has been accepted for inclusion in Legacy Scout Tickets from Pure Oil Company by an authorized administrator of ScholarWorks at WMU. See the National Digital Catalogue - Science Base Catalogue for more collections submitted by MGRRE.



MGRRE_PureOilScoutTickets_Bragg, Ebenezer_2_21115088470000

API 21115088470000

Permit Number 8847

Lease Name Bragg, Ebenezer

Well Number 2

County Monroe

Township 06S

Range 06E

Section 29

2021 DEQ or Pure co_name Skinner, B. J. and Shiffman, D. J.

Pure Number 100

Latitude 41.9257

Longitude -83.74827

THE PURE OIL COMPANY

DATE August 13, 1941

LOCATION REPORT

No. 100

STATE Michigan COUNTY Monroe DIST Dundee TWP Dundee SEC 29 TOWN 6 S RANGE 6 E
 WELL No. 2 (SERIAL No. 100) FARM Ebenezer Bragg ACRES

NAME OF STREAM OR WATERS _____ QUADRANGLE NW SW SW

OPERATOR B. J. Skinner and D. J. Shiffman Map Dundee Township, Monroe County
B. J. Skinner & D. J. Shiffman Dundee - Monroe
 Feet from North Line of Farm

“ “ East “ “ “
 990 990 “ “ South “ “ “
 330 330 “ “ West “ “ “
 Feet from North Line of Section

“ “ East “ “ “
 990 990 “ “ South “ “ 1/4
 330 330 “ “ West “ “ “

○ LOCATION

⊙ RIG

⊕ DRILLING

☼ GAS WELL

● OIL WELL

● SMALL OIL WELL

LEGEND

⊖ DRY HOLE

◆ DRY SHOWING OIL

⊖ DRY SHOWING GAS

⊖ ABANDONED LOCATION

☼ ABANDONED GAS WELL

● ABANDONED OIL WELL

NOTE: Below make tracing from map. (when no map is obtainable make sketch) showing farm, center of section, this location with measurements and also wells, dry holes, or other locations in the vicinity of this location.

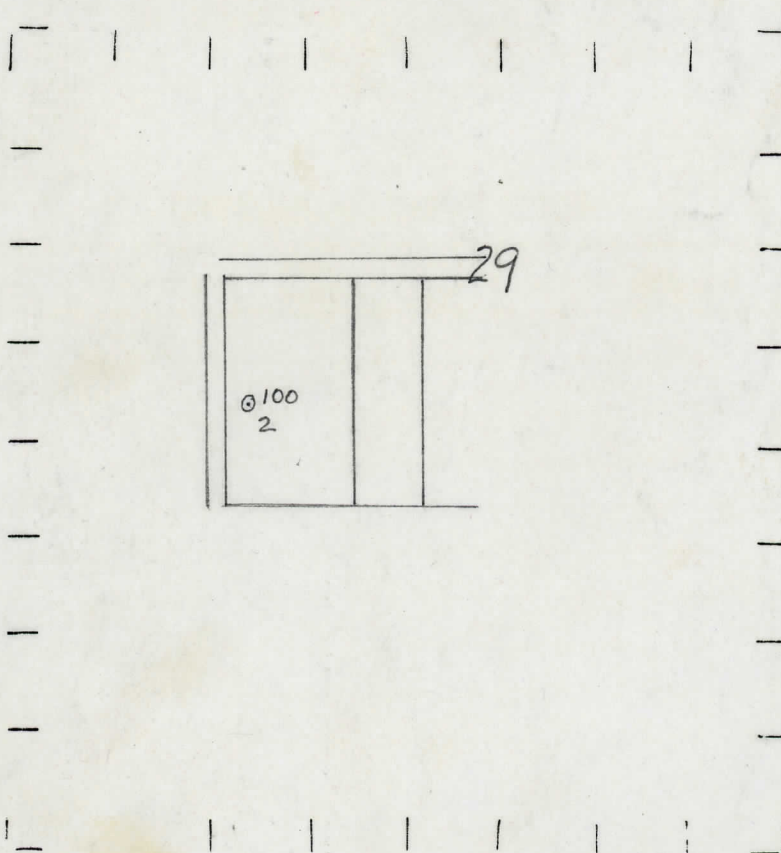

REMARKS:

SIGNED

W
 Superintendent or Foreman.

Signed..... **D. C. Shackelford**

RECEIVED DIRECTOR OF ARMY AIR FORCE STAFF OFFICE

Michigan Producing Division

Date May 19, 1943 No. 100
State Mich. County Monroe ~~Dundee~~ Dundee Twp. Sec. 29 Twp. 6 S Rge. 6 E
(Serial No.)
Well No. 2 (~~County No.~~) 100 Farm Ebenezer Bragg Acres
By
Operator B. J. Skinner-D. J. Shiffman Information secured ~~from~~ Scouting Department
Deepening
Date well started 8-5-41 Date well completed 5-3-43 Elevation 674.9

PRODUCTION RECORD

Dry Hole

1st 24 hours natural.....

2nd 24 hours natural.....

Date of shot..... No. of quarts **200** From..... to..... From..... to.....

Date of acid..... No. of gallons.....

1st 24 hours after acid..... shot.....

2nd 24 hours after acid..... shot.....

FORMATION AND CASING RECORD

[illegible]

Remarks Deepened from its old total depth of 2154' with no results - additional information to our former Completion Report.

Signed D. C. Shackelford