



Western Michigan University  
ScholarWorks at WMU

---

Legacy Scout Tickets from Pure Oil Company

---

8-20-2021

**MGRRE\_PureOilScoutTickets\_Elconin, D. V.\_1\_2111511180000**

MGRRE

*Western Michigan University*

Follow this and additional works at: <https://scholarworks.wmich.edu/pure>



Part of the Geology Commons

---

#### **WMU ScholarWorks Citation**

MGRRE, "MGRRE\_PureOilScoutTickets\_Elconin, D. V.\_1\_2111511180000" (2021). *Legacy Scout Tickets from Pure Oil Company*. 6101.

<https://scholarworks.wmich.edu/pure/6101>

This Document is brought to you for free and open access via ScholarWorks at WMU. It has been accepted for inclusion in Legacy Scout Tickets from Pure Oil Company by an authorized administrator of ScholarWorks at WMU. See the National Digital Catalogue - Science Base Catalogue for more collections submitted by MGRRE.



---

**MGRRE\_PureOilScoutTickets\_Elconin, D. V.\_1\_21115111800000**

API 21115111800000

Permit Number 11180

Lease Name Elconin, D. V.

Well Number 1

County Monroe

Township 06S

Range 09E

Section 1

2021 DEQ or Pure co\_name Morriss, William J.

Pure Number 103

Latitude 41.9967

Longitude -83.31762

WELL REPORT - OUTSIDE OPERATIONS

SERIAL NO. 103

STATE Michigan BSM CO. Monroe

OPERATOR William J. Morriss

FARM D.V. Elconin WELL NO. 1

TWP. Berlin S. 1 T. 6S R. 9E

LOC. NE SW SW

WILDCAT  FIELD  FIELD NAME

MAP NO. CO-ORD. ELEV.

STATUS

Operator's name corrected from; Francis T. Canon

NORTH

DATE 4-19-54 SCOUT JEC

THE PURE OIL COMPANY  
 LOCATION REPORT

Date November 1, 1944 A.F.E. No. \_\_\_\_\_  
 Division Mich. Producing District \_\_\_\_\_ Lease D. V. Elconin  
D. V. Elconin  
 Acres \_\_\_\_\_ Lease No. \_\_\_\_\_ Elevation \_\_\_\_\_ Well No. 1 (Serial No. 103)  
 Quadrangle NE-SW-SW Sec. 1 Twp. 6 S Rge. 9 E ~~SW~~ Berlin  
NE SW SW 1 6 S 9 E ~~RISK~~ Berlin  
 Survey \_\_\_\_\_ County Monroe State Michigan  
 Operator F. T. Canon Map Berlin Twp. - Monroe Co.  
F. T. Canon Berlin Township, Monroe County

		Feet from North Line of Lease			
<u>1180</u>	<u>1180</u>	" "	East	" "	" "
<u>856</u>	<u>856</u>	" "	South	" "	" "
		" "	West	" "	" "
		Feet from North Line of Section			
<u>1180</u>	<u>1180</u>	" "	East	" "	" "
<u>856</u>	<u>856</u>	" "	South	" "	<u>1/4</u>
		" "	West	" "	" "

LEGEND

- Location
- ☀ Gas Well
- Oil Well
- ☀ Gas - Distillate Well
- ∅ or ○ Dry Hole
- Dry Showing Oil
- ☀ Dry Showing Gas
- ⊗ Abandoned Location
- ☀ or ☀ Abandoned Gas Well
- or ● Abandoned Oil Well
- or ○ Input Well

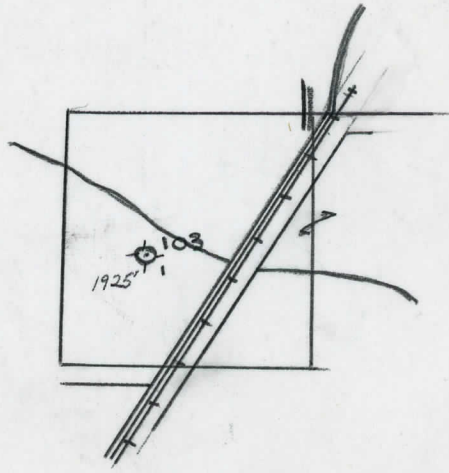

Remarks: \_\_\_\_\_  
 \_\_\_\_\_  
 \_\_\_\_\_

Submitted by RN Civil Engineer Approved by \_\_\_\_\_ Division Manager  
 Approved by \_\_\_\_\_ Vice-President - General Manager