



Western Michigan University
ScholarWorks at WMU

Legacy Scout Tickets from Pure Oil Company

8-20-2021

MGRRE_PureOilScoutTickets_Martens, E._1_21117108250000

MGRRE

Western Michigan University

Follow this and additional works at: <https://scholarworks.wmich.edu/pure>



Part of the Geology Commons

WMU ScholarWorks Citation

MGRRE, "MGRRE_PureOilScoutTickets_Martens, E._1_21117108250000" (2021). *Legacy Scout Tickets from Pure Oil Company*. 6750.

<https://scholarworks.wmich.edu/pure/6750>

This Document is brought to you for free and open access via ScholarWorks at WMU. It has been accepted for inclusion in Legacy Scout Tickets from Pure Oil Company by an authorized administrator of ScholarWorks at WMU. See the National Digital Catalogue - Science Base Catalogue for more collections submitted by MGRRE.



MGRRE_PureOilScoutTickets_Martens, E._1_21117108250000

API 21117108250000

Permit Number 10825

Lease Name Martens, E.

Well Number 1

County Montcalm

Township 10N

Range 08W

Section 11

2021 DEQ or Pure co_name McClure Drilling Company The

Pure Number 665

Latitude 43.2782

Longitude -85.23107

THE PURE OIL COMPANY

Date March 15, 1946 Corrected LOCATION REPORT A.F.E. No. _____

Division Mich. Producing District _____ Lease E. Martens

Acres _____ Lease No. _____ Elevation _____ Well No. 1 (Serial No. 665)

Quadrangle NW NW NW Sec. 11 Twp. 10 N Rge. 8 W Twp. Montcalm

Survey _____ County Montcalm State Michigan

Operator The McClure Drilling Company Map Montcalm Township, Montcalm County

Feet from North Line of Lease
 " " East " " "
 " " South " " "
 " " West " " "
 Feet from North Line of Section
 " " East " " "
 " " South " " "
 " " West " " "

LEGEND

○ Location

☼ Gas Well

● Oil Well

☼ Gas - Distillate Well

☼ or ○ Dry Hole

● Dry Showing Oil

☼ Dry Showing Gas

⊖ Abandoned Location

☼ or ☼ Abandoned Gas Well

● or ● Abandoned Oil Well

⊖ or ⊖ Input Well

See plat - Montcalm #665.

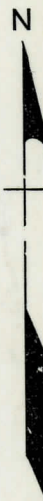

Remarks: Change of operator. Scale _____

Submitted by Scouting Dept. Approved by _____ Division Manager

Approved by _____ Vice-President - General Manager

THE PURE OIL COMPANY

Date June 7, 1944

LOCATION REPORT

A.F.E. No. _____

Division Mich. Producing

District _____

Lease _____

E. Martens

Acres _____ Lease No. _____

Elevation _____

Well No. 1(Serial No. 665)Quadrangle NW-NW-NWSec. 11Twp. 10NRge. 8WMontcalmMontcalm

Survey _____

County MontcalmState MichiganOperator Allegan Pipe & Supply Co.Map Montcalm Township, Montcalm County330 330 Feet from North Line of Lease

" " East " " "

" " South " " "

330 330 " " West " " "Feet from North Line of Section 1/4

" " East " " "

" " South " " "

330 330 " " West " " "

LEGEND

○ Location



Gas Well



Oil Well



Gas-Distillate Well



Dry Hole



Dry Showing Oil



Dry Showing Gas



Abandoned Location



Abandoned Gas Well



Abandoned Oil Well



Input Well

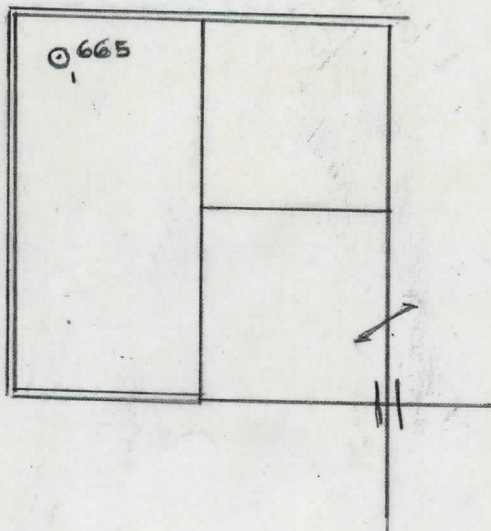

Remarks: _____

Scale _____

Submitted by RN

Civil Engineer

Approved by _____

Division Manager

Approved by _____

Vice-President-General Manager

Signed **D. C. Shackelford**