



Western Michigan University
ScholarWorks at WMU

Legacy Scout Tickets from Pure Oil Company

8-20-2021

**MGRRE_PureOilScoutTickets_Barr, Charles aka McLaughlin,
Kate_1_21121000900000**

MGRRE
Western Michigan University

Follow this and additional works at: <https://scholarworks.wmich.edu/pure>



Part of the Geology Commons

WMU ScholarWorks Citation

MGRRE, "MGRRE_PureOilScoutTickets_Barr, Charles aka McLaughlin, Kate_1_21121000900000" (2021).
Legacy Scout Tickets from Pure Oil Company. 6927.
<https://scholarworks.wmich.edu/pure/6927>

This Document is brought to you for free and open access via ScholarWorks at WMU. It has been accepted for inclusion in Legacy Scout Tickets from Pure Oil Company by an authorized administrator of ScholarWorks at WMU. See the National Digital Catalogue - Science Base Catalogue for more collections submitted by MGRRE.



**MGRRE_PureOilScoutTickets_Barr, Charles aka McLaughlin,
Kate_1_21121000900000**

API 21121000900000

Permit Number 90

Lease Name Barr, Charles aka McLaughlin, Kate

Well Number 1

County Muskegon

Township 10N

Range 16W

Section 14

2021 DEQ or Pure co_name Warren and Kitchen

Pure Number 64

Latitude 43.25986

Longitude -86.18084

THE PURE OIL COMPANY

THE PURE OIL COMPANY
LOCATION REPORT

No. 64

DATE

June 30th 1928

STATE

Michigan

COUNTY

Muskegon

DIST.

Muskegon

SEC.

14

TOWN

10N

RANGE

16W

WELL No.

1

(SERIAL No.

64)

FARM

Kate McLaughlin

ACRES

NAME OF STREAM OR WATERS

QUADRANGLE

OPERATOR

Kitchen - Warren

MAP

Muskegon Co Muskegon Co

250

Feet from North Line of Farm

" " East " " "

" " South " " "

250

" " West " " "

Feet from North Line of Section

" " East " " "

" " South " " "

" " West " " "

LEGEND

O LOCATION

① RIG

⊕ DRILLING

⊗ GAS WELL

● OIL WELL

⊙ SMALL OIL WELL

⊕ DRY HOLE

⊕ DRY SHOWING OIL

⊕ DRY SHOWING GAS

⊕ ABANDONED LOCATION

⊕ ABANDONED GAS WELL

⊕ ABANDONED OIL WELL

NOTE: Below make tracing from map (when no map is obtainable make sketch), showing farm, center of section, this location with measurements and also wells, dry holes, or other locations in the vicinity of this location. Make copy to keep for reference and send original to Columbus office.

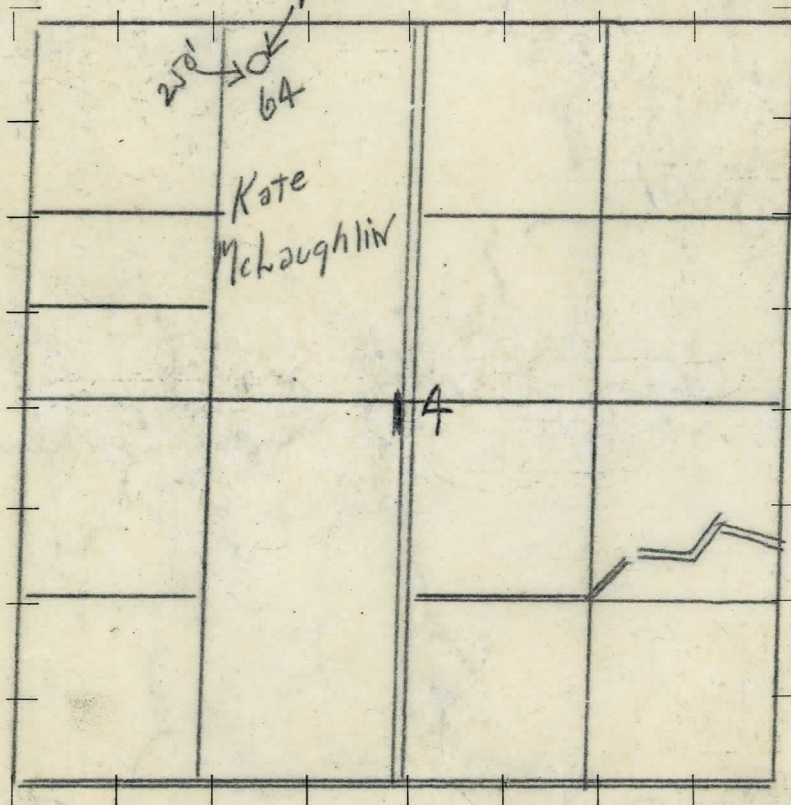

REMARKS:

SIGNED

Superintendent or Foreman.

