



Western Michigan University  
ScholarWorks at WMU

---

Legacy Scout Tickets from Pure Oil Company

---

8-20-2021

**MGRRE\_PureOilScoutTickets\_Becker  
Brothers\_1\_21121001430000**

MGRRE  
*Western Michigan University*

Follow this and additional works at: <https://scholarworks.wmich.edu/pure>



Part of the Geology Commons

---

#### WMU ScholarWorks Citation

MGRRE, "MGRRE\_PureOilScoutTickets\_Becker Brothers\_1\_21121001430000" (2021). *Legacy Scout Tickets from Pure Oil Company*. 6973.  
<https://scholarworks.wmich.edu/pure/6973>

This Document is brought to you for free and open access via ScholarWorks at WMU. It has been accepted for inclusion in Legacy Scout Tickets from Pure Oil Company by an authorized administrator of ScholarWorks at WMU. See the National Digital Catalogue - Science Base Catalogue for more collections submitted by MGRRE.



---

**MGRRE\_PureOilScoutTickets\_Becker Brothers\_1\_21121001430000**

API 21121001430000

Permit Number 143

Lease Name Becker Brothers

Well Number 1

County Muskegon

Township 10N

Range 16W

Section 4

2021 DEQ or Pure co\_name Muskegon Oil Corporation

Pure Number 110

Latitude 43.28222

Longitude -86.22299

DATE Sept 22nd 1928THE PURE OIL COMPANY  
LOCATION REPORTNo. 110STATE Michigan COUNTY Muskegon DIST. TWP. Muskegon SEC. 4 TOWN 18N RANGE 16W  
WELL No. 1 (SERIAL No. 110) FARM O. A. Becker ACRESNAME OF STREAM OR WATERS \_\_\_\_\_ QUADRANGLE \_\_\_\_\_  
OPERATOR Muskegon Oil Co MAP Muskegon Tp. Muskegon Co

Feet from North Line of Farm

" " East " " "

250 " " South " " "100 " " West " " "

Feet from North Line of Section

" " East " " "

" " South " " "

" " West " " "

## LEGEND

O LOCATION

① RIG

⊕ DRILLING

⊗ GAS WELL

● OIL WELL

⦿ SMALL OIL WELL

⦿ DRY HOLE

⦿ DRY SHOWING OIL

⦿ DRY SHOWING GAS

⦿ ABANDONED LOCATION

⦿ ABANDONED GAS WELL

⦿ ABANDONED OIL WELL

NOTE: Below make tracing from map (when no map is obtainable make sketch), showing farm, center of section, this location with measurements and also wells, dry holes, or other locations in the vicinity of this location. Make copy to keep for reference and send original to Columbus office.

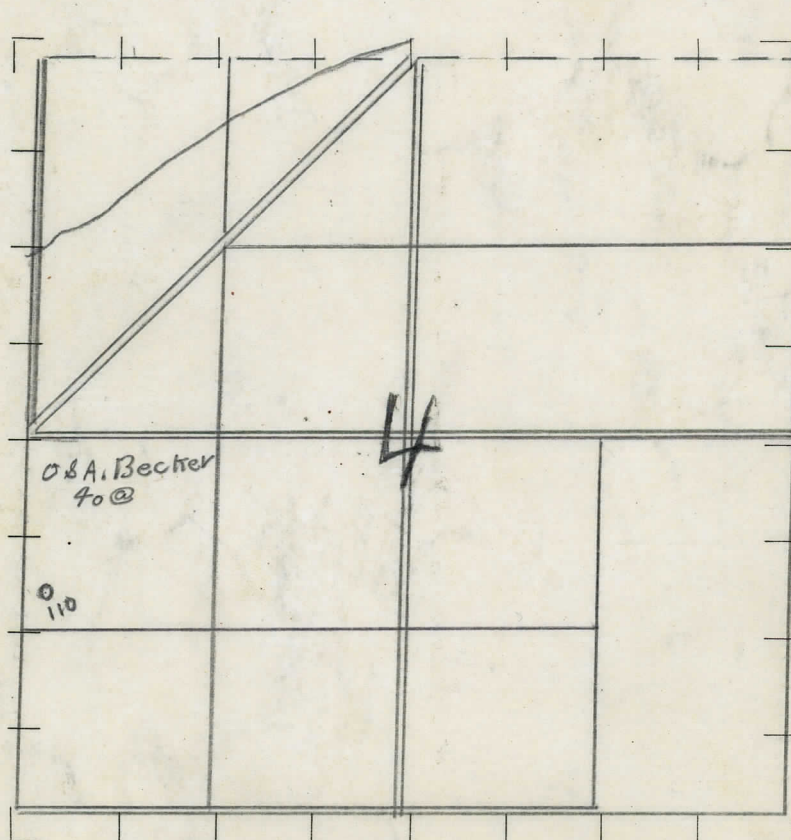

REMARKS:

SIGNED

W. W. Wiersch  
Superintendent or Foreman.







## THE PURE OIL COMPANY

## LOCATION REPORT

No. 110

DATE Sept 22nd 1928STATE Michigan COUNTY Muskegon DIST. Muskegon SEC. 4 TOWN 10N RANGE 16WWELL No. 1 (SERIAL No. 110) FARM O & A. Becker ACRES

NAME OF STREAM OR WATERS QUADRANGLE

OPERATOR Muskegon Oil Co MAP Muskegon Tp. Muskegon Co

Feet from North Line of Farm

" " East " " "

250 " " South " " "

100 " " West " " "

Feet from North Line of Section

" " East " " "

" " South " " "

" " West " " "

## LEGEND

O LOCATION

① RIG

⊕ DRILLING

⊗ GAS WELL

● OIL WELL

⦿ SMALL OIL WELL

⦿ DRY HOLE

⦿ DRY SHOWING OIL

⦿ DRY SHOWING GAS

⦿ ABANDONED LOCATION

⦿ ABANDONED GAS WELL

⦿ ABANDONED OIL WELL

NOTE: Below make tracing from map (when no map is obtainable make sketch), showing farm, center of section, this location with measurements and also wells, dry holes, or other locations in the vicinity of this location. Make copy to keep for reference and send original to Columbus office.

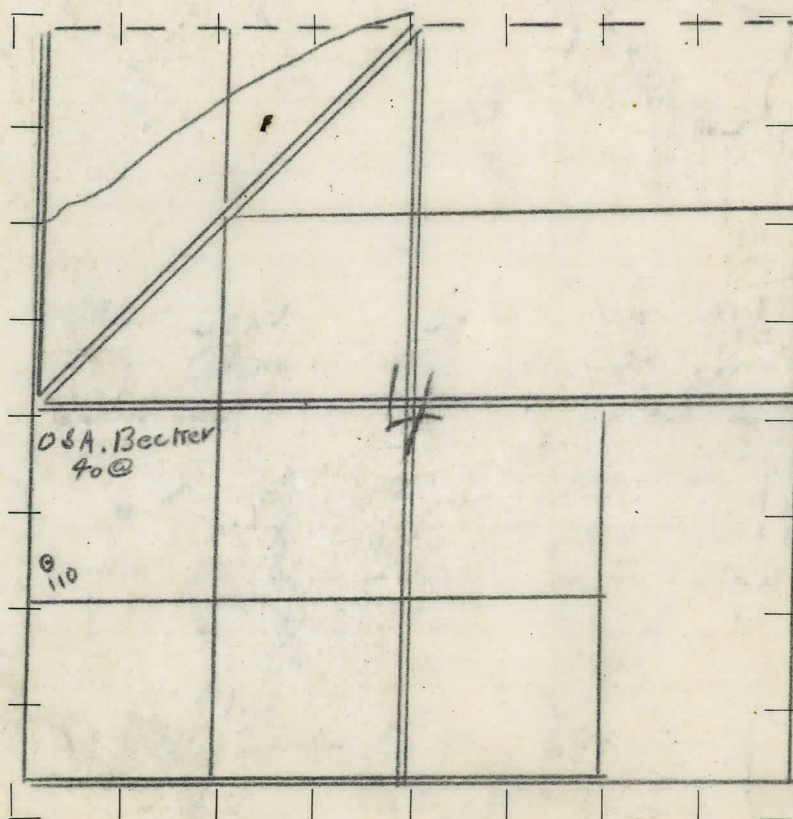

REMARKS:

SIGNED

Superintendent or Foreman.



DATE Feb. 2nd 1929 **COMPLETION RECORD** No. 110

STATE Michigan COUNTY Muskegon DIST. Muskegon SEC. 9 TOWN 10 N RANGE 16 W  
WELL No. 1 (SERIAL No. 110) FARM O. A. Becker ACRES

NAME OF STREAM OR WATERS QUADRANGLE

OPERATOR Muskegon Oil Co. MAP Muskegon Twp. Muskegon Co.

LOCATION REPORT SENT IN (DATE) Sept. 22 1928

WELL STARTED (DATE) Sept. 1928 WELL COMPLETED (DATE) Nov. 11th 1928

OIL WELL	<del>GAS WELL</del>	<del>DRA HOLE</del>	<del>ABANDONED WELL</del>
----------	---------------------	---------------------	---------------------------

CROSS OUT THREE OF THE ABOVE  
WELL RECORD

DATE OF SHOT	NUMBER OF QUARTS	BARRELS OR FEET
1st 24 HOURS PRODUCTION		
2nd " " "		
3rd " " "		
4th " " "		
5th " " "		

SAND AND CASING

CASING SIZE	WEIGHT	CASING Feet Inches	SAND Name and Nature	TOP	BOTTOM	TOP PAY	BOTTOM PAY	SALT WATER
10"		241	Sand	-0-	50	Oil	1690	
8 1/2"		355	Clay	50	95	Lime	2038	
6 5/8"		2038	Sand	95	14.5	Break	2050	2054
			Clay	145	190	Lime	2054	2061
			Sand	190	220	Top of Gas		2061
			Clay	220	240	Top of Oil		2064
			Sand	240	315	Total Depth		2068
			Clay	315	600			
			Lime	600	640			
			Clay	640	867			
			Red Lime	867	890			

REMARKS  
Clay 890 - 1455  
Brown Lime 1455 - 1600  
Lime 1600 - 1632  
Slate 1632 - 1647  
Lime 1647 - 1665  
Oil + Water 1665

*Handwritten note:* 2038  
Jan. 16 1929  
2038