



Western Michigan University
ScholarWorks at WMU

Legacy Scout Tickets from Pure Oil Company

8-20-2021

MGRRE_PureOilScoutTickets_Continental_4_21121002030000

MGRRE

Western Michigan University

Follow this and additional works at: <https://scholarworks.wmich.edu/pure>



Part of the Geology Commons

WMU ScholarWorks Citation

MGRRE, "MGRRE_PureOilScoutTickets_Continental_4_21121002030000" (2021). *Legacy Scout Tickets from Pure Oil Company*. 6992.

<https://scholarworks.wmich.edu/pure/6992>

This Document is brought to you for free and open access via ScholarWorks at WMU. It has been accepted for inclusion in Legacy Scout Tickets from Pure Oil Company by an authorized administrator of ScholarWorks at WMU. See the National Digital Catalogue - Science Base Catalogue for more collections submitted by MGRRE.



MGRRE_PureOilScoutTickets_Continental_4_21121002030000

API 21121002030000

Permit Number 203

Lease Name Continental

Well Number 4

County Muskegon

Township 10N

Range 16W

Section 16

2021 DEQ or Pure co_name Continental Motors Corporation

Pure Number 129

Latitude 43.25798

Longitude -86.20882

Form 24 53 WELL REPORT - OUTSIDE OPERATIONS

SERIAL NO.

129

STATE

Michigan

RSEK

CO.

Muskegon

OPERATOR

Continental Motor Corp.

FARM

Continental Motor Corp.

WELL NO.

4

TWP.

~~SURVEY~~

Muskegon

S. 16

T. 10N

R. 16W

LOC.

SW NE

WILDCAT ☐FIELD ☐

FIELD NAME

MAP NO.

CO-ORD.

ELEV.

STATUS

Plugged and Abandoned 3-13-48

Total Depth 2014'

NORTH

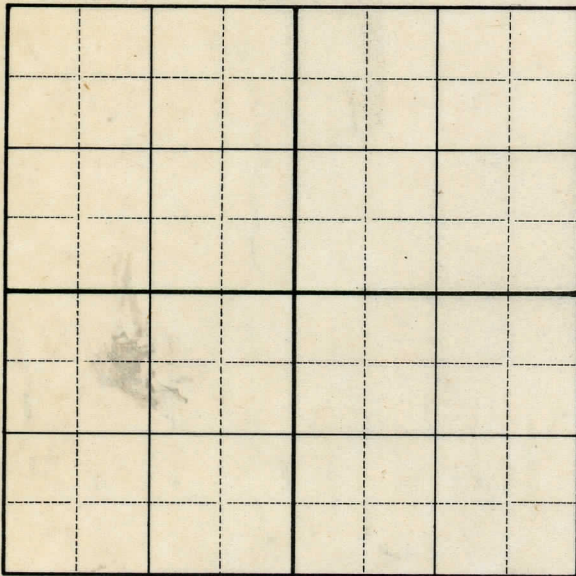

DATE

4-12-48

SCOUT

H. J. G.

LOCATION REPORT

DATE 19-29 LOCATION REPORT No. _____
STATE Mich COUNTY Muskegon DIST. Muskegon SEC. 16 TOWN 10 N RANGE 16 W
WELL No. 4 (SERIAL No. 129) FARM Cont. Motors Corp ACRES _____
NAME OF STREAM OR WATERS _____ QUADRANGLE _____
OPERATOR Cont. Motors MAP _____

Feet from North Line of Farm

" " East " " "

" " South " " "

" " West " " "

Feet from North Line of Section

" " East " " "

" " South " " "

" " West " " "

950
1450

N of E & W 1/4 Line

LEGEND

- | | |
|------------------|----------------------|
| ○ LOCATION | ⊙ DRY HOLE |
| ① RIG | ⊙ DRY SHOWING OIL |
| ⊕ DRILLING | ⊙ DRY SHOWING GAS |
| ⊙ GAS WELL | ⊙ ABANDONED LOCATION |
| ● OIL WELL | ⊙ ABANDONED GAS WELL |
| ⊙ SMALL OIL WELL | ⊙ ABANDONED OIL WELL |

NOTE: Below make tracing from map, (when no map is obtainable make sketch) showing farm, center of section, this location with measurements and also wells, dry holes, or other locations in the vicinity of this location. Make copy to keep for reference and send original to Columbus office.

SEE PLAT FOR CORRECTED
LOCATION OF WELL # 72



REMARKS:

SIGNED

Superintendent or Foreman.

DATE Oct. 13th 1928 LOCATION REPORT No. 129

STATE Michigan COUNTY Washtenaw DIST. Washtenaw SEC. 16 TOWN 10N RANGE 16W
 WELL No. 4 (SERIAL No. 129) FARM Continental Motors Corp ACRES

NAME OF STREAM OR WATERS QUADRANGLE

OPERATOR Continental Motors Corp MAP Washtenaw Sp. Washtenaw Co

Feet from North Line of Farm

" " East " " "

" " South " " "

" " West " " "

Feet from North Line of Section

" " East " " "

" " South " " "

" " West " " "

LEGEND

- O LOCATION
- ① RIG
- ⊕ DRILLING
- ⊗ GAS WELL
- OIL WELL
- ⬮ SMALL OIL WELL
- ⬮ DRY HOLE
- ⬮ DRY SHOWING OIL
- ⬮ DRY SHOWING GAS
- ⬮ ABANDONED LOCATION
- ⬮ ABANDONED GAS WELL
- ⬮ ABANDONED OIL WELL

NOTE: Below make tracing from map (when no map is obtainable make sketch), showing farm, center of section, this location with measurements and also wells, dry holes, or other locations in the vicinity of this location. Make copy to keep for reference and send original to Columbus office.

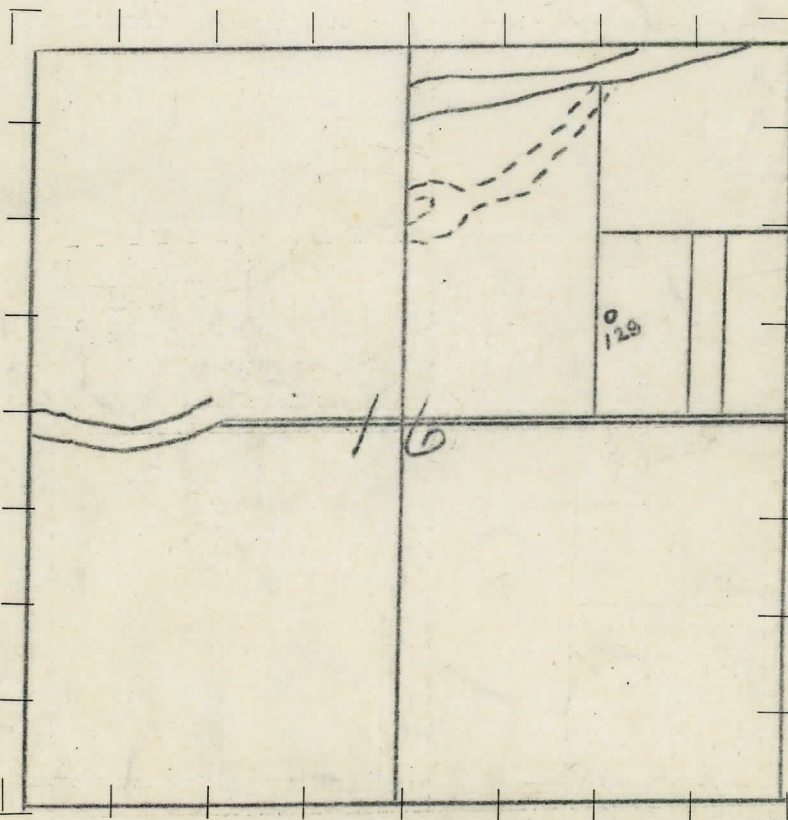

REMARKS: 400' Due East and 300' North of cor # 72.

SIGNED

Superintendent or Foreman.

Saginaw Michigan Special DIVISION

DATE Jan. 12th 1929.

COMPLETION RECORD

No. 129

STATE Michigan COUNTY Muskegon DIST. Muskegon SEC. 16 TOWN 10N RANGE 16W
TWP. Muskegon
PREC.

WELL No. 4 (SERIAL No. 129) FARM Continental Motor Corp. ACRES

NAME OF STREAM OR WATERS _____ QUADRANGLE _____

OPERATOR Continental Motor Corp. MAP Muskegon Twp. Muskegon co.

LOCATION REPORT SENT IN (DATE) Oct. 13th 1928

WELL STARTED (DATE) Oct. 13th 1928 WELL COMPLETED (DATE) Jan. 12th 1929

OIL WELL

GAS WELL

XXXXXX DRY HOLE XXXXXXXX

XXABANDONED WELLXX

CROSS OUT THREE OF THE ABOVE

WELL RECORD

DATE OF SHOT _____ NUMBER OF QUARTS _____

1st 24 HOURS PRODUCTION _____ BARRELS OR FEET

[illegible]

3rd " " "

4th " " " " " " " "

5th " " " " " "

SAND AND CASING

[illegible]

REMARKS