



Western Michigan University  
ScholarWorks at WMU

---

Legacy Scout Tickets from Pure Oil Company

---

8-20-2021

**MGRRE\_PureOilScoutTickets\_Cihak aka Cihak, Fred  
#1\_2\_21121001800000**

MGRRE  
*Western Michigan University*

Follow this and additional works at: <https://scholarworks.wmich.edu/pure>



Part of the Geology Commons

---

#### **WMU ScholarWorks Citation**

MGRRE, "MGRRE\_PureOilScoutTickets\_Cihak aka Cihak, Fred #1\_2\_21121001800000" (2021). *Legacy Scout Tickets from Pure Oil Company*. 7006.  
<https://scholarworks.wmich.edu/pure/7006>

This Document is brought to you for free and open access via ScholarWorks at WMU. It has been accepted for inclusion in Legacy Scout Tickets from Pure Oil Company by an authorized administrator of ScholarWorks at WMU. See the National Digital Catalogue - Science Base Catalogue for more collections submitted by MGRRE.



---

**MGRRE\_PureOilScoutTickets\_Cihak aka Cihak, Fred #1\_2\_21121001800000**

API 21121001800000

Permit Number 180

Lease Name Cihak aka Cihak, Fred #1

Well Number 2

County Muskegon

Township 10N

Range 16W

Section 8

2021 DEQ or Pure co\_name Dundee Oil and Gas Company

Pure Number 143

Latitude 43.27733

Longitude -86.23802

Form 24 5M  
DATE Oct 27th 1928

## THE PURE OIL COMPANY

## LOCATION REPORT

No. 143STATE Michigan COUNTY Muskegon DIST. Muskegon SEC. 8 TOWN 10N RANGE 16W  
WELL No. 1 (SERIAL No. 143) FARM Fred Cihak ACRESNAME OF STREAM OR WATERS \_\_\_\_\_ QUADRANGLE \_\_\_\_\_  
OPERATOR Dundee Oil & Gas Co MAP Muskegon Twp. Muskegon Co.

\_\_\_\_\_ Feet from North Line of Farm

\_\_\_\_\_ " " East " " "

\_\_\_\_\_ " " South " " "

\_\_\_\_\_ " " West " " "

238 Feet from North Line of Section

\_\_\_\_\_ " " East " " "

\_\_\_\_\_ " " South " " "

1568 " " West " " "LEGEND

○ LOCATION

① RIG

⊕ DRILLING

⊗ GAS WELL

● OIL WELL

⬮ SMALL OIL WELL

⬮ DRY HOLE

⬮ DRY SHOWING OIL

⬮ DRY SHOWING GAS

⬮ ABANDONED LOCATION

⬮ ABANDONED GAS WELL

⬮ ABANDONED OIL WELL

NOTE: Below make tracing from map (when no map is obtainable make sketch), showing farm, center of section, this location with measurements and also wells, dry holes, or other locations in the vicinity of this location. Make copy to keep for reference and send original to Columbus office.

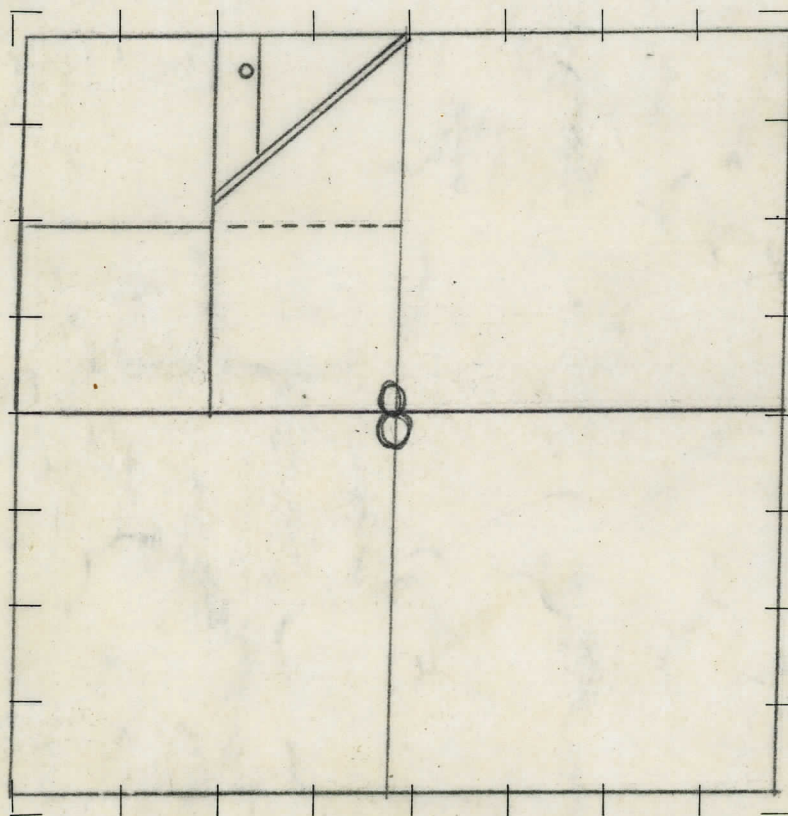

REMARKS:

SIGNED

Superintendent or Foreman.



**SUPT. OR FOREMAN**



DESCRIPTION	QUANTITY	MAKE	SIZE	MATERIAL
-------------	----------	------	------	----------

STATE MICHIGAN COUNTY MUSKEGON DIST MUSKEGON SEC. 8 TOWN 10-N RANGE 16-W  
WELL No. ONE (SERIAL No. 143) FARM FRED CIHAK 5 ACRES  
NAME OF STREAM OR WATERS \_\_\_\_\_ QUADRANGLE NE $\frac{1}{4}$  OF NW $\frac{1}{4}$  OF Sec. 8.  
OPERATOR DUNDEE OIL & GAS COMPANY MAP MUSKEGON AREA

238 Feet from North Line of Farm

82 " " East " " "

" " South " " "

" " West " " "

1238 Feet from North Line of Section

" " East " " "

" " South " " "

1568 " " West " " "

#### LEGEND

○ LOCATION

① RIG

⊕ DRILLING

⊗ GAS WELL

● OIL WELL

⬮ SMALL OIL WELL

⬮ DRY HOLE

⬮ DRY SHOWING OIL

⬮ DRY SHOWING GAS

⬮ ABANDONED LOCATION

⬮ ABANDONED GAS WELL

⬮ ABANDONED OIL WELL

NOTE: Below make tracing from map (when no map is obtainable make sketch), showing farm, center of section, this location with measurements and also wells, dry holes, or other locations in the vicinity of this location. Make copy to keep for reference and send original to Columbus office.

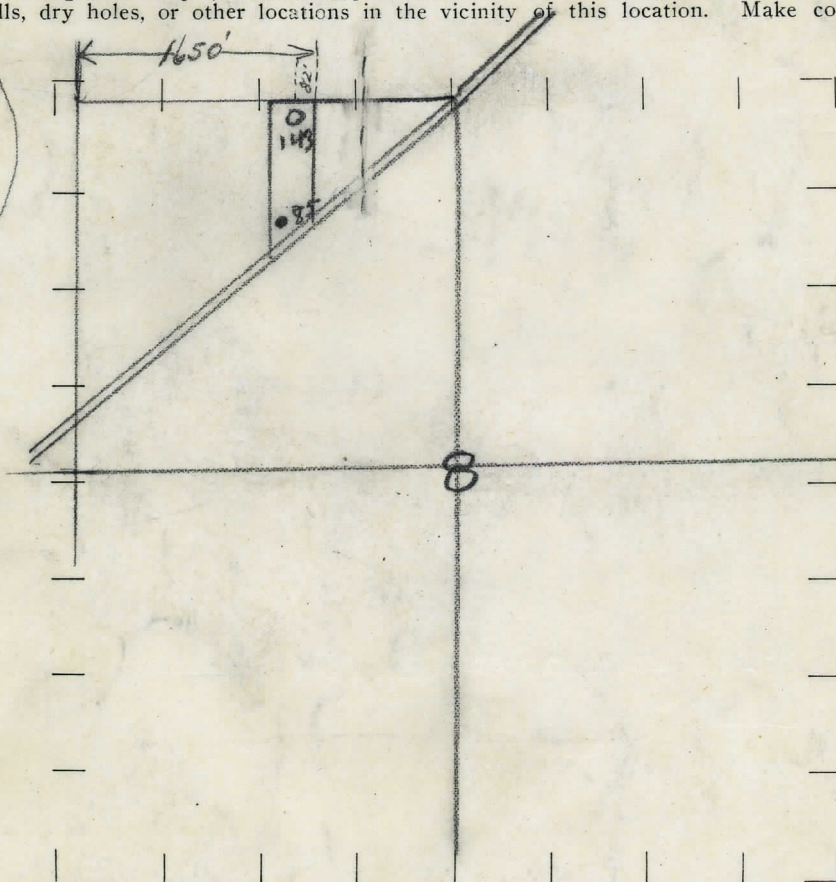

REMARKS:

SIGNED

Superintendent or Foreman.



DATE March 23rd, 1929

No. 143

WELL No. 1 (SERIAL No. 143) FARM Fred Cihak

ACRES

NAME OF STREAM OR WATERS \_\_\_\_\_ QUADRANGLE \_\_\_\_\_

OPERATOR Dundee Oil & Gas Co. MAP Muskegon Twp. Muskegon Co.

LOCATION REPORT SENT IN (DATE) October 27th, 1928.

WELL STARTED (DATE) October 1929. WELL COMPLETED (DATE) March 23rd, 1929.

## OIL WELL

## GAS WELL

## DRY HOLE

## ABANDONED WELL

**CROSS OUT THREE OF THE ABOVE**

## WELL RECORD

DATE OF SHOT \_\_\_\_\_ NUMBER OF QUARTS \_\_\_\_\_

1st 24 HOURS PRODUCTION \_\_\_\_\_ BARRELS OR FEET

2nd " " " " " "

3rd " " " " "

4th " " " \_\_\_\_\_ " " "

5th " " " \_\_\_\_\_ " " "

## SAND AND CASING

[illegible]

REMARKS	Est. 100 bbls.oil da.
---------	-----------------------

NOTE:—MAKE COPY TO KEEP FOR REFERENCE AND SEND ORIGINAL TO CHICAGO OFFICE. LIST MATERIAL CHARGEABLE TO WELL ON OTHER SIDE.

SIGNED

**SUPT. OR FOREMAN**