



Western Michigan University
ScholarWorks at WMU

Legacy Scout Tickets from Pure Oil Company

8-20-2021

MGRRE_PureOilScoutTickets_Becker, A._2-D_21121002120000

MGRRE

Western Michigan University

Follow this and additional works at: <https://scholarworks.wmich.edu/pure>



Part of the Geology Commons

WMU ScholarWorks Citation

MGRRE, "MGRRE_PureOilScoutTickets_Becker, A._2-D_21121002120000" (2021). *Legacy Scout Tickets from Pure Oil Company*. 7018.

<https://scholarworks.wmich.edu/pure/7018>

This Document is brought to you for free and open access via ScholarWorks at WMU. It has been accepted for inclusion in Legacy Scout Tickets from Pure Oil Company by an authorized administrator of ScholarWorks at WMU. See the National Digital Catalogue - Science Base Catalogue for more collections submitted by MGRRE.



MGRRE_PureOilScoutTickets_Becker, A._2-D_21121002120000

API 21121002120000

Permit Number 212

Lease Name Becker, A.

Well Number 2-D

County Muskegon

Township 10N

Range 16W

Section 4

2021 DEQ or Pure co_name Dixie Oil Company

Pure Number 155

Latitude 43.27852

Longitude -86.21438

THE PURE OIL COMPANY
LOCATION REPORT

DATE Nov-16th 1928No. 155

STATE Michigan COUNTY Muskegon DIST. Muskegon SEC. 4 TOWN 10N RANGE 11W
WELL No. 2-D (SERIAL No. 155) FARM A. Becker ACRES

NAME OF STREAM OR WATERS QUADRANGLE

OPERATOR Dixie Oil Co MAP Muskegon Twp. Muskegon Co.

Feet from North Line of Farm

" " East " " "

" " South " " "

" " West " " "

Feet from North Line of Section

" " East " " "

250 " " South " " "2400 " " West " " "

LEGEND

O LOCATION

① RIG

⊕ DRILLING

⊗ GAS WELL

● OIL WELL

⦿ SMALL OIL WELL

⦿ DRY HOLE

⦿ DRY SHOWING OIL

⦿ DRY SHOWING GAS

⦿ ABANDONED LOCATION

⦿ ABANDONED GAS WELL

⦿ ABANDONED OIL WELL

NOTE: Below make tracing from map (when no map is obtainable make sketch), showing farm, center of section, this location with measurements and also wells, dry holes, or other locations in the vicinity of this location. Make copy to keep for reference and send original to Columbus office.

Elevation

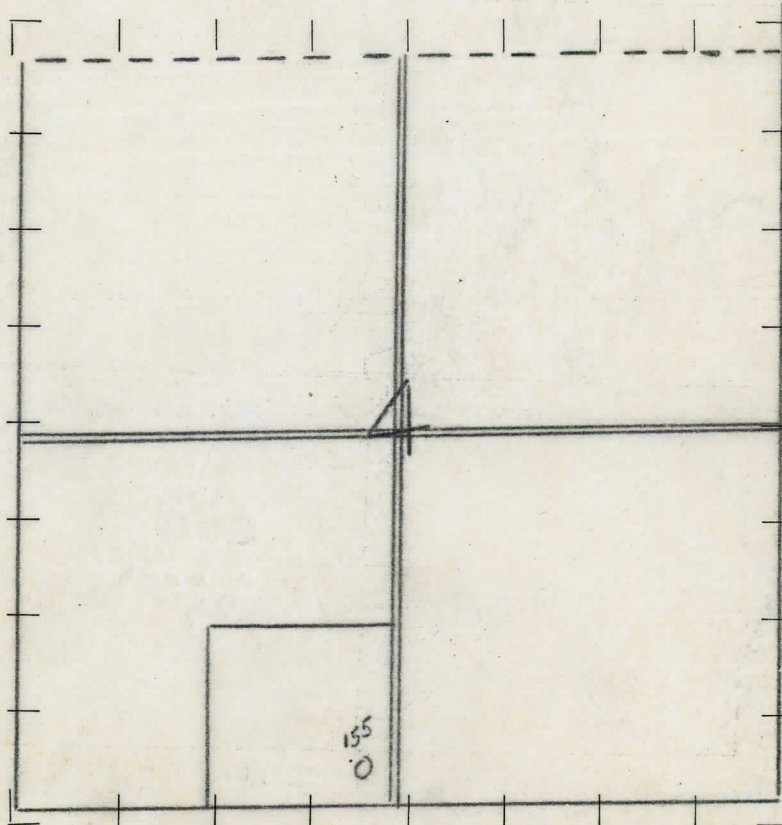
628.4

REMARKS:

SIGNED

Superintendent or Foreman.

STATE MICHIGAN COUNTY MUSKEGON DIST MUSKEGON SEC. 4 TOWN 10-N RANGE 16-W
WELL No. TWO-D (SERIAL No. 155) FARM A. BECKER 40 ACRES
NAME OF STREAM OR WATERS _____ QUADRANGLE SE cor SE SW SEC. 4
OPERATOR DIXIE OIL CO. INC. MAP MUSKEGON AREA

Feet from North Line of Farm
250 " " East " " "
250 " " South " " "
" " West " " "
Feet from North Line of Section
" " East " " "
250 " " South " " "
2400 2390 " " West " " "

- LEGEND**
- | | |
|------------------|----------------------|
| ○ LOCATION | ✦ DRY HOLE |
| ① RIG | ✦ DRY SHOWING OIL |
| ⊕ DRILLING | ✦ DRY SHOWING GAS |
| ⊗ GAS WELL | ✦ ABANDONED LOCATION |
| ● OIL WELL | ✦ ABANDONED GAS WELL |
| ⬮ SMALL OIL WELL | ✦ ABANDONED OIL WELL |

NOTE: Below make tracing from map (when no map is obtainable make sketch), showing farm, center of section, this location with measurements and also wells, dry holes, or other locations in the vicinity of this location. Make copy to keep for reference and send original to Columbus office.

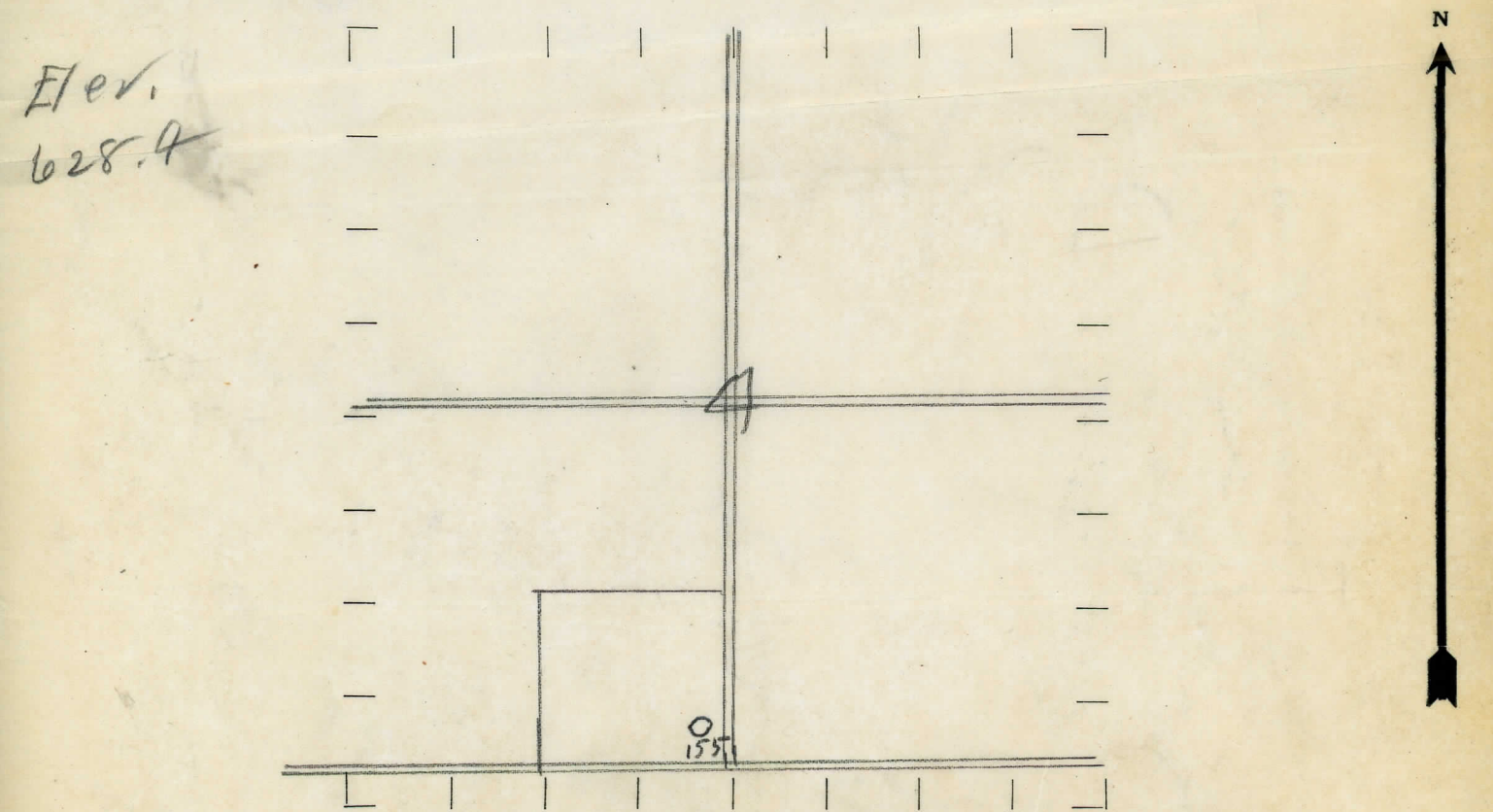

REMARKS:

SIGNED _____
Superintendent or Foreman.

No. 122.

DIST. Muskegon SEC. 4
TWP. _____
PREC. _____

WELL No. 2-D (SERIAL No. 155) FARM A. Becker ACRES _____

NAME OF STREAM OR WATERS _____ QUADRANGLE _____

OPERATOR Dixie Oil Co MAP Muskegon Twp. Muskegon Co.

LOCATION REPORT SENT IN (DATE) Nov. 10th 1938

WELL STARTED (DATE) Nov. 1938 WELL COMPLETED (DATE) Jan. 13th 1938

ABANDONED WELL

WELL RECORD

DATE OF SHOT _____ NUMBER OF QUARTS _____

1st 24 HOURS PRODUCTION _____ BARRELS OR FEET

2nd " " " _____ " " "

3rd " " " " " " "

4th " " " " " " " "

5th " " " _____ " " "

SAND AND CASING

[illegible]

REMARKS.

SUPT. OR FOREMAN