



Western Michigan University
ScholarWorks at WMU

Legacy Scout Tickets from Pure Oil Company

8-20-2021

MGRRE_PureOilScoutTickets_Cramer, C._1_na

MGRRE

Western Michigan University

Follow this and additional works at: <https://scholarworks.wmich.edu/pure>



Part of the Geology Commons

WMU ScholarWorks Citation

MGRRE, "MGRRE_PureOilScoutTickets_Cramer, C._1_na" (2021). *Legacy Scout Tickets from Pure Oil Company*. 7068.

<https://scholarworks.wmich.edu/pure/7068>

This Document is brought to you for free and open access via ScholarWorks at WMU. It has been accepted for inclusion in Legacy Scout Tickets from Pure Oil Company by an authorized administrator of ScholarWorks at WMU. See the National Digital Catalogue - Science Base Catalogue for more collections submitted by MGRRE.



MGRRE_PureOilScoutTickets_Cramer, C._1_na

API na

Permit Number na

Lease Name Cramer, C.

Well Number 1

County Muskegon

Township 10N

Range 16W

Section 5

2021 DEQ or Pure co_name Muskecon oOil Corp

Pure Number 205

Latitude 43.2867509

Longitude -86.2333778

THE PURE OIL COMPANY
LOCATION REPORTDATE Dec 5th 1928No. 205STATE Michigan COUNTY Muskegon DIST. Muskegon SEC. 5 TOWN 10N RANGE 16WWELL No. 1 (SERIAL No. 205) FARM C. Cramer ACRES

NAME OF STREAM OR WATERS QUADRANGLE

OPERATOR Muskegon Oil Corp MAP Muskegon Twp Muskegon Co

Feet from North Line of Farm

" " East " " "

" " South " " "

" " West " " "

Feet from North Line of Section

100 " " East " " "

2740 " " South " " "

" " West " " "

LEGEND

O LOCATION

① RIG

⊕ DRILLING

⊙ GAS WELL

● OIL WELL

⬮ SMALL OIL WELL

⊙ DRY HOLE

⬮ DRY SHOWING OIL

⊙ DRY SHOWING GAS

⊙ ABANDONED LOCATION

⬮ ABANDONED GAS WELL

⬮ ABANDONED OIL WELL

NOTE: Below make tracing from map, (when no map is obtainable make sketch) showing farm, center of section, this location with measurements and also wells, dry holes, or other locations in the vicinity of this location. Make copy to keep for reference and send original to Columbus office.

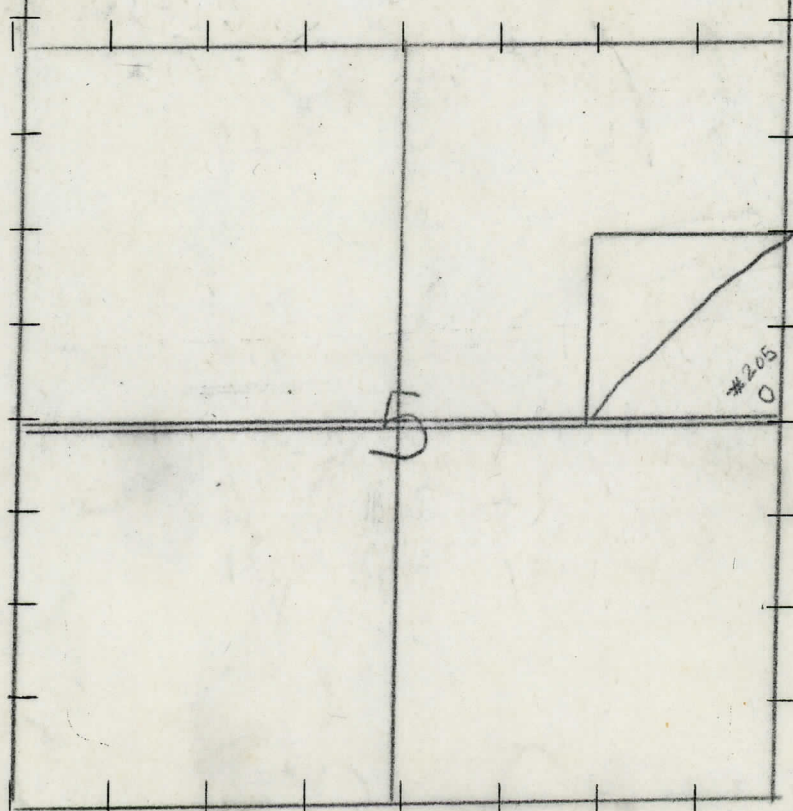

REMARKS:

SIGNED

Superintendent or Foreman.

| | | | | | | |
|----------|----------|----------|------|------|------|-------|
| STATE | COUNTY | DIST. | TWP. | SEC. | TOWN | RANGE |
| MICHIGAN | MUSKEGON | MUSKEGON | 5 | 10-N | 16-W | |

WELL No. 1 (SERIAL No. 205) FARM C. CRAMER. 40 ACRES

NAME OF STREAM OR WATERS _____ QUADRANGLE SE NE 5-10-16-W

OPERATOR MUSKEGON OIL CORPORATION MAP MUSKEGON COUNTY & TOWNSHIP

.....Feet from North Line of Farm

100 " " East " " "

100 " " South " " "

" " West " " "

.....Feet from North Line of Section

100 " " East " " "

2740 " " South " " "

" " West " " "

- LEGEND**
- | | |
|------------------|----------------------|
| ○ LOCATION | ⊕ DRY HOLE |
| ① RIG | ⊕ DRY SHOWING OIL |
| ⊕ DRILLING | ⊕ DRY SHOWING GAS |
| ⊕ GAS WELL | ⊕ ABANDONED LOCATION |
| ● OIL WELL | ⊕ ABANDONED GAS WELL |
| ⊕ SMALL OIL WELL | ⊕ ABANDONED OIL WELL |

NOTE: Below make tracing from map, (when no map is obtainable make sketch) showing farm, center of section, this location with measurements and also wells, dry holes, or other locations in the vicinity of this location. Make copy to keep for reference and send original to Columbus office.

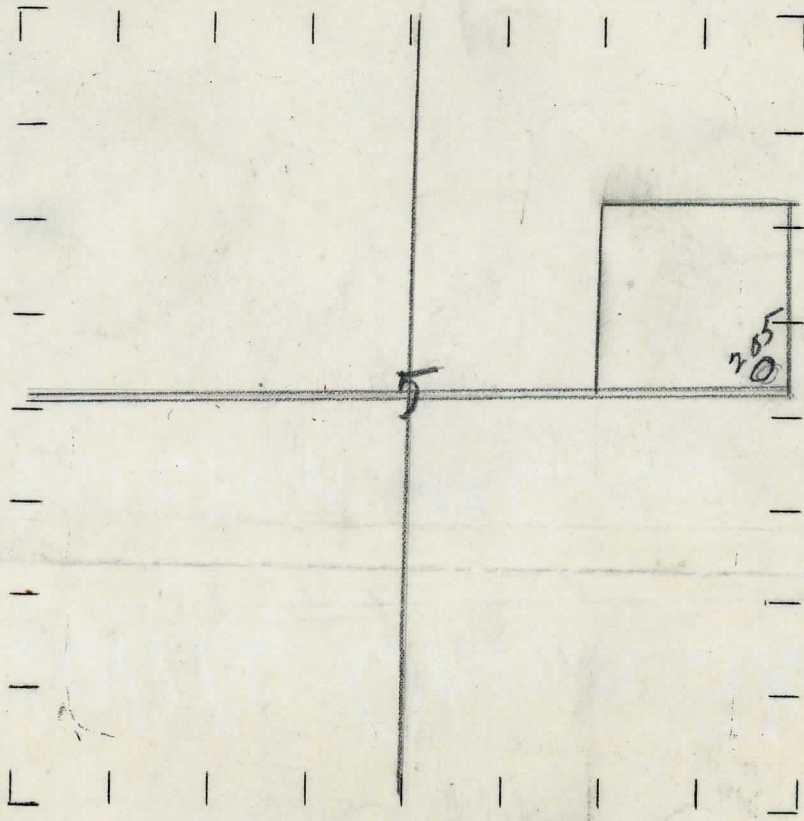

REMARKS:

.....

.....

.....

SIGNED

Superintendent or Foreman.