



Western Michigan University  
ScholarWorks at WMU

---

Legacy Scout Tickets from Pure Oil Company

---

8-20-2021

**MGRRE\_PureOilScoutTickets\_Brand, George\_1\_21121002890000**

MGRRE

*Western Michigan University*

Follow this and additional works at: <https://scholarworks.wmich.edu/pure>



Part of the Geology Commons

---

#### WMU ScholarWorks Citation

MGRRE, "MGRRE\_PureOilScoutTickets\_Brand, George\_1\_21121002890000" (2021). *Legacy Scout Tickets from Pure Oil Company*. 7074.

<https://scholarworks.wmich.edu/pure/7074>

This Document is brought to you for free and open access via ScholarWorks at WMU. It has been accepted for inclusion in Legacy Scout Tickets from Pure Oil Company by an authorized administrator of ScholarWorks at WMU. See the National Digital Catalogue - Science Base Catalogue for more collections submitted by MGRRE.



---

**MGRRE\_PureOilScoutTickets\_Brand, George\_1\_21121002890000**

API 21121002890000

Permit Number 289

Lease Name Brand, George

Well Number 1

County Muskegon

Township 10N

Range 17W

Section 11

2021 DEQ or Pure co\_name Grimes, F. S.

Pure Number 211

Latitude 43.26428

Longitude -86.2839

THE PURE OIL COMPANY

**Corrected Location Report**DATE 1-19-29

LOCATION REPORT

No.

STATE Mich COUNTY Muskegon DIST. Laketon SEC. 11 TOWN 10N RANGE 17WWELL No. 1 (SERIAL No. 211) FARM George Brand ACRES

NAME OF STREAM OR WATERS QUADRANGLE

OPERATOR Grimes & Madigan MAP

Feet from North Line of Farm

" " East " " "

" " South " " "

" " West " " "

Feet from North Line of Section

" " East " " "

" " South " " "

" " West " " "

**LEGEND**

O LOCATION

① RIG

⊕ DRILLING

⊗ GAS WELL

● OIL WELL

⦿ SMALL OIL WELL

⊙ DRY HOLE

⊕ DRY SHOWING OIL

⊗ DRY SHOWING GAS

⊙ ABANDONED LOCATION

⊗ ABANDONED GAS WELL

⦿ ABANDONED OIL WELL

NOTE: Below make tracing from map, (when no map is obtainable make sketch) showing farm, center of section, this location with measurements and also wells, dry holes, or other locations in the vicinity of this location. Make copy to keep for reference and send original to Columbus office.

SEE PLAT FOR CORRECTED  
LOCATION OF # 214

REMARKS:

SIGNED

Superintendent or Foreman.



STATE Michigan COUNTY Muskegon DIST. Laketon SEC. 11 TOWN 10N RANGE 17W  
 WELL No. 1 (SERIAL No. 211) FARM George Brand ACRES

NAME OF STREAM OR WATERS QUADRANGLE

OPERATOR Grimes + Maddigan MAP Laketon sup Muskegon Co

Feet from North Line of Farm

" " East " " "

" " South " " "

" " West " " "

Feet from North Line of Section

600 " " East " " "

300 " " South " " "

" " West " " "

# LEGEND

○ LOCATION

① RIG

⊕ DRILLING

⊗ GAS WELL

● OIL WELL

⦿ SMALL OIL WELL

⊗ DRY HOLE

⦿ DRY SHOWING OIL

⦿ DRY SHOWING GAS

⦿ ABANDONED LOCATION

⦿ ABANDONED GAS WELL

⦿ ABANDONED OIL WELL

NOTE: Below make tracing from map, (when no map is obtainable make sketch) showing farm, center of section, this location with measurements and also wells, dry holes, or other locations in the vicinity of this location. Make copy to keep for reference and send original to Columbus office.

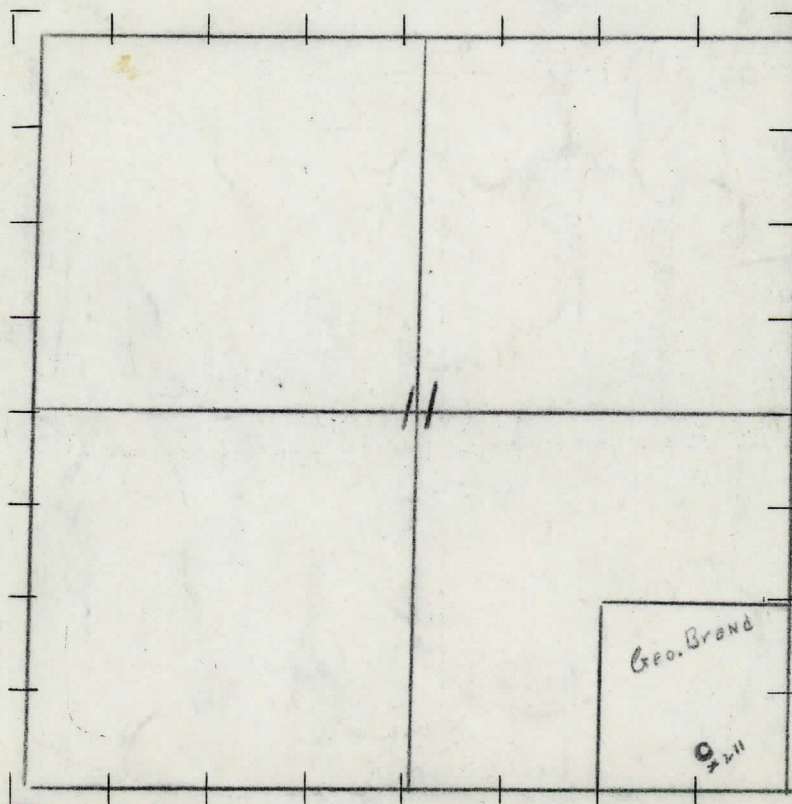

REMARKS:

SIGNED

Superintendent or Foreman.



STATE *MICHIGAN* COUNTY *MUSKEGON* DIST. *LAKETON* SEC. *11* TOWN *10-N* RANGE *17-W*  
 WELL No. *1* (SERIAL No. *211*) FARM *GEORGE BRAND* 40 ACRES  
 NAME OF STREAM OR WATERS QUADRANGLE *SE SE 11-10-17-W.*  
 OPERATOR *GRIMES & MADDIGAN* MAP *MUSKEGON COUNTY & LAKETON TOWNSHIP*

Feet from North Line of Farm

100 " " East " " "  
 300 " " South " " "  
 " " West " " "

Feet from North Line of Section

600 " " East " " "  
 300 " " South " " "  
 " " West " " "

**LEGEND**

- |                  |                      |
|------------------|----------------------|
| ○ LOCATION       | ⊙ DRY HOLE           |
| ① RIG            | ⊕ DRY SHOWING OIL    |
| ⊕ DRILLING       | ⊙ DRY SHOWING GAS    |
| ⊙ GAS WELL       | ⊙ ABANDONED LOCATION |
| ● OIL WELL       | ⊙ ABANDONED GAS WELL |
| ⊙ SMALL OIL WELL | ⊙ ABANDONED OIL WELL |

NOTE: Below make tracing from map, (when no map is obtainable make sketch) showing farm, center of section, this location with measurements and also wells, dry holes, or other locations in the vicinity of this location. Make copy to keep for reference and send original to Columbus office.

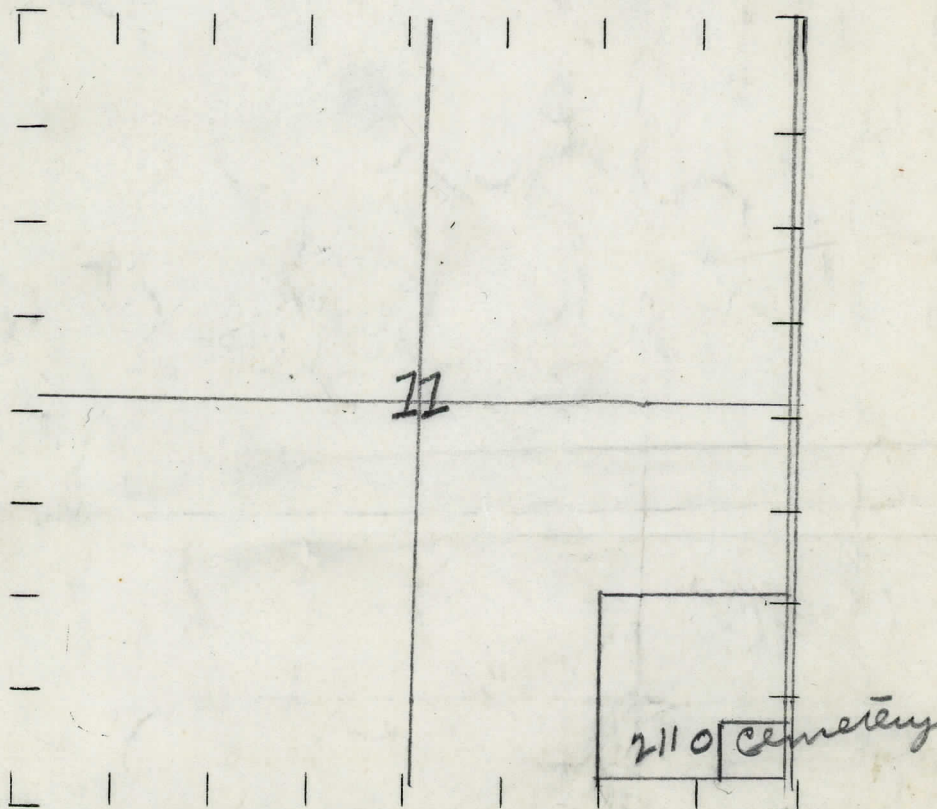

REMARKS:

SIGNED

Superintendent or Foreman,



