



Western Michigan University  
ScholarWorks at WMU

---

Legacy Scout Tickets from Pure Oil Company

---

8-20-2021

## MGRRE\_PureOilScoutTickets\_Continental Motors Corporation\_8\_unk

MGRRE  
*Western Michigan University*

Follow this and additional works at: <https://scholarworks.wmich.edu/pure>



Part of the Geology Commons

---

### WMU ScholarWorks Citation

MGRRE, "MGRRE\_PureOilScoutTickets\_Continental Motors Corporation\_8\_unk" (2021). *Legacy Scout Tickets from Pure Oil Company*. 7084.  
<https://scholarworks.wmich.edu/pure/7084>

This Document is brought to you for free and open access via ScholarWorks at WMU. It has been accepted for inclusion in Legacy Scout Tickets from Pure Oil Company by an authorized administrator of ScholarWorks at WMU. See the National Digital Catalogue - Science Base Catalogue for more collections submitted by MGRRE.



---

## MGRRE\_PureOilScoutTickets\_Continental Motors Corporation\_8\_unk

API unk

Permit Number unk

Lease Name Continental Motors Corporation

Well Number 8

County Muskegon

Township 10N

Range 16W

Section 22

2021 DEQ or Pure co\_name Continental Motors Corporation

Pure Number 221

Latitude 43.2415214

Longitude -86.1940914

221

## THE PURE OIL COMPANY

DATE DEC. 28<sup>th</sup> 1928

## LOCATION REPORT

No.

STATE MICHIGAN COUNTY MUSKEGON DIST. MUSKEGON SEC. 22 TOWN 10N RANGE 16W  
PREC.WELL No. 8 (SERIAL No. 221) FARM Continental Motors Corp'n ACRES

NAME OF STREAM OR WATERS QUADRANGLE

OPERATOR Continental Motors Corp'n MAP Muskegon Twp (4<sup>th</sup> 1 Mi.)

Feet from North Line of Farm

" " East " " "

" " South " " "

" " West " " "

250 Feet from North Line of Section

" " East " " "

" " South " " "

1090 " " N & S 1/2 line West " " "

## LEGEND

O LOCATION

① RIG

⊕ DRILLING

⊙ GAS WELL

● OIL WELL

⦿ SMALL OIL WELL

⦿ DRY HOLE

⦿ DRY SHOWING OIL

⦿ DRY SHOWING GAS

⦿ ABANDONED LOCATION

⦿ ABANDONED GAS WELL

⦿ ABANDONED OIL WELL

NOTE: Below make tracing from map, (when no map is obtainable make sketch) showing farm, center of section, this location with measurements and also wells, dry holes, or other locations in the vicinity of this location. Make copy to keep for reference and send original to Columbus office.

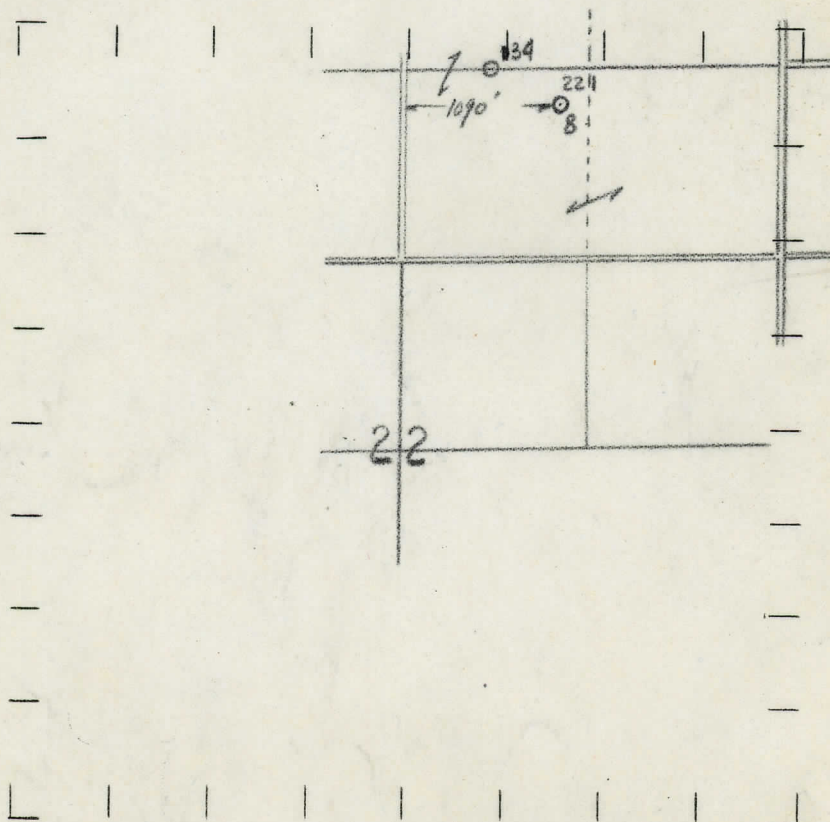

REMARKS:

Digging up.

SIGNED

Superintendent or Foreman.



DATE 15/05/2008

## LOCATION REPORT

No.

STATE MICHIGAN COUNTY MUSKEGON DIST. MUSKEGON SEC. 22 TOWN 10-N RANGE 16-W.  
TWP. PREC.

WELL No. 8 (SERIAL No. 221 ) FARM CONTINENTAL MOTORS CORPORATION. ACRES

NAME OF STREAM OR WATERS..... QUADRANGLE NW NE

OPERATOR CONTINENTAL MOTORS CORPORATIONS. MAP MUSKEGON COUNTY & TOWNSHIP.

.....Feet from North Line of Farm

----- " " East " " "

----- " " South " " "

----- “ “ West “ “ “

250 Feet from North Line of Section

----- " " East " " "

----- " " South " " "

1090 " " West  $\frac{1}{4}$  " " "

### LEGEND

### O LOCATION

① RIG

⊕ DRILLING

 GAS WELL

## ● OIL WELL

● SMALL OIL WELL

 DRY HOLE

 DRY SHOWING OIL

## ⚙ DRY SHOWING GAS

**ABANDONED LOCATION**

 ABANDONED GAS WELL

ABANDONED OIL WELL

NOTE: Below make tracing from map, (when no map is obtainable make sketch) showing farm, center of section, this location with measurements and also wells, dry holes, or other locations in the vicinity of this location. Make copy to keep for reference and send original to Columbus office.

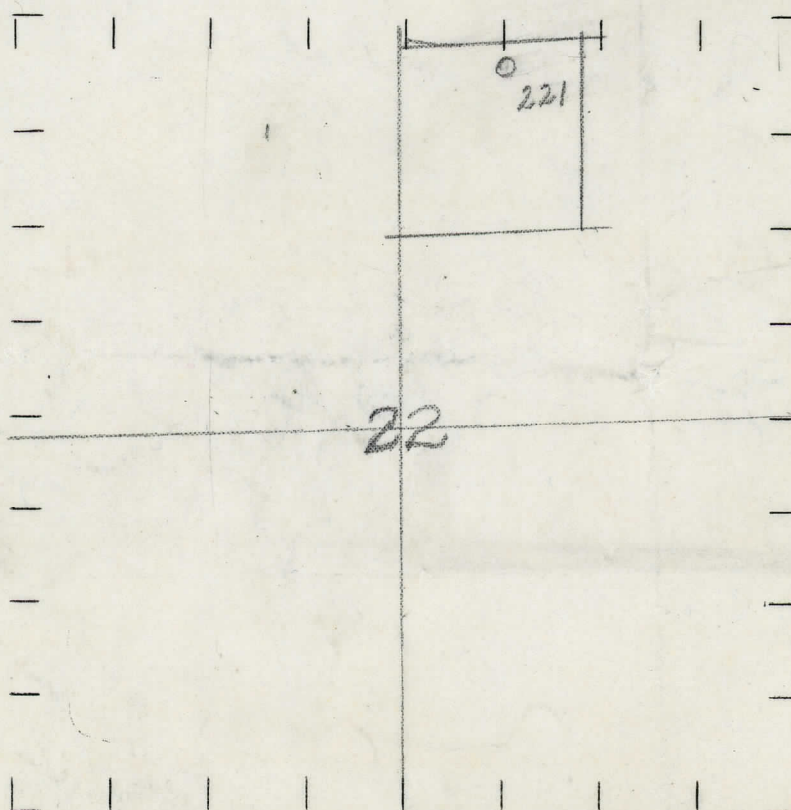

REMARKS:

600' SW of our 178 at a 45 degree angle.

SIGNED

.....  
 Superintendent or Foreman.



WELL No. 8 (SERIAL No. 221) FARM Continental Motors Corp. ACRES           

OPERATOR	Continental Motors Corp.	MAP
----------	--------------------------	-----

LOCATION REPORT SENT IN (DATE) December 28th, 1928.

WELL STARTED (DATE) December 1928. WELL COMPLETED (DATE) February 18th, 1929.

## ABANDONED WELL

**CROSS OUT THREE OF THE ABOVE  
WELL RECORD**

DATE OF SHOT \_\_\_\_\_ NUMBER OF QUARTS \_\_\_\_\_

1st 24 HOURS PRODUCTION \_\_\_\_\_ BARRELS OR FEET \_\_\_\_\_

2nd " " " " " "

3rd " " "

---

4th " " " " " "

5th " " " " " "

## SAND AND CASING

[illegible]

REMARKS	Pumping 80 bbls.da.				
---------	---------------------	--	--	--	--

**NOTE:—MAKE COPY TO KEEP FOR REFERENCE AND SEND ORIGINAL TO CHICAGO OFFICE. LIST MATERIAL CHARGEABLE TO WELL ON OTHER SIDE.**

SIGNED \_\_\_\_\_ SUPT. OR FOREMAN