



Western Michigan University
ScholarWorks at WMU

Legacy Scout Tickets from Pure Oil Company

8-20-2021

**MGRRE_PureOilScoutTickets_Continental Motors Corp aka
Fee_9_21121003550000**

MGRRE
Western Michigan University

Follow this and additional works at: <https://scholarworks.wmich.edu/pure>



Part of the Geology Commons

WMU ScholarWorks Citation

MGRRE, "MGRRE_PureOilScoutTickets_Continental Motors Corp aka Fee_9_21121003550000" (2021).
Legacy Scout Tickets from Pure Oil Company. 7148.
<https://scholarworks.wmich.edu/pure/7148>

This Document is brought to you for free and open access via ScholarWorks at WMU. It has been accepted for inclusion in Legacy Scout Tickets from Pure Oil Company by an authorized administrator of ScholarWorks at WMU. See the National Digital Catalogue - Science Base Catalogue for more collections submitted by MGRRE.



**MGRRE_PureOilScoutTickets_Continental Motors Corp aka
Fee_9_21121003550000**

API 21121003550000

Permit Number 355

Lease Name Continental Motors Corp aka Fee

Well Number 9

County Muskegon

Township 10N

Range 16W

Section 15

2021 DEQ or Pure co_name Continental Motors Corporation

Pure Number 285

Latitude 43.25966

Longitude -86.19885

THE PURE OIL COMPANY

LOCATION REPORT

DATE 3-3-29No. 285STATE MICHIGAN COUNTY MUSKEGON DIST. MUSKEGON SEC. 15 TOWN 10N RANGE 16W
WELL No. 9 (SERIAL No. 285) FARM FEE ACRESNAME OF STREAM OR WATERS QUADRANGLE N 1/2 NWOPERATOR CONTINENTAL MOTORS CORP. MAP MUSKEGON TWP. - 4" = 1 MILE

Feet from North Line of Farm

" " East " " "

" " South " " "

" " West " " "

Feet from North Line of Section

" " East " " "

" " South " " "

" " West " " "

LEGEND

O LOCATION

① RIG

⊕ DRILLING

⊗ GAS WELL

● OIL WELL

⦿ SMALL OIL WELL

⦿ DRY HOLE

⦿ DRY SHOWING OIL

⦿ DRY SHOWING GAS

⦿ ABANDONED LOCATION

⦿ ABANDONED GAS WELL

⦿ ABANDONED OIL WELL

NOTE: Below make tracing from map, (when no map is obtainable make sketch) showing farm, center of section, this location with measurements and also wells, dry holes, or other locations in the vicinity of this location. Make copy to keep for reference and send original to Columbus office.

Elevation 587

Dixie Plane Table

Cont Motors Corp

285
① 9

15

N

REMARKS:

SIGNED

Superintendent or Foreman.

DATE 2-2-52 LOCATION REPORT No.

DATE 2/22/29 LOCATION REPORT No.

STATE MICHIGAN COUNTY MUSKEGON DIST. MUSKEGON SEC. 15 TOWN 10-N RANGE 16-W

WELL No. 9 (SERIAL No. 285) FARM FEE ACRES

NAME OF STREAM OR WATERS QUADRANGLE N $\frac{1}{2}$ --NW $\frac{1}{4}$

OPERATOR CONTINENTAL MOTORS CORPORATION. MAP MUSKEGON COUNTY & TOWNSHIP.

Feet from North Line of Farm

" " East " " "

6 " " South " " "

1326 " " West " " "

1321 Feet from North Line of Section

" " East " " "

" " South " " "

1326 " " West " " "

LEGEND

○ LOCATION

⊕ RIG

⊕ DRILLING

⊗ GAS WELL

● OIL WELL

⬮ SMALL OIL WELL

⬮ DRY HOLE

⬮ DRY SHOWING OIL

⬮ DRY SHOWING GAS

⬮ ABANDONED LOCATION

⬮ ABANDONED GAS WELL

⬮ ABANDONED OIL WELL

NOTE: Below make tracing from map, (when no map is obtainable make sketch) showing farm, center of section, this location with measurements and also wells, dry holes, or other locations in the vicinity of this location. Make copy to keep for reference and send original to Columbus office.

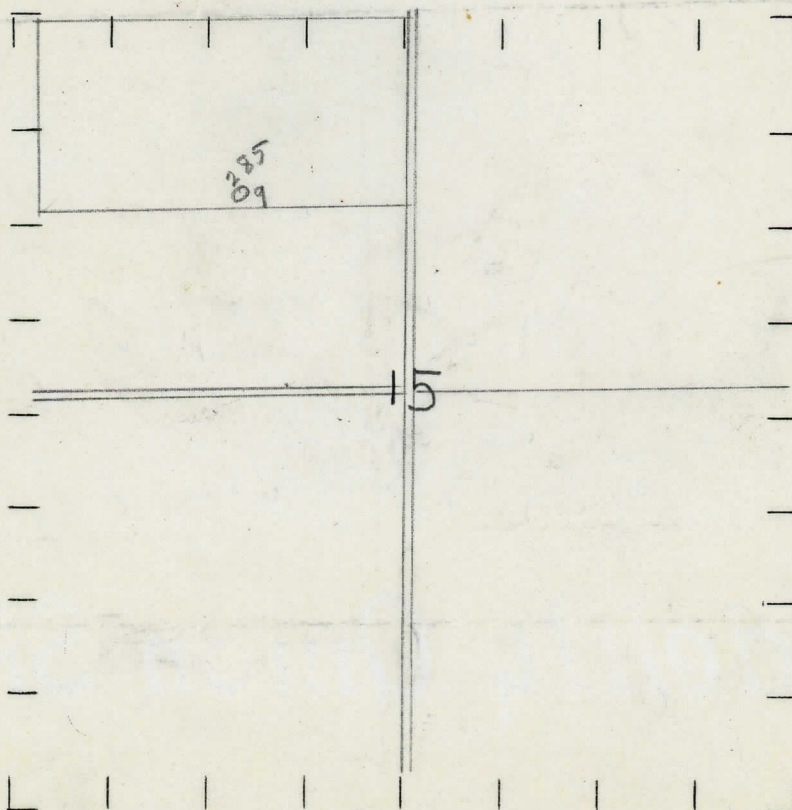

REMARKS:

SIGNED

Superintendent or Foreman.

Michigan Producing DIVISION

DATE March 30th, 1929.

COMPLETION RECORD

No. 285

STATE Michigan COUNTY Muskegon DIST. Muskegon SEC. 15 TOWN 10 N RANGE 16W

WELL No. 1 (SERIAL No. 235) FARM 100 ACRES

NAME OF STREAM OR WATERS _____ QUADRANGLE _____

OPERATOR Cont. Motors Corp. MAP

LOCATION REPORT SENT IN (DATE) March 2nd, 1929.

WELL STARTED (DATE) March 1929.

WELL COMPLETED (DATE) March 1929.

OIL WELL

GAS WELL

DRY HOLE

ABANDONED WELL

**CROSS OUT THREE OF THE ABOVE
WELL RECORD**

DATE OF SHOT _____ NUMBER OF QUARTS _____

1st 24 HOURS PRODUCTION _____ BARRELS OR FEET

2nd " " " " " "

3rd " " " " " "

4th " " " " " " "

5th " " " " " " "

SAND AND CASING

[illegible]

NOTE:—MAKE COPY TO KEEP FOR REFERENCE AND SEND ORIGINAL TO CHICAGO OFFICE. LIST MATERIAL CHARGEABLE TO WELL ON OTHER SIDE.

SIGNED.

SUPT. OR FOREMAN