



Western Michigan University  
ScholarWorks at WMU

---

Legacy Scout Tickets from Pure Oil Company

---

8-20-2021

MGRRE\_PureOilScoutTickets\_Bullock, C. L.\_1\_21121010950000

MGRRE

*Western Michigan University*

Follow this and additional works at: <https://scholarworks.wmich.edu/pure>



Part of the Geology Commons

---

#### WMU ScholarWorks Citation

MGRRE, "MGRRE\_PureOilScoutTickets\_Bullock, C. L.\_1\_21121010950000" (2021). *Legacy Scout Tickets from Pure Oil Company*. 7388.

<https://scholarworks.wmich.edu/pure/7388>

This Document is brought to you for free and open access via ScholarWorks at WMU. It has been accepted for inclusion in Legacy Scout Tickets from Pure Oil Company by an authorized administrator of ScholarWorks at WMU. See the National Digital Catalogue - Science Base Catalogue for more collections submitted by MGRRE.



---

MGRRE\_PureOilScoutTickets\_Bullock, C. L.\_1\_21121010950000

API 21121010950000

Permit Number 1095

Lease Name Bullock, C. L.

Well Number 1

County Muskegon

Township 11N

Range 17W

Section 15

2021 DEQ or Pure co\_name Muskegon Development Company

Pure Number 527

Latitude 43.35055

Longitude -86.31801

## THE PURE OIL COMPANY

DATE October 10th, 1930.

## LOCATION REPORT

No. 527STATE Michigan COUNTY Muskegon DIST. Fruitland TWP. 15 SEC. 15 TOWN 11 N RANGE 17 WWELL No. 1 (SERIAL No. 527) FARM C.L. Bullock ACRESNAME OF STREAM OR WATERS QUADRANGLE S<sub>1</sub> NEOPERATOR Reed Oil Co. MAP Fruitland Twp., Muskegon Co.

Feet from North Line of Farm

330 " " East " " "990 " " South " " "

" " West " " "

Feet from North Line of Section

1650330 " " East " " "

" " South " " "

" " West " " "

## LEGEND

O LOCATION

① RIG

⊕ DRILLING

⊗ GAS WELL

● OIL WELL

⬮ SMALL OIL WELL

⬮ DRY HOLE

⬮ DRY SHOWING OIL

⬮ DRY SHOWING GAS

⬮ ABANDONED LOCATION

⬮ ABANDONED GAS WELL

⬮ ABANDONED OIL WELL

NOTE: Below make tracing from map, (when no map is obtainable make sketch) showing farm, center of section, this location with measurements and also wells, dry holes, or other locations in the vicinity of this location. Make copy to keep for reference and send original to Columbus office.

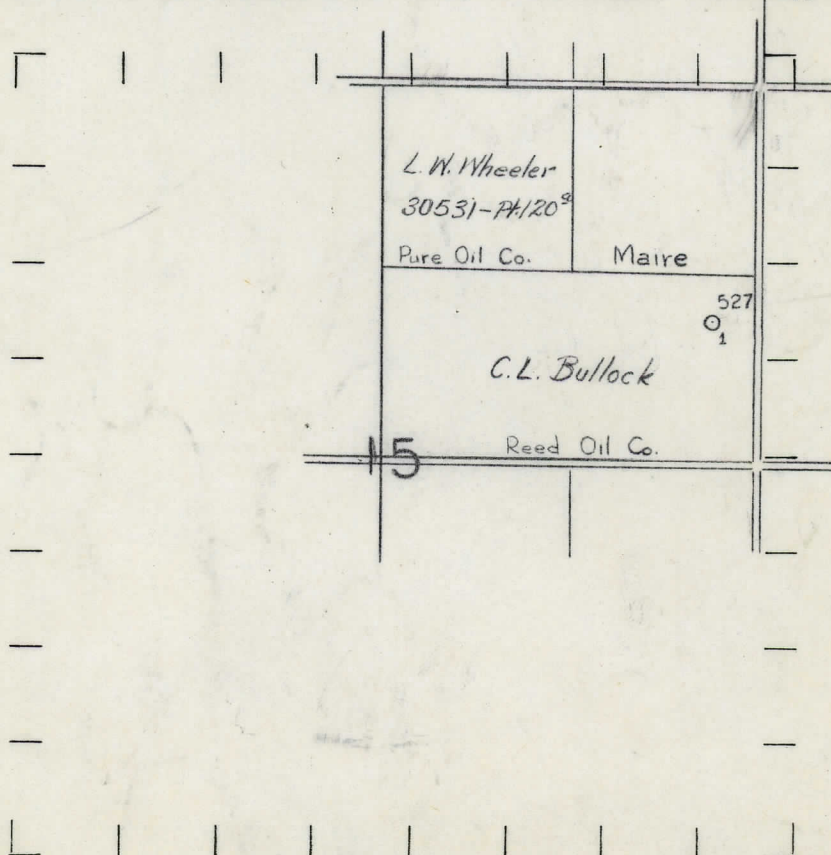

REMARKS:

SIGNED

Superintendent or Foreman.



DATE 10-9-30

LOCATION REPORT

No. 251

DATE 10-9-30

LOCATION REPORT

No.

STATE Michigan COUNTY Muskegon DIST. Fruitland SEC. 15 TOWN 11-N RANGE 17-W

WELL No. 1 (SERIAL No. 527) FARM ACRES

NAME OF STREAM OR WATERS CL Bullock QUADRANGLE S 1/2 - NE 1

OPERATOR Reed Oil Co MAP Fruitland Twp., Muskegon Co.

Feet from North Line of Farm

330 " " East " " "

990 " " South " " "

" " West " " "

Feet from North Line of Section

330 " " East " " "

770 " " South " " "

" " West " " "

LEGEND

O LOCATION

① RIG

⊕ DRILLING

⊗ GAS WELL

● OIL WELL

⬮ SMALL OIL WELL

⬮ DRY HOLE

⬮ DRY SHOWING OIL

⬮ DRY SHOWING GAS

⬮ ABANDONED LOCATION

⬮ ABANDONED GAS WELL

⬮ ABANDONED OIL WELL

NOTE: Below make tracing from map, (when no map is obtainable make sketch) showing farm, center of section, this location with measurements and also wells, dry holes, or other locations in the vicinity of this location. Make copy to keep for reference and send original to Columbus office.

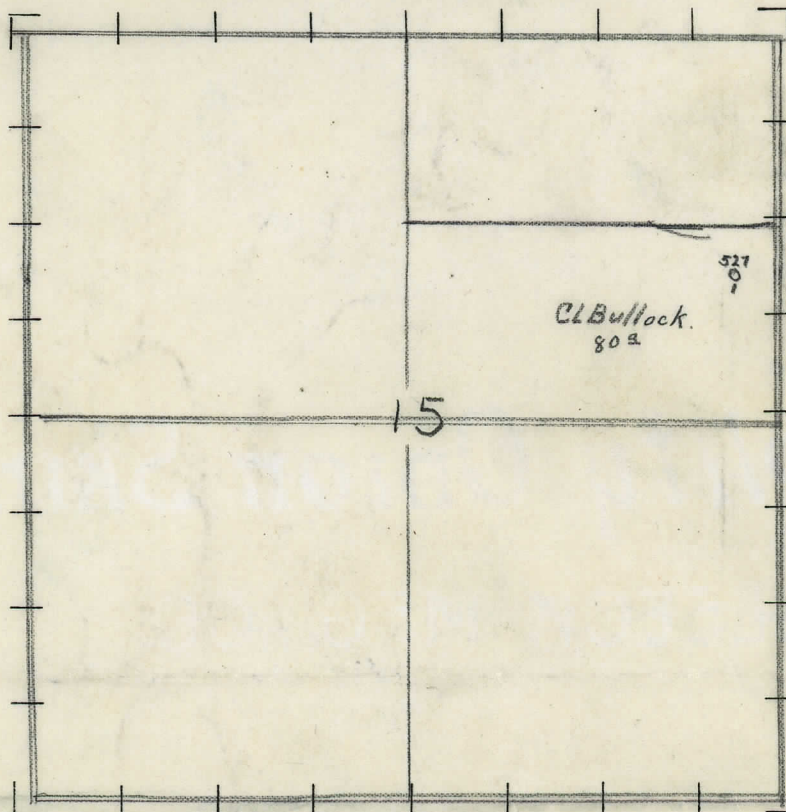

REMARKS:

SIGNED

Chas Wiechers

Superintendent or Foreman.



Michigan Producing DIVISION

## COMPLETION RECORD

No. - 7 -

011-4300

**ENCLOSURE**

~~SECRET~~  
DRY HOLE

## ABANDONED WELL

CROSS OUT THREE OF THE ABOVE

## WELL RECORD

5th " " " \_\_\_\_\_ " " "

## SAND AND CASING

[illegible]

REMARKS	Core test- No information available. Last available depth on test was 305' and believe it was abandoned.									
---------	--	--	--	--	--	--	--	--	--	--

SUPT. OR FOREMAN