



Western Michigan University  
ScholarWorks at WMU

---

Legacy Scout Tickets from Pure Oil Company

---

8-20-2021

**MGRRE\_PureOilScoutTickets\_Bolen, Albertie  
E.\_1\_21121064200000**

MGRRE  
*Western Michigan University*

Follow this and additional works at: <https://scholarworks.wmich.edu/pure>



Part of the Geology Commons

---

#### **WMU ScholarWorks Citation**

MGRRE, "MGRRE\_PureOilScoutTickets\_Bolen, Albertie E.\_1\_21121064200000" (2021). *Legacy Scout Tickets from Pure Oil Company*. 7452.  
<https://scholarworks.wmich.edu/pure/7452>

This Document is brought to you for free and open access via ScholarWorks at WMU. It has been accepted for inclusion in Legacy Scout Tickets from Pure Oil Company by an authorized administrator of ScholarWorks at WMU. See the National Digital Catalogue - Science Base Catalogue for more collections submitted by MGRRE.



---

**MGRRE\_PureOilScoutTickets\_Bolen, Albertie E.\_1\_21121064200000**

API 21121064200000

Permit Number 6420

Lease Name Bolen, Albertie E.

Well Number 1

County Muskegon

Township 10N

Range 15W

Section 19

2021 DEQ or Pure co\_name Lentx and Miller

Pure Number 611

Latitude 43.2465

Longitude -86.1334

THE PURE OIL COMPANY

LOCATION REPORT

DATE July 7, 1939

No. 611

STATE Michigan COUNTY Muskegon DIST. Egleston SEC. 19 TOWN 10 N RANGE 15 W  
 WELL No. 1 (SERIAL No. 611) FARM A. E. Bolen ACRES 15

NAME OF STREAM OR WATERS \_\_\_\_\_ QUADRANGLE SE NW NE

OPERATOR Lentz & Miller, Inc. Trustee Map Egleston Township, Muskegon County

990 Feet from North Line of Farm

330 " " East " " "

" " South " " "

" " West " " "

990 Feet from North Line of 1/4 Section

" " East " " "

" " South " " "

990 " " West " 1/4

LEGEND

○ LOCATION

⊙ RIG

⊕ DRILLING

☼ GAS WELL

● OIL WELL

⦿ SMALL OIL WELL

⊖ DRY HOLE

⦿ DRY SHOWING OIL

⊖ DRY SHOWING GAS

⦿ ABANDONED LOCATION

☼ ABANDONED GAS WELL

⦿ ABANDONED OIL WELL

NOTE: Below make tracing from map, (when no map is obtainable make sketch) showing farm, center of section, this location with measurements and also wells, dry holes, or other locations in the vicinity of this location.

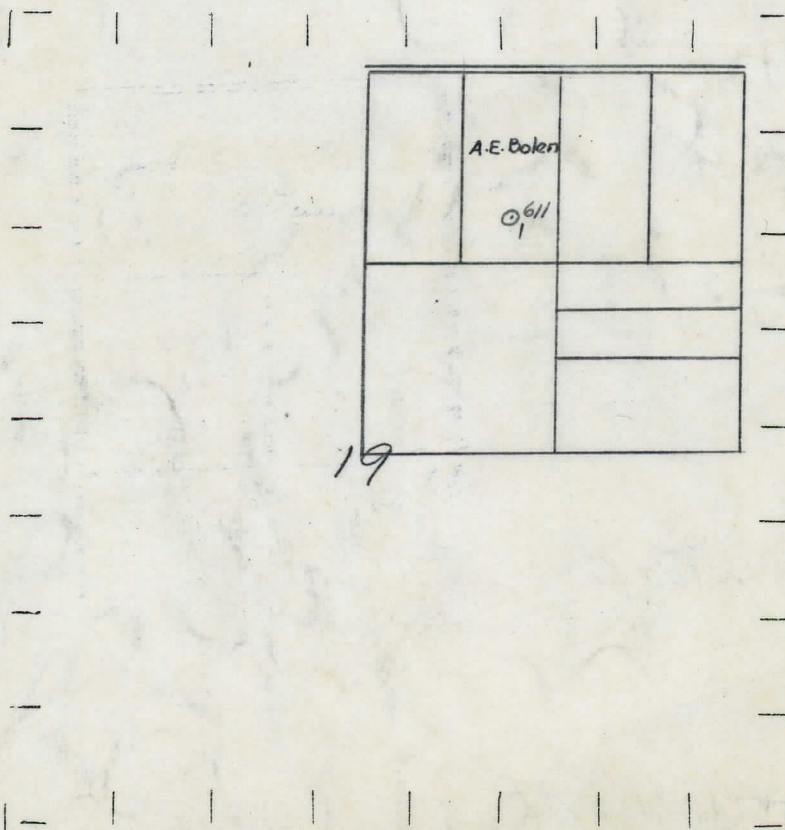

REMARKS:

SIGNED

Superintendent or Foreman.



No. 611

Well No. 1 (Serial No.) 611 Farm A. E. Bolen Acres

Date well started **6-29-39** Dated well completed **8-15-39** Elevation **668.5**

1st 24 hours natural	Dry Hole
----------------------	----------

Date of shot ..... No. of  
quarts ..... From ..... to ..... From ..... to .....

shot

Formation	Top	Bottom	Top Pay	Bottom Pay	Remarks	Casing	
						Size	Set at
Marshall	250					10"	254
Coldwater Lime	672	710				8-1/4"	405
Red Rock	986	1002					
Berea	1045	1070					
Antrim	1508	1720					
Traverse Lime	1764						
Dundee	2115			2121	Small show oil ?.		
			2241	2251	Water.		
Total Depth		2253					

Remarks

Signed D. C. Shackelford