



Western Michigan University
ScholarWorks at WMU

Legacy Scout Tickets from Pure Oil Company

8-20-2021

MGRRE_PureOilScoutTickets_Cussen, T._1_21121081930000

MGRRE

Western Michigan University

Follow this and additional works at: <https://scholarworks.wmich.edu/pure>



Part of the Geology Commons

WMU ScholarWorks Citation

MGRRE, "MGRRE_PureOilScoutTickets_Cussen, T._1_21121081930000" (2021). *Legacy Scout Tickets from Pure Oil Company*. 7468.

<https://scholarworks.wmich.edu/pure/7468>

This Document is brought to you for free and open access via ScholarWorks at WMU. It has been accepted for inclusion in Legacy Scout Tickets from Pure Oil Company by an authorized administrator of ScholarWorks at WMU. See the National Digital Catalogue - Science Base Catalogue for more collections submitted by MGRRE.



MGRRE_PureOilScoutTickets_Cussen, T._1_21121081930000

API 21121081930000

Permit Number 8193

Lease Name Cussen, T.

Well Number 1

County Muskegon

Township 12N

Range 16W

Section 5

2021 DEQ or Pure co_name Welsh Oil Company

Pure Number 627

Latitude 43.46354

Longitude -86.25685

Form WELL REPORT - OUTSIDE OPERATIONS

627 PURE

SERIAL NO.

STATE Michigan ~~xxx~~ Muskegon
 OPERATOR Welsh Oil Co.
 FARM T. Cusser WELL NO. 1
 TWP. Blue Lake S. 5 T. 12N R. 16W
 SURVEY
 LOC. SW SW NW

WILDCAT ☐ FIELD ☐ FIELD NAME _____

MAP NO. _____ CO-ORD. _____ ELEV. _____

STATUS Total Depth 1840'.Plugged and abandoned 2-7-42.

NORTH

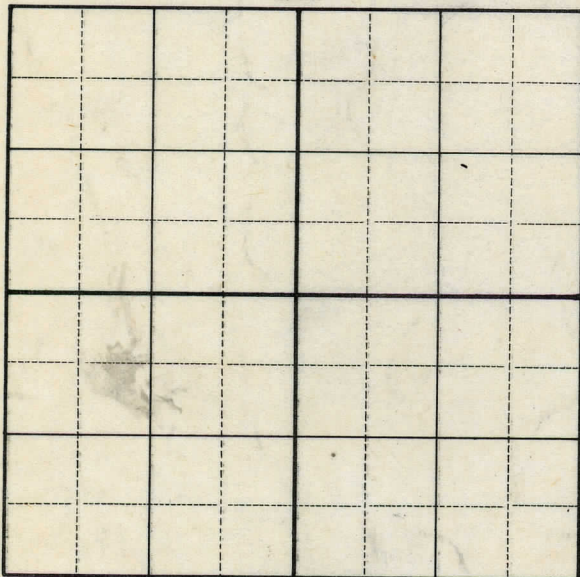
DATE 2-28-50 SCOUT H. J. G.

DATE November 13, 1940

THE PURE OIL COMPANY

LOCATION REPORT

No 627

627

STATE Michigan COUNTY Muskegon DIST. Blue Lake TWP. Blue Lake SEC. 5 TOWN 12N RANGE 16W
WELL No. 1 (SERIAL No. 627) FARM T. Cusser ACRES

NAME OF STREAM OR WATERS QUADRANGLE SW SW NW

OPERATOR Welsh Oil Co. Map Blue Lakes - Muskegon

Welsh Oil Co

Blue Lake - Muskegon

Feet from North Line of Farm

1980

" " East " " "

1980

" " South " " "

" " West " " "

Feet from North Line of Section

15250

" " East " " "

2440

" " South " " 1/4

" " West " " "

LEGEND

○ LOCATION

⊙ RIG

⊕ DRILLING

☼ GAS WELL

● OIL WELL

● SMALL OIL WELL

⊙ DRY HOLE

⊙ DRY SHOWING OIL

⊙ DRY SHOWING GAS

⊙ ABANDONED LOCATION

⊙ ABANDONED GAS WELL

⊙ ABANDONED OIL WELL

NOTE: Below make tracing from map. (when no map is obtainable make sketch) showing farm, center of section, this location with measurements and also wells, dry holes, or other locations in the vicinity of this location.

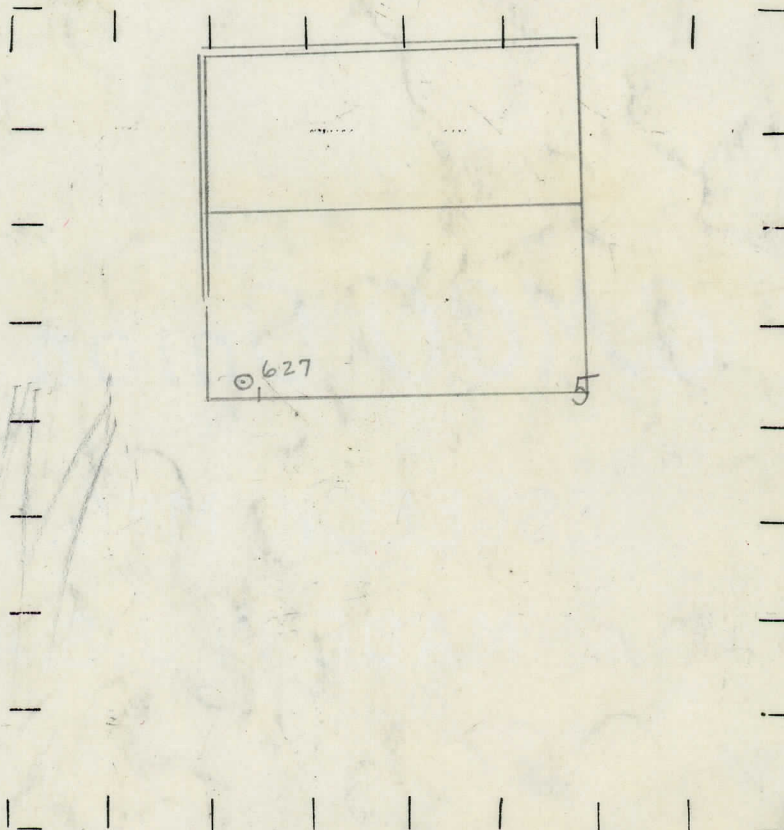

REMARKS:

SIGNED

W

Superintendent or Foreman.

EUBW

"СОУИТА"

2 KS'OU

ЬКЕС

ЛАЪ

2EC

ДОМИ ТРИ

KUNCE 700

D. C. Shackelford