



Western Michigan University
ScholarWorks at WMU

Legacy Scout Tickets from Pure Oil Company

8-20-2021

MGRRE_PureOilScoutTickets_Fisk, Floyd_2_21129016320000

MGRRE

Western Michigan University

Follow this and additional works at: <https://scholarworks.wmich.edu/pure>



Part of the Geology Commons

WMU ScholarWorks Citation

MGRRE, "MGRRE_PureOilScoutTickets_Fisk, Floyd_2_21129016320000" (2021). *Legacy Scout Tickets from Pure Oil Company*. 7761.

<https://scholarworks.wmich.edu/pure/7761>

This Document is brought to you for free and open access via ScholarWorks at WMU. It has been accepted for inclusion in Legacy Scout Tickets from Pure Oil Company by an authorized administrator of ScholarWorks at WMU. See the National Digital Catalogue - Science Base Catalogue for more collections submitted by MGRRE.



MGRRE_PureOilScoutTickets_Fisk, Floyd_2_21129016320000

API 21129016320000

Permit Number 1632

Lease Name Fisk, Floyd

Well Number 2

County Ogemaw

Township 22N

Range 02E

Section 20

2021 DEQ or Pure co_name Morris, Vanjeuren Oil and Gas Syndicate

Pure Number 66

Latitude 44.27807

Longitude -84.20923

THE PURE OIL COMPANY

DATE January 18, 1934LOCATION REPORT
CORRECTED OPERATOR REPORT

No. 66

STATE Michigan COUNTY Ogemaw DIST. West Branch SEC. 20 TOWN 22 N RANGE 2 EWELL No. 1 (SERIAL No. 66) FARM Floyd B. Fisk ACRESNAME OF STREAM OR WATERS QUADRANGLE SW-SE-SEOPERATOR Kirchoff & Schulty, Trs. MAP West Branch Township, Ogemaw County

Feet from North Line of Farm

" " East " " "

330 " " South " " "

480 " " West " " "

Feet from North Line of Section

840 " " East " " "

330 " " South " " "

" " West " " "

LEGEND

O LOCATION

① RIG

⊕ DRILLING

⊙ GAS WELL

● OIL WELL

⬤ SMALL OIL WELL

⬤ DRY HOLE

⬤ DRY SHOWING OIL

⬤ DRY SHOWING GAS

⬤ ABANDONED LOCATION

⬤ ABANDONED GAS WELL

⬤ ABANDONED OIL WELL

NOTE: Below make tracing from map, (when no map is obtainable make sketch) showing farm, center of section, this location with measurements and also wells, dry holes, or other locations in the vicinity of this location. Make copy to keep for reference and send original to Columbus office.

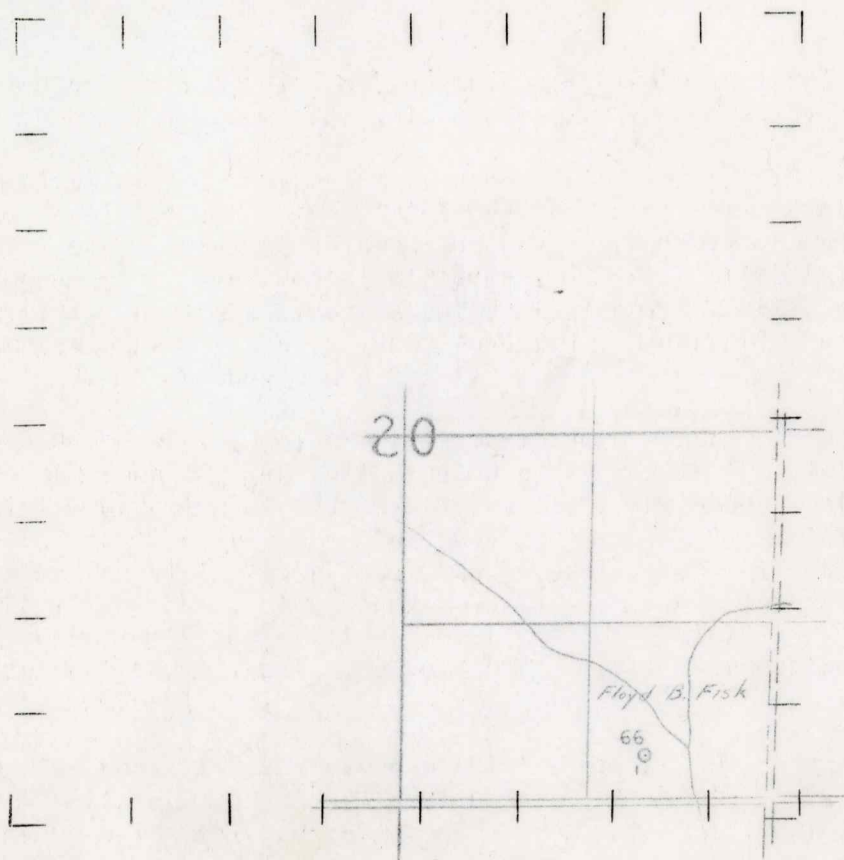

REMARKS:

Formerly reported as Edw. Christman, Operator

SIGNED

Superintendent or Foreman.

DATE January 11, 1934

LOCATION REPORT

No. 66

STATE Michigan COUNTY Ogemaw DIST. West Branch SEC. 20 TOWN 22 N RANGE 2 E

WELL No. 1 (SERIAL No. 66) FARM Floyd B. Fisk ACRES

NAME OF STREAM OR WATERS QUADRANGLE SW-SE-SE

OPERATOR Edward Christman MAP West Branch Township, Ogemaw County

Kirchhoff & Schultz Tr.

Feet from North Line of Farm

330 " " East " " "

480 " " South " " "

Feet from North Line of Section

840 " " East " " "

330 " " South " " "

West " " "

LEGEND

○ LOCATION

① RIG

⊕ DRILLING

⊛ GAS WELL

● OIL WELL

⬮ SMALL OIL WELL

⬮ DRY HOLE

⬮ DRY SHOWING OIL

⬮ DRY SHOWING GAS

⬮ ABANDONED LOCATION

⬮ ABANDONED GAS WELL

⬮ ABANDONED OIL WELL

NOTE: Below make tracing from map, (when no map is obtainable make sketch) showing farm, center of section, this location with measurements and also wells, dry holes, or other locations in the vicinity of this location. Make copy to keep for reference and send original to Columbus office.

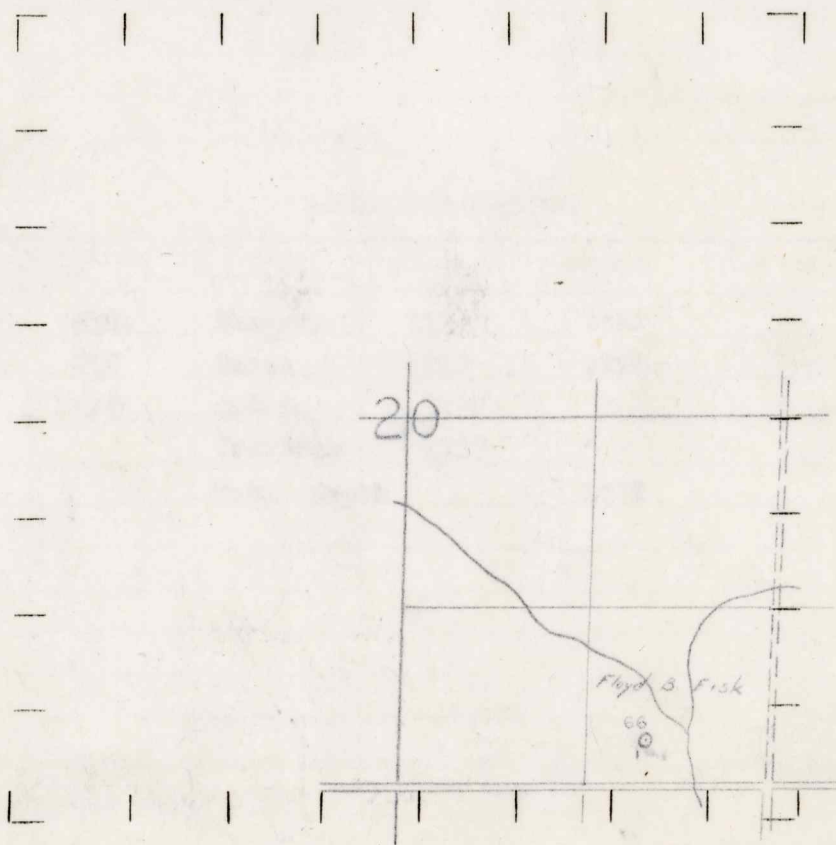

REMARKS:

Per. No. 1632

SIGNED

R. H. Yeager

Superintendent or Foreman.

Michigan Producing Division

Date May 9, 1935 No. 66
State Michigan County Ogemaw Dist. West Branch
Twp. Sec. 20 Twp. 22N Rge. 2E
(Serial No.)
Well No. 1 (County No.) 66 Farm Floyd Fisk Acres
by
Operator Morris-VanKeuren O. & G. Co. Information secured Scouting Dept.
Date well started 1/11/34 Date well completed 5/2/35 Elevation 927.2'

PRODUCTION RECORD

1st 24 hours natural Filled up 1300'

2nd 24 hours natural

Date of shot	No. of quarts	From	to	From	to
Date of acid	5/3/35	No. of gallons	1000		
1st 24 hours after acid	shot	160 bbls., net			
2nd 24 hours after acid	shot				

FORMATION AND CASING RECORD

[illegible]

Remarks This well originally completed as a dry hole in Traverse at 1772'.
Recently deepened to Dundee.

Signed

G. H. Beal