



Western Michigan University
ScholarWorks at WMU

Legacy Scout Tickets from Pure Oil Company

8-20-2021

MGRRE_PureOilScoutTickets_Gibbs_1_21129020350000

MGRRE

Western Michigan University

Follow this and additional works at: <https://scholarworks.wmich.edu/pure>



Part of the Geology Commons

WMU ScholarWorks Citation

MGRRE, "MGRRE_PureOilScoutTickets_Gibbs_1_21129020350000" (2021). *Legacy Scout Tickets from Pure Oil Company*. 7769.

<https://scholarworks.wmich.edu/pure/7769>

This Document is brought to you for free and open access via ScholarWorks at WMU. It has been accepted for inclusion in Legacy Scout Tickets from Pure Oil Company by an authorized administrator of ScholarWorks at WMU. See the National Digital Catalogue - Science Base Catalogue for more collections submitted by MGRRE.



MGRRE_PureOilScoutTickets_Gibbs_1_21129020350000

API 21129020350000

Permit Number 2035

Lease Name Gibbs

Well Number 1

County Ogemaw

Township 21N

Range 03E

Section 30

2021 DEQ or Pure co_name Mee, Will C.

Pure Number 74

Latitude 44.17723

Longitude -84.11868

THE PURE OIL COMPANY

DATE May 24, 1934

LOCATION REPORT

No. 74

STATE Michigan COUNTY Ogemaw DIST. Mills TWP. Mills SEC. 30 TOWN 21 N RANGE 3 E

WELL No. 1 (SERIAL No. 74) FARM W. F. Gibbs ACRES _____

NAME OF STREAM OR WATERS _____ QUADRANGLE SW-SE-SW

OPERATOR Will. C. Mee MAP Mills Township, Ogemaw County

Feet from North Line of Farm

990 " " East " " "

330 " " South " " "

" " West " " "

Feet from North Line of Section

990 " " East " " 1/4

330 " " South " " "

" " West " " "

LEGEND

- LOCATION
- ⊙ RIG
- ⊕ DRILLING
- ⊛ GAS WELL
- OIL WELL
- ⬮ SMALL OIL WELL
- ⊠ DRY HOLE
- ⬮ DRY SHOWING OIL
- ⊛ DRY SHOWING GAS
- ⊙ ABANDONED LOCATION
- ⊛ ABANDONED GAS WELL
- ⬮ ABANDONED OIL WELL

NOTE: Below make tracing from map, (when no map is obtainable make sketch) showing farm, center of section, this location with measurements and also wells, dry holes, or other locations in the vicinity of this location. Make copy to keep for reference and send original to Columbus office.

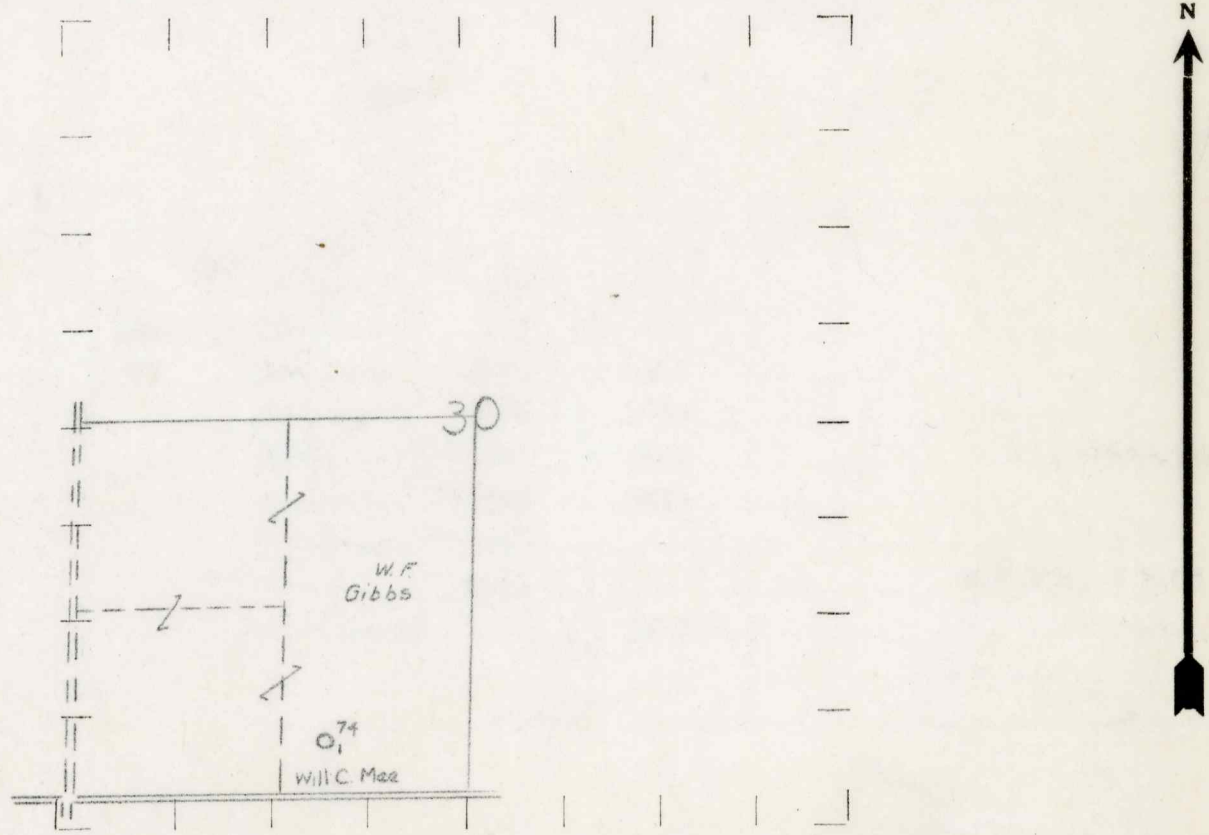

REMARKS: _____

SIGNED

R. L. Hansen

Superintendent or Foreman.

Per # 2035

Michigan Producing DIVISION COMPLETION RECORD

DATE 11/8/34

No. 74

STATE Michigan COUNTY Ogemaw DIST. TWP. Mills SEC. 30 TOWN 21N RANGE 3E

WELL No. 1 (SERIAL No. 74) FARM W. F. Gibbs ACRES

NAME OF STREAM OR WATERS QUADRANGLE SW-SE-SW

OPERATOR William C. Mee MAP Mills Township, Ogemaw County

LOCATION REPORT SENT IN (DATE) 5/24/34

WELL STARTED (DATE) 6/16/34 WELL COMPLETED (DATE) 11/1/34

OPEN WELL	WASH WELL	DRY HOLE	ABANDONED WELL
----------------------	----------------------	----------	---------------------------

CROSS OUT THREE OF THE ABOVE

Elevation 815.8'

WELL RECORD

DATE OF SHOT	NUMBER OF QUARTS
1st 24 HOURS PRODUCTION	<u>DRY HOLE</u>
2nd " " "	" " "
3rd " " "	" " "
4th " " "	" " "
5th " " "	" " "

SAND AND CASING

CASING SIZE	WEIGHT	CASING Feet Inches	SAND Name and Nature	TOP	BOTTOM	TOP PAY	BOTTOM PAY	SALT WATER
10"		230	Marshall	355	450			
8 1/4"		591	Red Rock	485	520			
6-5/8"		2305	Red Rock	1490	1500			
			Sunbury	1575	1620			
			Berea	1620	1623			1620-1623
			Antrim	1745	3050			
		97	Traverse	3050				
			Dundee	2932			H.F. Blk.	3100
			Total Depth		3112			

REMARKS

NOTE:—MAKE COPY TO KEEP FOR REFERENCE AND SEND ORIGINAL TO CHICAGO OFFICE. LIST MATERIAL CHARGEABLE TO WELL ON OTHER SIDE.

SIGNED J.H. Bell
SUPT. OR FOREMAN